

# 1A Series

Sealed Toggle Switches

## SPECIFICATIONS

**CONTACT RATING:** 0.4Volt-Amps(VA) max.@20V max(AC or DC)

**MECHANICAL LIFE:** 100,000 make-and-break cycles.

**ELECTRICAL LIFE:** 50,000 cycles.

**CONTACT RESISTANCE:** 10 mΩ max. initial @ 2-4VDC  
100mA for both silver and gold plated contacts.

**INSULATION RESISTANCE:** 1,000 MΩ min.

**DIELECTRIC STRENGTH:** 1,000 V RMS@sea level.

**OPERATING TEMPERATURE:** -30°C to 85°C.

## GENERAL SPECIFICATIONS

**TORQUE:** 0.8Nm max. applied to unt.

**PANEL THICKNESS:** 6mm max. ,2mm min.

## MATERIALS

**CASE & BUSHING:** Glass filled nylon 6/6, flame retardant, heat stabilized (UL94v-0).

**ACTUATOR:** Brass, chrome plated with internal, O-ring seal standard.

**SWITCH SUPPORT:** Brass or steel, tin plated.

**CONTACT / TERMINALS:** Copper alloy, gold plated.

**SEALIND:** IP67.

IP 67  
ACCORDING TO  
EN 60529:1991+A1:2001  
IEC 60529:2001



## SWITCH FUNCTION

NO. POLES	MODEL NO.	SWITCH FUNCTION			CONNECTED TERMINALS / SCHEMATIC		
		POS.1	POS.2	POS.3	POS.1	POS.2	POS.3
SP	1AS1	ON	NONE	ON	2-3 	N/A	2-1 
	1AS2	ON	NONE	MOM		OPEN	
	1AS3	ON	OFF	ON			
	1AS4	MOM	OFF	MOM	2-3	N/A	OPEN
	1AS5	ON	OFF	MOM			
	1AS9	ON	NONE	OFF			
	1ASD	MOM	NONE	OFF			OPEN

MOM=MENTORY

## M1

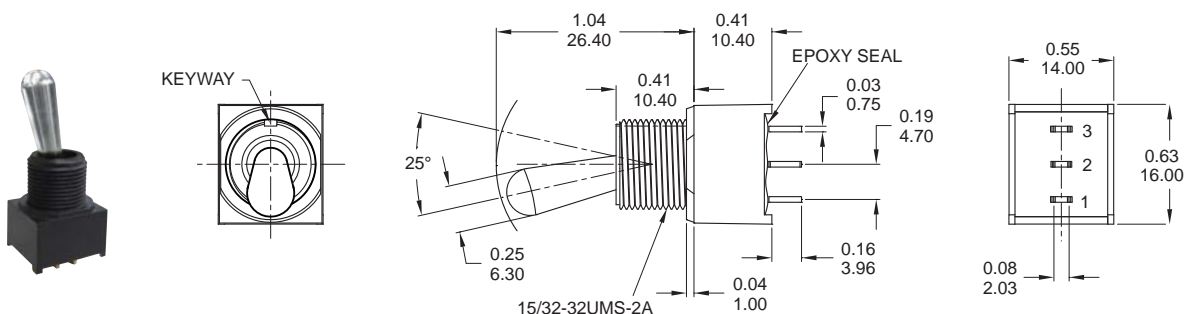

Part No. Shown : 1AS1T8B22M1RPES

## PANEL MOUNTING / HARDWARE

### PANEL MOUNTING

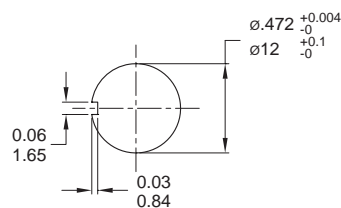

### NUT

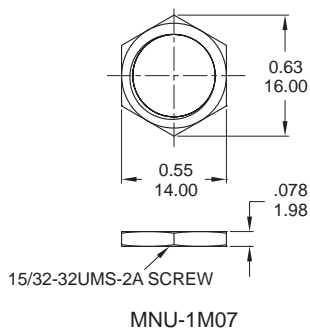

### SEALING BOOTS

