

SPECIFICATIONS

CONTACT RATING: Dependent upon contact material See Page 120.

MECHANICAL LIFE: 50,000 make-and-break cycles.

CONTACT RESISTANCE: 20 mΩ max. initial @ 2-4VDC
100mA for both silver and gold plated contacts.

INSULATION RESISTANCE: 1,000 MΩ min.

DIELECTRIC STRENGTH: 1,000 Vrms min. @sea level.

OPERATING TEMPERATURE: -40°C to 85°C.

MATERIALS

CASE: Diallyl phthalate(DAP) (UL94V-0).

PLUNGER: Nylon 6/6,black.

BUSHING: Brass or zinc,nickel plated.

HOUSING: Stainless Steel.

SWITCH SUPPORT: Brass.tin plated.

CONTACT/TERMINAL: Copper alloy or Brass, with silver or gold plated.(See Page 120)



HOW TO ORDER

MODEL NO. ACTUATOR BUSHING TERMINATIONS TERMINAL PLATING SEAL RoHS SOLDERING ADDITIONAL CAPS CAP COLOR

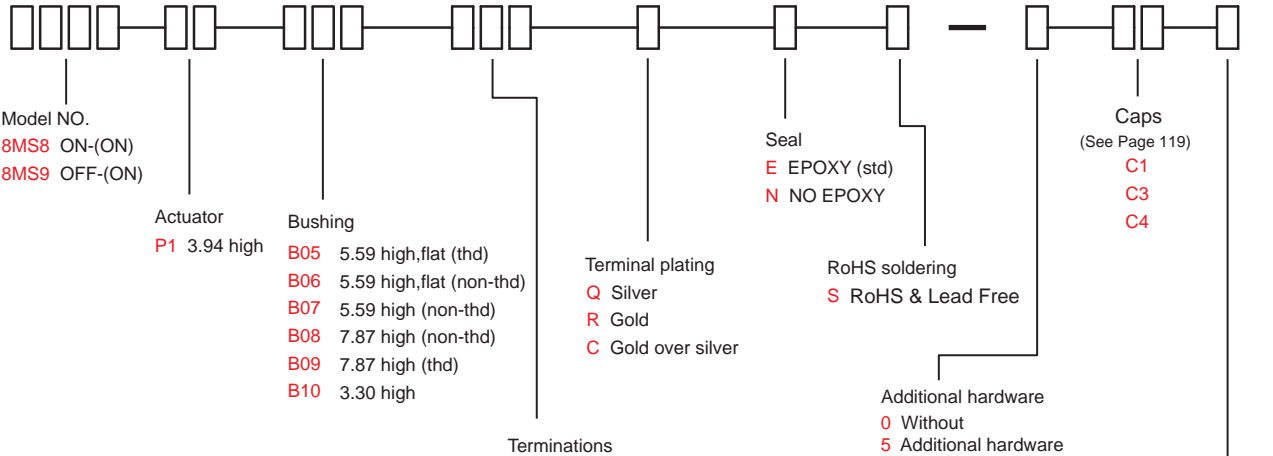

ITEM NO	COLOR
1	White
2	Black (Std)
3	Red
4	Orange
5	Yellow
6	Green
7	Blue
8	Brown
9	Gray

* Besides standard color, other colors need to check stocks available.

8M Series

Sub-Miniature Pushbutton Switches

SWITCH FUNCTION

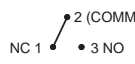
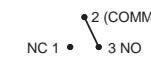
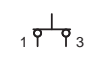
NO. POLES	UL/CSA MODEL NO.	MODEL NO.	SWITCH FUNCTION		CONNECTED TERMINALS / SCHEMATIC	
			POS.1	POS.2	POS.1	POS.2
SP	Q2818	8MS8	ON	(ON)	2-1 	2-3 
	Q2819	8MS9	OFF	(ON)	OPEN	1-3 

()=MOMENTARY

POLE OPTIONS

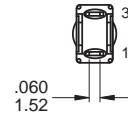
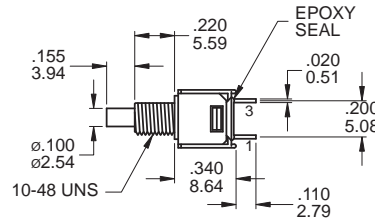
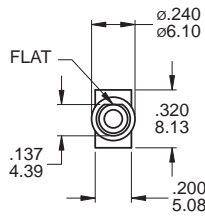

SPST

Part No. Shown : 8MS9P1B05M1QES

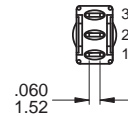
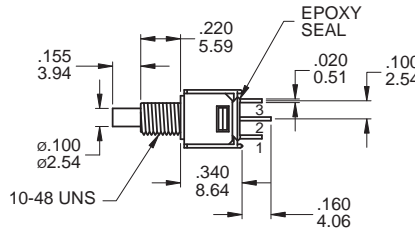
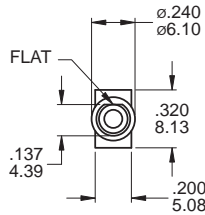

SPDT

Part No. Shown : 8MS8P1B05M1QES

BUSHING OPTIONS

B05 THD

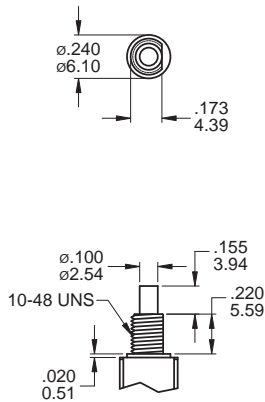

B06 NON-THD

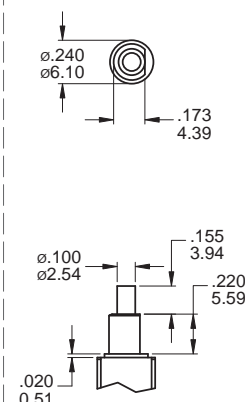

B07 NON-THD

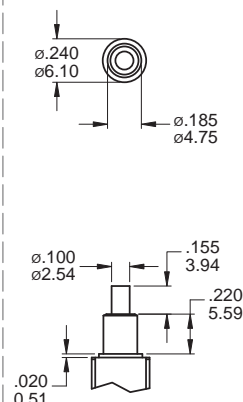

B08 NON-THD

B09 THD

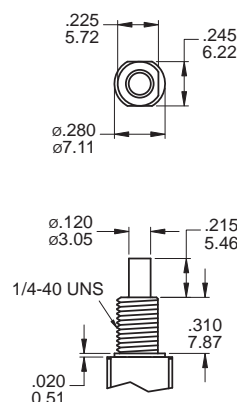

B10

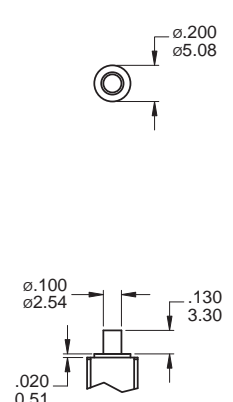

8M Pushbutton Switches

TERMINATION OPTIONS

M1 Solder lug

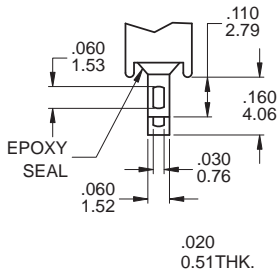

M2 PC Thru-hole

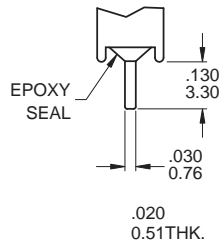

M5 Wire Wrap

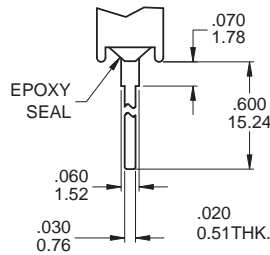

OTHER TERMINATION OPTIONS

- M6** Right angle P.C. Mount
- M6N** Right angle P.C. Mount with snap-in bracket
- M7** Right angle P.C. Mount
- M7N** Right angle P.C. Mount with snap-in bracket
- VS2** Right angle P.C. Mount
- V2N** Vertical bracket P.C. Mount with snap-in bracket

M6

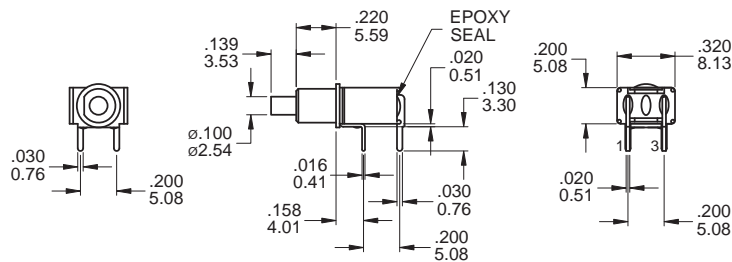

P.C. MOUNTING

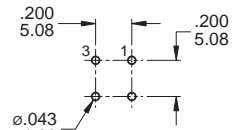

SPST

Part No. Shown : 8MS9P1B06M6RES

M6

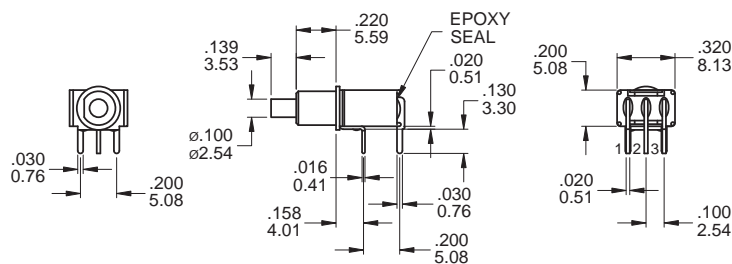

P.C. MOUNTING

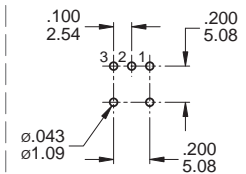

SPDT

Part No. Shown : 8MS8P1B06M6QES

M7

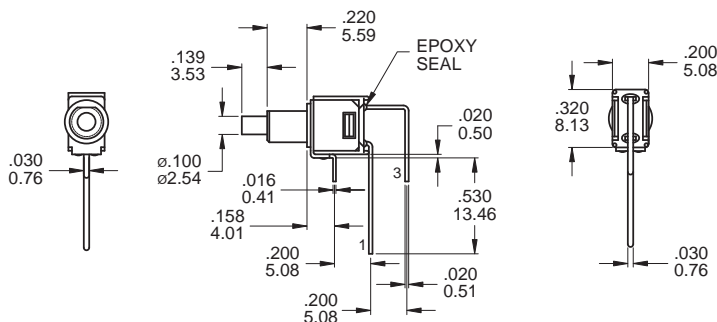

P.C. MOUNTING

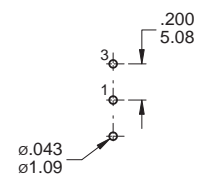

SPST

Part No. Shown : 8MS9P1B06M7QES



8M Series

Sub-Miniature Pushbutton Switches

M7

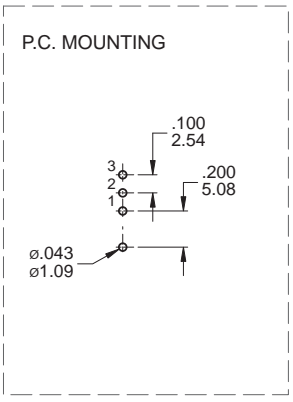
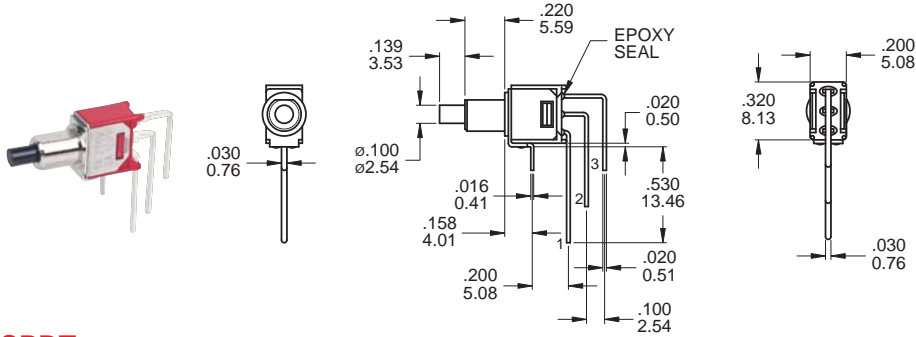

SPDT

Part No. Shown : 8MS8P1B06M7QES

VS2

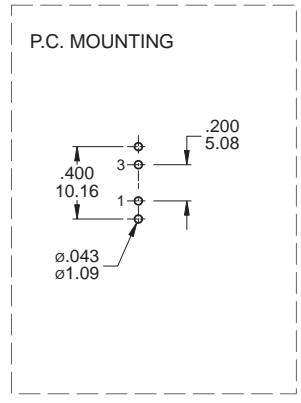
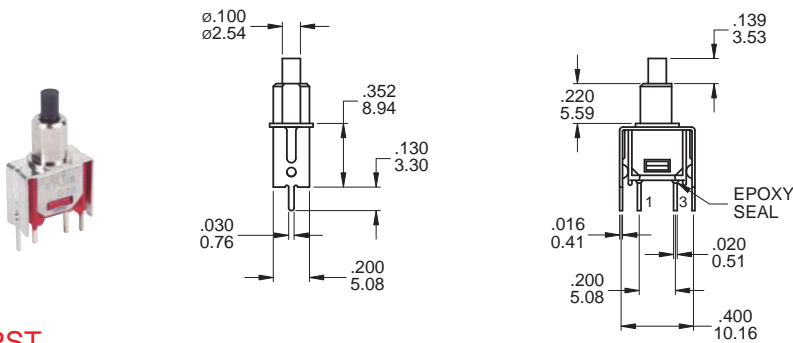

SPST

Part No. Shown : 8MS9P1B06VS2QES

VS2

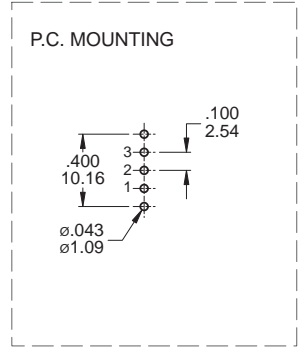
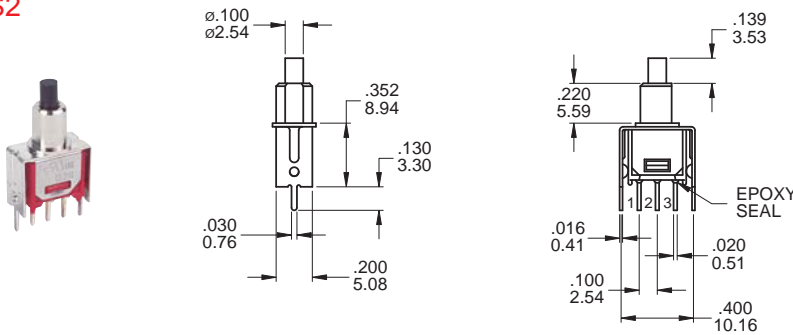

SPST

Part No. Shown : 8MS8P1B06VS2QES

SNAP-IN TERMINATION OPTIONS

M6N

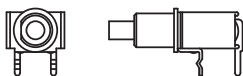

M7N

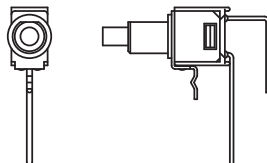

V2N

