



RoHS
Compliant
2002/95/EC

REV.	ECN. NO.	APPD.

DIMENSIONS

MODEL CODE

AT-1185-Z

	L(mm)	COLOR
Z	1.5	BK
A	2.0	BK
B	2.5	BK

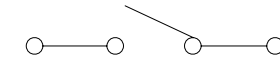
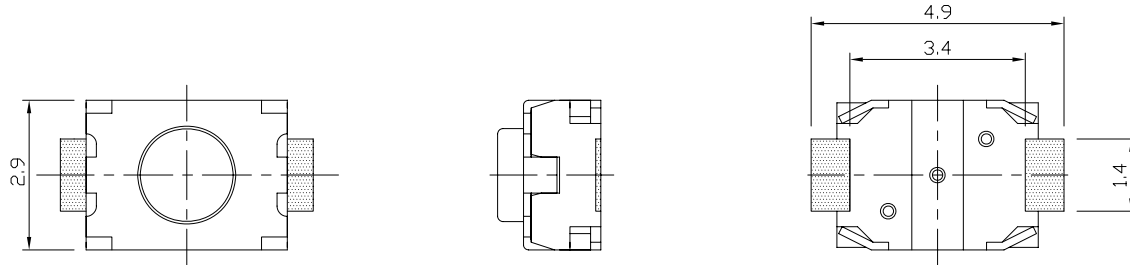

CIRCUIT DIAGRAM

P.C.B MOUNTING PATTERN DIMENSION
(ALL TOLERANCE:±0.05)

ELECTRO-MECHANICAL CHARACTERISTICS
Refer to additional specifications

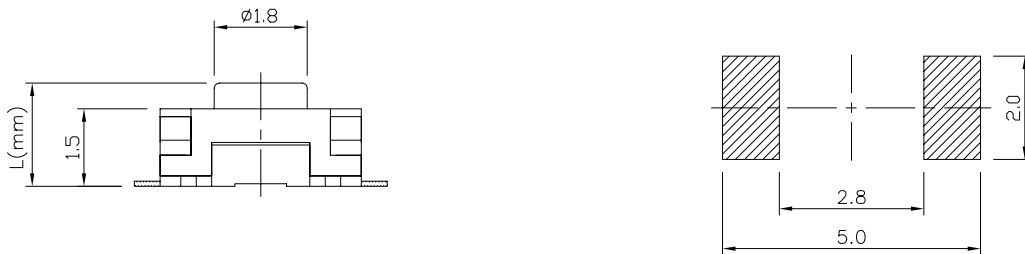

RATING	DC12V 50mA
CONTACT RESISTANCE	100mΩ MAX.
TRAVEL	0.2±0.1mm
OPERATING FORCE	160±30gf 220±50gf
OPERATING LIFE(cycles)	100,000

8					.X ±0.2	X. ±2°	UNITS mm	雅安科技有限公司 ACCURATE INNOTECH INC.				
7							MAT'L SEE NOTE					TITLE: TACT SWITCH
6							FINISH SEE NOTE	DR: <i>Ricky</i> 2015/05/07	DWG NO.: AKS-1185			
5							Q'TY	CHKD: <i>Ricky</i> 2015/05/07	SCALE	SHEET	REV.	CUSTOMER
4								APPD:	8:1	1/1	A	DRAWING
3												
2												
1												
NO.	PARTS	MATERIAL	Q'TY	FINISHING	THESE DRAWINGS AND SPECIFICATIONS ARE THE PROPERTY OF ACCURATE INNOTECH INC AND SHALL NOT BE REPRODUCED, COPIED OR USED IN ANY MANNER WITHOUT THE PRIOR WRITTEN CONSENT OF ACCURATE INNOTECH INC.							