



RoHS
Compliant
2002/95/EC

REV.	ECN.	NO.	APPD.

MODEL CODE

SK-63D01-GDD

Knob Type
GDD

L(mm)
~

DIMENSIONS

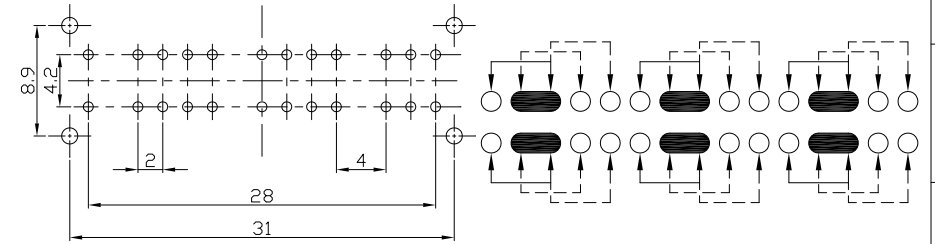
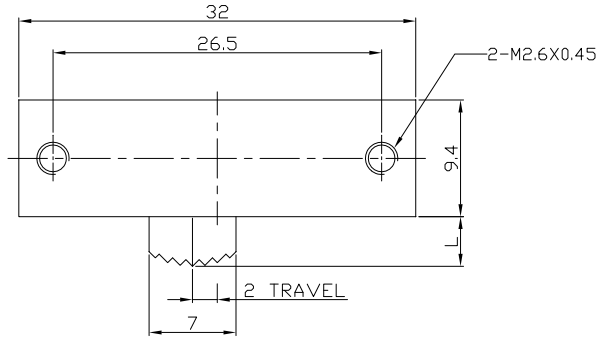

P.C.B LAYOUT
BOTTOM VIEW

CIRCUIT DIAGRAM

GDD Type

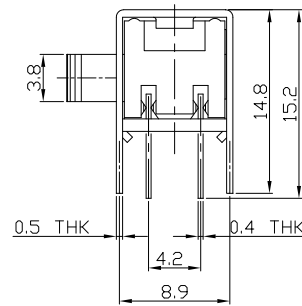
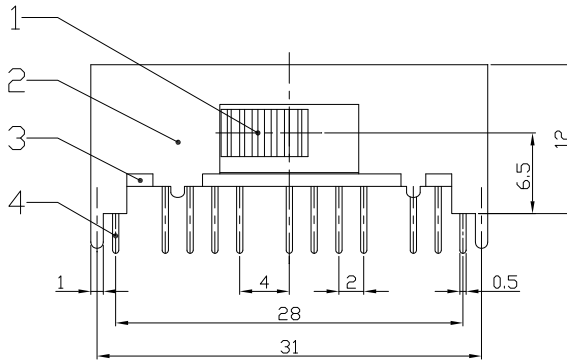

ELECTRO-MECHANICAL CHARACTERISTICS
Refer to additional specifications

RATING	0.3A 50V DC
CIRCUIT	6P3T
CONTACT RESISTANCE	100mΩ MAX.
TIMING	SHORTING
TRAVEL	2mm
OPERATING FORCE	300±100gf
OPERATING LIFE(cycles)	10,000

8					
7	STEEL BALL	STEEL	1	NATURAL	WITHIN 1.5mm: ±0.1mm
6	SPRING	STEEL WIRE	1	NATURAL	OVER 1.5mm: ±0.2mm
5	CONTACT CLIP	PBS STRIP	6	Ag PLATED	
4	TERMINAL	BRASS STRIP	24	Ag PLATED	
3	BASE	PHENOLIC RESIN	1	NATURAL	
2	FRAME	STEEL STRIP	1	Ni PLATED	
1	KNOB	POM	1	BLACK	
NO.	PARTS	MATERIAL	Q'TY	FINISHING	

THESE DRAWINGS AND SPECIFICATIONS ARE THE PROPERTY OF ACCURATE INNOTECH INC AND SHALL NOT BE REPRODUCED, COPIED OR USED IN ANY MANNER WITHOUT THE PRIOR WRITTEN CONSENT OF ACCURATE INNOTECH INC.

UNITS	mm
MAT'L	SEE NOTE
FINISH	SEE NOTE
Q'TY	

雅安科技有限公司 ACCURATE INNOTECH INC.			
TITLE:	SLIDE SWITCH / HORIZONTAL	PART NO.:	SK-63D01
DR:	Ricky 2016/07/18	DWG NO.:	ADL-63D01
CHKD:	Ricky 2016/07/18	SCALE	3:2
APPD:		SHEET	1/1
		REV.	A
		CUSTOMER DRAWING	