

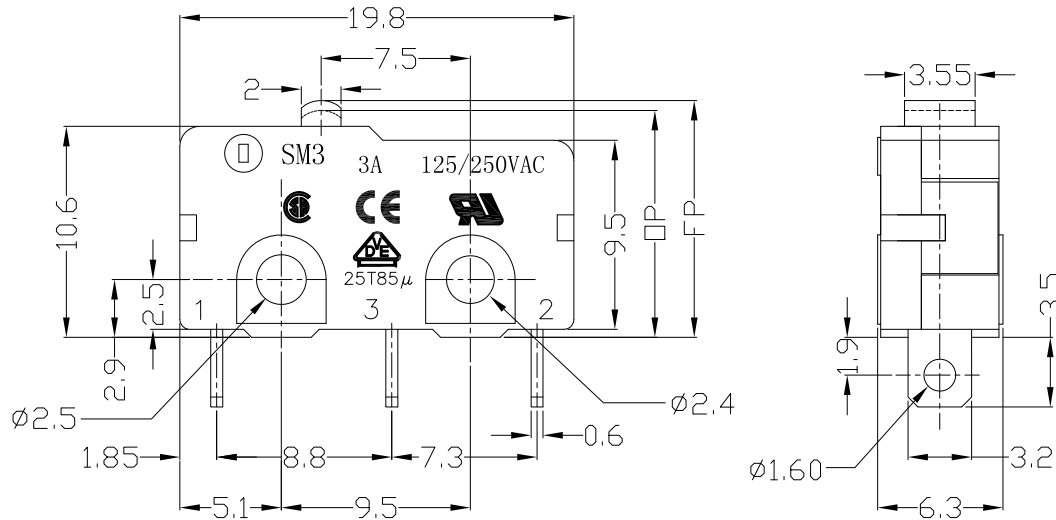

RoHS
Compliant
2002/95/EC

REV.	ECN.	NO.	APPD.

DIMENSIONS



MODEL CODE

SM 3-00 X-XX S-C31

1 2 3 4 5 6 7

- 1.Series : SM
- 2.Current Rating : 3=3A 125/250VAC
- 3.Actuator : 00=Non-lever 01-99=Lever
- 4.Termination : see chart (N/P/C/D)
(2=SPST-NO / 3=SPST-NC)
- 5.Operating Force : see chart
- 6.Spring Material:S=SUS304
- 7.Contact type: C31=3Amps Contact

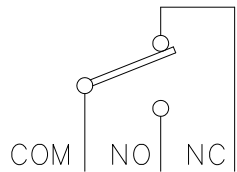

CIRCUIT DIAGRAM

1.Functional spec

1.1 Rated Voltage(AC)	125/250VAC
1.2 Rated Current(AC)	3A
1.3 Contact Resistance	≤100mΩ(Initial value)
1.4 Operating Force	115±30gf 175±45gf 250±50gf
1.5 Bounce Time	
1.6 Free Position	11.9±0.3mm
1.7 Operating Position	11.3±0.35mm
1.8 Position Travel	
1.9 Return Force	

2.Reliable Rating

2.1 Mechanical Life	1,000,000 CYCLES
2.2 Electrical Life	10,000 CYCLES
2.3 Insulation Resistance	≥100MΩ DC500V
2.4 Withstand Voltage	AC1000V 1 minute
2.5 Soldering Technic	Hand Soldering
2.6 Operating Temper	-25°C ~ +85°C
2.7 Ambient Humidity Used	<85%RH

Tolerance:±0.2	UNITS	雅安科技有限公司			
	mm	ACCURATE INNOTECH INC.			
	MAT'L	TITLE:	PART NO.:		
	SEE NOTE	MICRO SWITCH SM3 SERIES	SM3-00N-XXS-C31		
	FINISH	DR: <i>Ricky</i> 2017/4/10	DWG NO.:		
	SEE NOTE	CHKD: <i>Ricky</i> 2017/4/10	ATD-00X-XXS-C31		
THESE DRAWINGS AND SPECIFICATIONS ARE THE PROPERTY OF ACCURATE INNOTECH INC AND SHALL NOT BE REPRODUCED, COPIED OR USED IN ANY MANNER WITHOUT THE PRIOR WRITTEN CONSENT OF ACCURATE INNOTECH INC.	Q'TY	APPD:	SCALE	SHEET	REV.
			1:1	1/2	A
			CUSTOMER DRAWING		



RoHS
Compliant
2002/95/EC

REV.	ECN. NO.	NO.	APPD.

Terminal Type

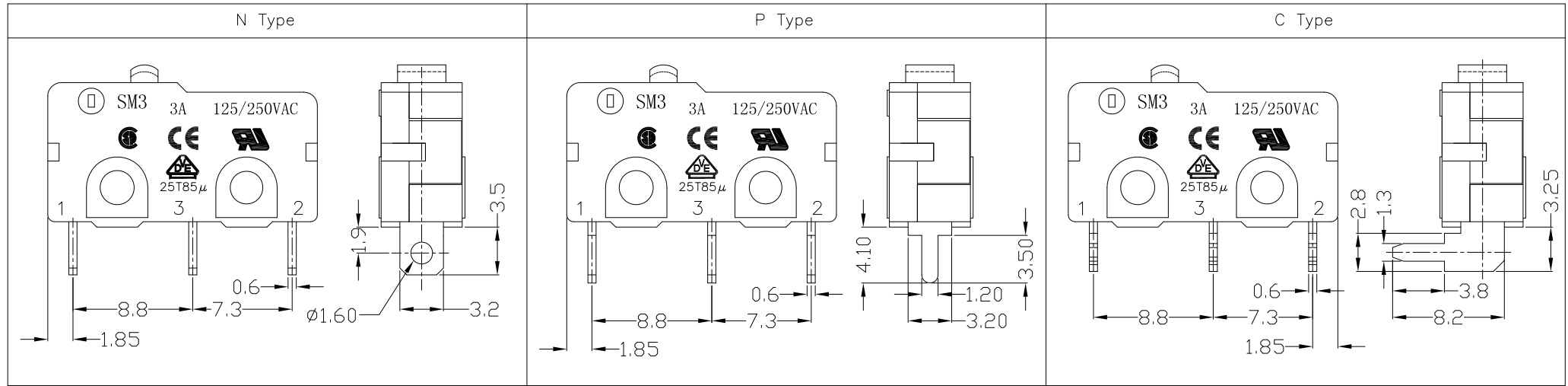

Structure chart

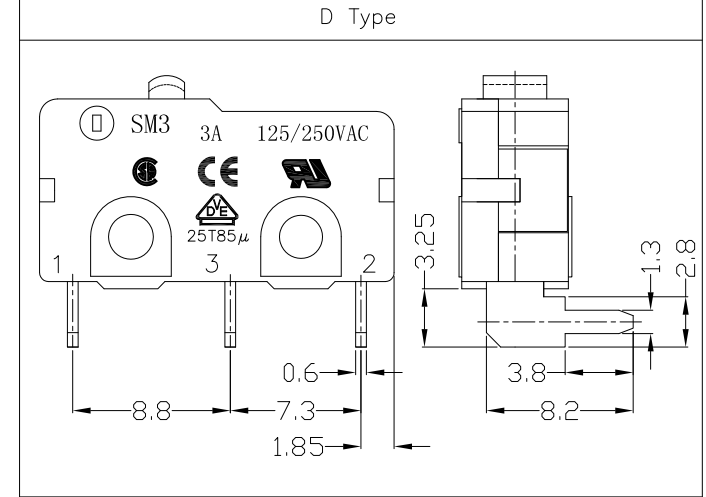
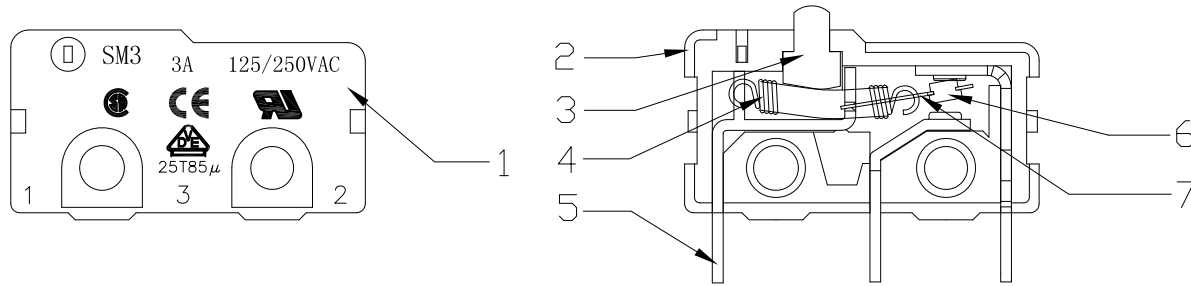

Material list

NO.	PARTS	MATERIAL	Q'TY	FINISHING	Tolerance:±0.2	UNITS	雅安科技有限公司 ACCURATE INNOTECH INC.			
8						mm	TITLE:		PART NO.:	
7	Change Plate	C5210	1			MAT'L	MICRO SWITCH SM3 SERIES		SM3-00X-XXS-C31	
6	Contact	Silver alloy	1			SEE NOTE	DR: Ricky 2017/4/10		DWG NO.:	
5	Terminal	C2680	3			FINISH	CHKD: Ricky 2017/4/10		ATD-00X-XXS-C31	
4	Spring	SUS304	1			SEE NOTE	APPD:		SCALE SHEET REV. CUSTOMER	
3	Button	PBT	1			Q'TY			1:1 2/2 A DRAWING	
2	Lower Housing	PBT	1							
1	Upper Housing	PBT	1							

THESE DRAWINGS AND SPECIFICATIONS ARE THE PROPERTY OF ACCURATE INNOTECH INC AND SHALL NOT BE REPRODUCED, COPIED OR USED IN ANY MANNER WITHOUT THE PRIOR WRITTEN CONSENT OF ACCURATE INNOTECH INC.



RoHS
Compliant
2002/95/EC

REV.	ECN.	NO.	APPD.

DIMENSIONS

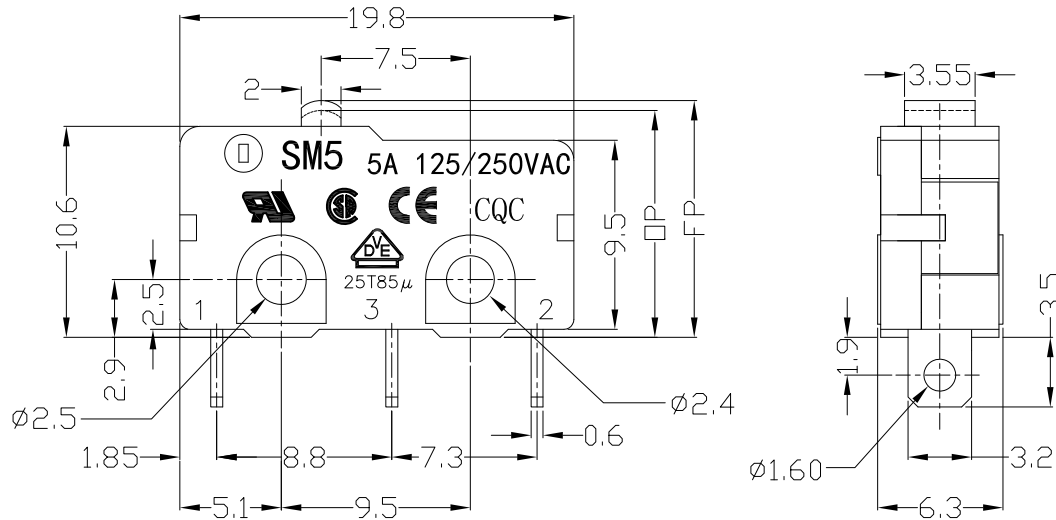

MODEL CODE

SM 5 - 00 X - XX S - C51

1 2 3 4 5 6 7

- 1.Series : SM
- 2.Current Rating : 5=5A 125/250VAC
- 3.Actuator : 00=Non-lever 01-99=Lever
- 4.Termination : see chart (N/P/C/D/L)
(2=SPST-NO / 3=SPST-NC)
- 5.Operating Force : see chart
- 6.Spring Material:S=SUS304
- 7.Contact type: C51=5Amps Contact

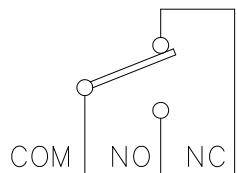

CIRCUIT DIAGRAM

1.Functional spec

1.1 Rated Voltage(AC)	125/250VAC
1.2 Rated Current(AC)	5A
1.3 Contact Resistance	≤100mΩ(Initial value)
1.4 Operating Force	115±30gf 175±45gf 250±50gf
1.5 Bounce Time	
1.6 Free Position	11.9±0.3mm
1.7 Operating Position	11.3±0.35mm
1.8 Position Travel	
1.9 Return Force	

2.Reliable Rating

2.1 Mechanical Life	1,000,000 CYCLES
2.2 Electrical Life	10,000 CYCLES
2.3 Insulation Resistance	≥100MΩ DC500V
2.4 Withstand Voltage	AC1000V 1 minute
2.5 Soldering Technic	Hand Soldering
2.6 Operating Temper	-25°C ~ +85°C
2.7 Ambient Humidity Used	<85%RH

Tolerance:±0.2		UNITS	雅安科技有限公司 ACCURATE INNOTECH INC.			
		mm	TITLE:		PART NO.:	
		MAT'L	MICRO SWITCH SM5 SERIES		SM5-00N-XXS-C51	
		SEE NOTE	DR: <i>Ricky</i> 2017/4/12		DWG NO.:	
		FINISH	CHKD: <i>Ricky</i> 2017/4/12		ATD-00X-XXS-C51	
		SEE NOTE	APPD:		SCALE	SHEET
		Q'TY			1:1	1/2
THESE DRAWINGS AND SPECIFICATIONS ARE THE PROPERTY OF ACCURATE INNOTECH INC AND SHALL NOT BE REPRODUCED, COPIED OR USED IN ANY MANNER WITHOUT THE PRIOR WRITTEN CONSENT OF ACCURATE INNOTECH INC.					REV.	CUSTOMER DRAWING
					A	



RoHS
Compliant
2002/95/EC

REV.	ECN. NO.	NO.	APPD.

Terminal Type

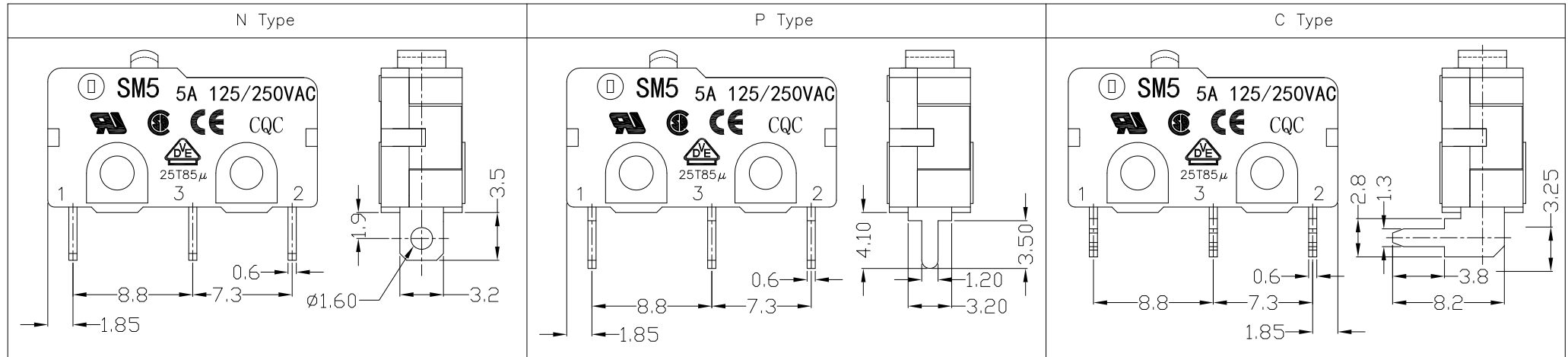

Structure chart

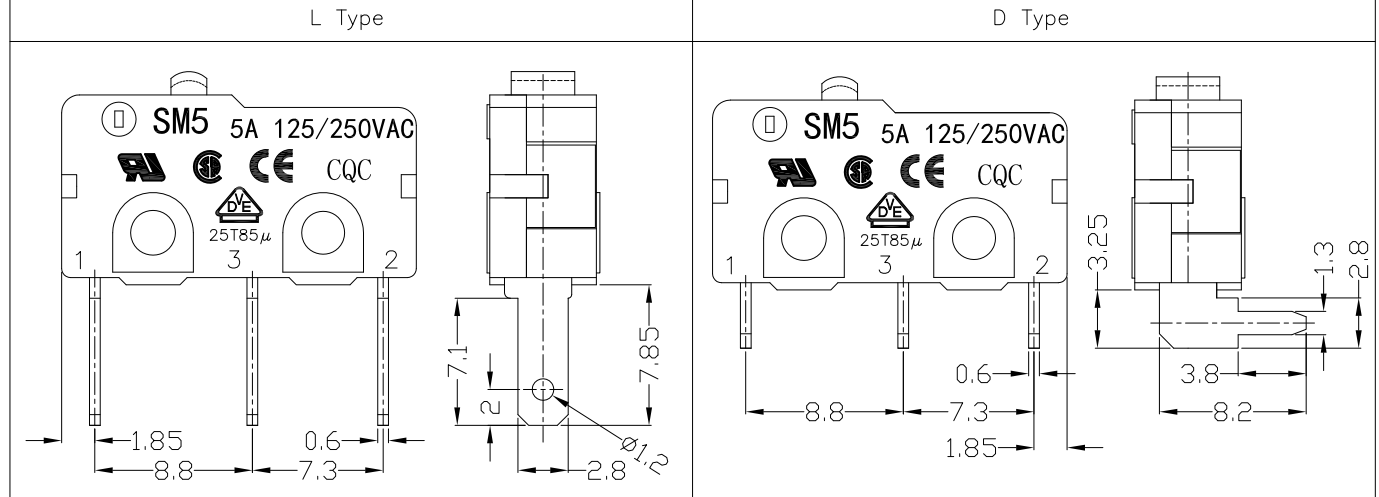
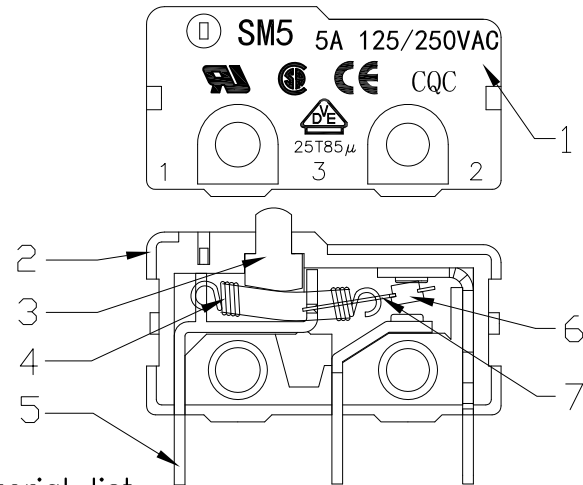

Material list

NO.	PARTS	MATERIAL	Q'TY	FINISHING	Tolerance:±0.2	UNITS mm	雅安科技有限公司 ACCURATE INNOTECH INC.					
8							TITLE:		PART NO.:			
7	Change Plate	C5210	1				MICRO SWITCH SM5 SERIES		SM5-00X-XXS-C51			
6	Contact	Silver alloy	3				DR: <i>Ricky</i> 2017/4/12		DWG NO.:			
5	Terminal	C2680	3				CHKD: <i>Ricky</i> 2017/4/12		ATD-00X-XXS-C51			
4	Spring	SUS304	1				APPD:		SCALE	SHEET	REV.	CUSTOMER
3	Button	PBT	1						1:1	2/2	A	DRAWING
2	Lower Housing	PBT	1									
1	Upper Housing	PBT	1									

THESE DRAWINGS AND SPECIFICATIONS ARE THE PROPERTY OF ACCURATE INNOTECH INC AND SHALL NOT BE REPRODUCED, COPIED OR USED IN ANY MANNER WITHOUT THE PRIOR WRITTEN CONSENT OF ACCURATE INNOTECH INC.