

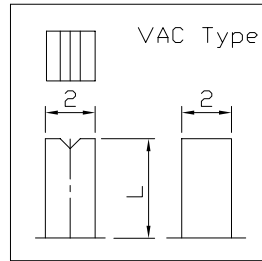

RoHS
Compliant
2002/95/EC

| REV. | ECN. | NO. | APPD. |
|------|------|-----|-------|
| | | | |
| | | | |
| | | | |

DIMENSIONS

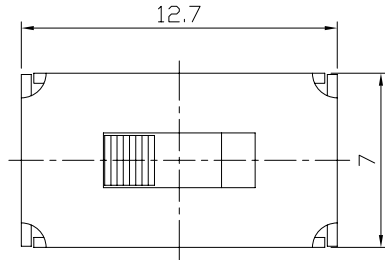

MODEL CODE

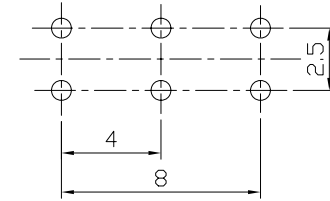
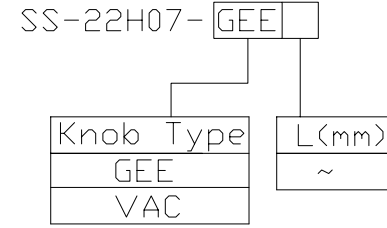

P.C.B LAYOUT
BOTTOM VIEW

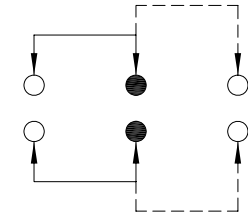

CIRCUIT DIAGRAM

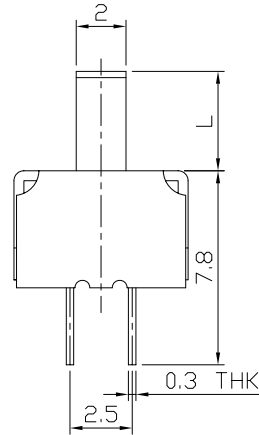
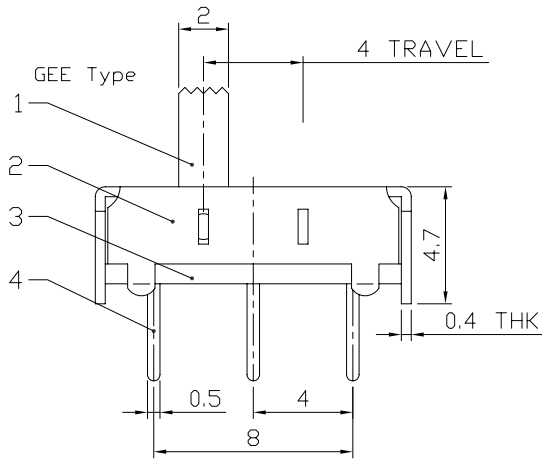

ELECTRO-MECHANICAL CHARACTERISTICS

Refer to additional specifications

| | |
|------------------------|--------------|
| RATING | 0.3A 50V DC |
| CIRCUIT | 2P2T |
| CONTACT RESISTANCE | 100mΩ MAX. |
| TIMING | NON-SHORTING |
| TRAVEL | 4mm |
| OPERATING FORCE | 250±100gf |
| OPERATING LIFE(cycles) | 10,000 |

| | | | | | | | |
|-----|---------------|----------------|------|-----------|----------------------|----------|----|
| 8 | | | | | WITHIN 1.5mm: ±0.1mm | UNITS | mm |
| 7 | | | | | OVER 1.5mm: ±0.2mm | MAT'L | |
| 6 | SPRING PLATED | PBS STRIP | 1 | NATURAL | | SEE NOTE | |
| 5 | CONTACT CLIP | PBS STRIP | 2 | Ag PLATED | | | |
| 4 | TERMINAL | BRASS STRIP | 6 | Ag PLATED | | | |
| 3 | BASE | PHENOLIC RESIN | 1 | NATURAL | | FINISH | |
| 2 | FRAME | STEEL STRIP | 1 | Ni PLATED | | SEE NOTE | |
| 1 | KNOB | POM | 1 | BLACK | | Q'TY | |
| NO. | PARTS | MATERIAL | Q'TY | FINISHING | | | |

THESE DRAWINGS AND SPECIFICATIONS ARE THE PROPERTY OF ACCURATE INNOTECH INC AND SHALL NOT BE REPRODUCED, COPIED OR USED IN ANY MANNER WITHOUT THE PRIOR WRITTEN CONSENT OF ACCURATE INNOTECH INC.

| | | | |
|------------------------------------|--|-----------------------|------------------|
| 雅安科技有限公司 ACCURATE INNOTECH INC. | | | |
| TITLE: SLIDE SWITCH / VERTICAL | | PART NO.: SS-22H07 | |
| DR: <i>Ricky</i> 2015/05/28 | | DWG NO.: ADL-22H07 | |
| CHKD: <i>Ricky</i> 2015/05/28 | | SCALE | SHEET |
| APPD: | | 7/2 | 1/1 |
| | | REV. | CUSTOMER DRAWING |
| | | A | |