

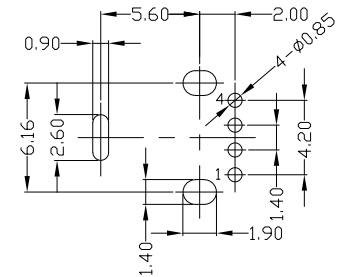

RoHS
Compliant
2002/95/EC

REV.	ECN.	NO.	APPD.

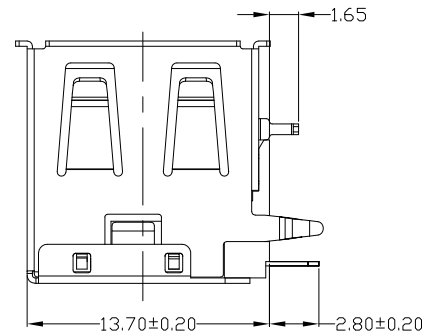
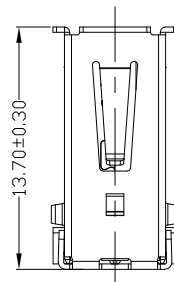
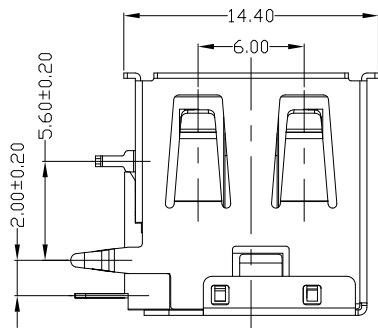
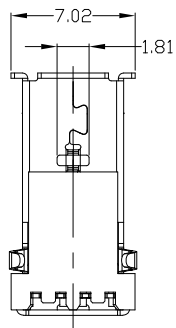
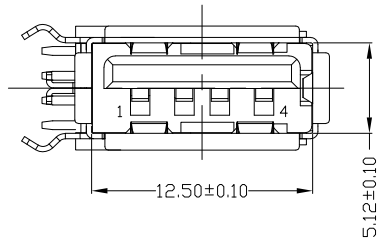

RECOMMENDED PCB LAYOUT

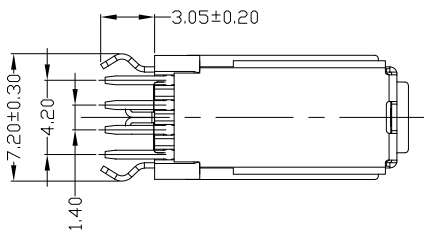

NOTES:

- ELECTRICAL:
 - VOLTAGE CURRENT RATING: 2AMP, 30V AC;
 - INSULATION RESISTANCE: 1000MΩMIN;
 - CONTACT RESISTANCE: 30mΩMAX;
 - WITHSTANDING VOLTAGE: 500V AC;
 - OPERATING TEMPERATURE: -55°C TO +85°C.
- Mechanical:
 - Mating Force: 35N MAX
 - Unmating Force: 10N MIN.
- DIMENSIONS MARKED "▼" TO BE CHECKED BY Q.C & IPQC.

4. PART NO.

USAF-04*N-1*C68

1: Au 1U*
6: Au 30U*
W: WHITE
B: BLACK
1: PBT
2: PA6T
3: PA9T
4: LCP

Bill of materials:

NO	PARTS	MATERIAL	QTY	FINISHING	UNITS	mm	雅安科技有限公司 ACCURATE INNOTECH INC.						
4	BACK COVER	COPPER ALLOY	1	PLATED NICKEL	.X ±0.30	.X' ±3'	MAT'L	TITLE:		PART NO.:			
3	HOUSING	PBT+30%GF	1	UL94V-0	.XX ±0.20			SEE NOTE	USB AF 90° DIP侧插三只脚 卷边		USAF-04*N-1*C68		
2	SHELL	COPPER ALLOY	1	PLATED NICKEL	.XXX ±0.10		FINISH	DR: Ricky 2022/12/06		DWG NO.:			
1	TERMINAL	COPPER ALLOY	4	PLATED GOLD/TIN			SEE NOTE	CHKD: Ricky 2022/12/06		AII-C68			
							Q'TY	APPD:		SCALE	SHEET	REV.	CUSTOMER DRAWING
										1:1	1/1	B	

THESE DRAWINGS AND SPECIFICATIONS ARE THE PROPERTY OF ACCURATE INNOTECH INC AND SHALL NOT BE REPRODUCED, COPIED OR USED IN ANY MANNER WITHOUT THE PRIOR WRITTEN CONSENT OF ACCURATE INNOTECH INC.

