

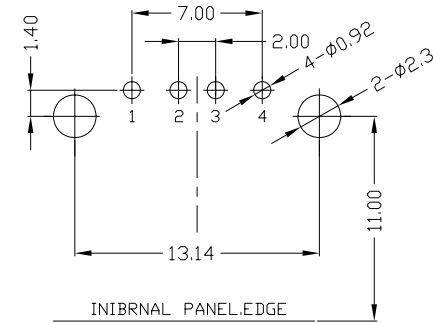

RoHS  
Compliant  
2002/95/EC

REV.	ECN.	NO.	APPD.

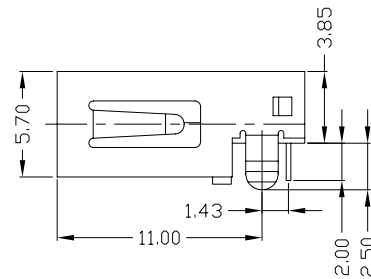
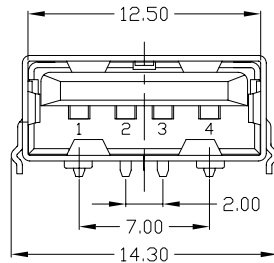
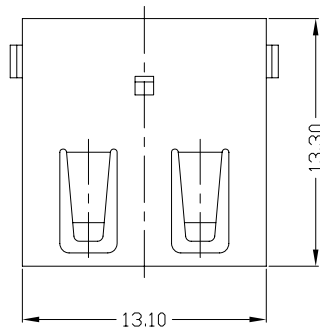

RECOMMENDED PCB LAYOUT

NOTES:

- ELECTRICAL:
  - VOLTAGE CURRENT RATING: 2AMP, 30V AC;
  - INSULATION RESISTANCE: 1000MΩMIN;
  - CONTACT RESISTANCE: 30mΩMAX;
  - WITHSTANDING VOLTAGE: 500V AC;
  - OPERATING TEMPERATURE: -55°C TO +85°C.
- Mechanical:
  - Mating Force: 35N MAX
  - Unmating Force: 10N MIN.
- DIMENSIONS MARKED "▼" TO BE CHECKED BY Q.C & IPQC.

4. PART NO.

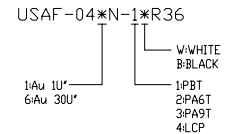

Bill of materials:

NO	PARTS	MATERIAL	QTY	FINISHING	UNITS	雅安科技有限公司 ACCURATE INNOTECH INC.					
3	HOUSING	PBT+30%GF	1	UL94V-0	X. ±0.35	X.* ±2*	mm	TITLE: USB AF 90° 单层沉板式 (079) 无边		PART NO.: USAF-04*N-1*R36	
2	SHELL	COPPER ALLOY/SPCC	1	PLATED NICKEL	.X ±0.3	.X* ±1*	MAT'L	DR: gan 2014/09/20		DWG NO.: AII-R36	
1	TERMINAL	COPPER ALLOY	4	PLATED GOLD/TIN	.XX ±0.25	.XX*	SEE NOTE	CHKD: gan 2014/09/20		SCALE: 1:1	
					.XXX ±0.15	.XXX*	FINISH	APPD:		SHEET: 1/1	
							Q'TY	CUSTOMER DRAWING		REV. B	

THESE DRAWINGS AND SPECIFICATIONS ARE THE PROPERTY OF ACCURATE INNOTECH INC AND SHALL NOT BE REPRODUCED, COPIED OR USED IN ANY MANNER WITHOUT THE PRIOR WRITTEN CONSENT OF ACCURATE INNOTECH INC.

