

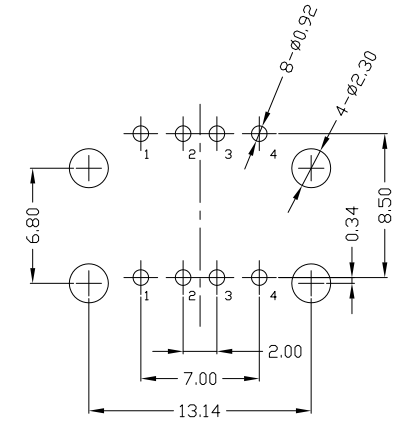

RoHS  
Compliant  
2002/95/EC

REV.	ECN.	NO.	APPD.

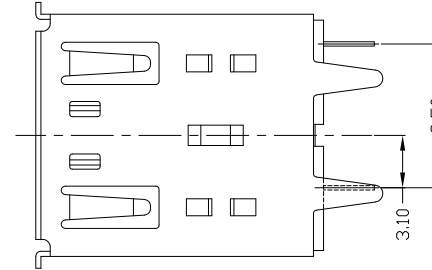
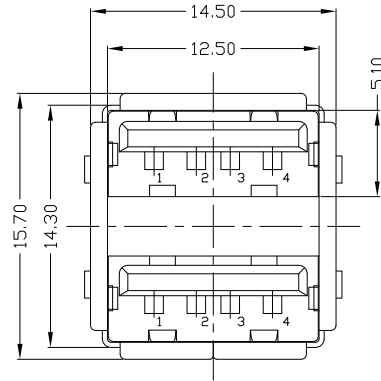
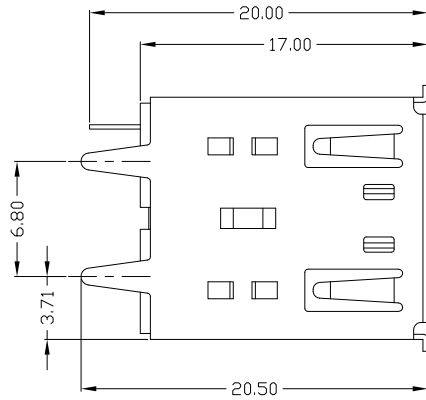

RECOMMENDED PCB LAYOUT

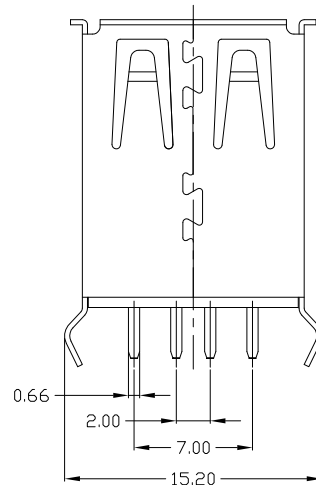

NOTES:

- ELECTRICAL:
  - VOLTAGE CURRENT RATING: 2AMP, 30V AC;
  - INSULATION RESISTANCE: 1000MΩMIN;
  - CONTACT RESISTANCE: 30mΩMAX;
  - WITHSTANDING VOLTAGE: 500V AC;
  - OPERATING TEMPERATURE: -55°C TO +85°C.
- Mechanical:
  - Mating Force: 35N MAX
  - Unmating Force: 10N MIN.
- DIMENSIONS MARKED '▼' TO BE CHECKED BY Q.C & IPQC.

4. PART NO.

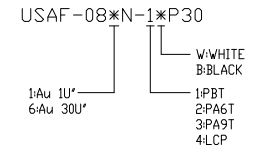

Bill of materials:

NO	PARTS	MATERIAL	QTY	FINISHING	UNITS	MAT'L	FINISH	Q'TY	TITLE:	PART NO.:	DR:	CHKD:	APPD:	SCALE	SHEET	REV.	CUSTOMER DRAWING	
4	CLIP	COPPER ALLOY	1	PLATED NICKEL	X. ±0.35	X.' ±2'	SEE NOTE	SEE NOTE	雅安科技有限公司	USAF-08*N-1*P30	gan 2014/09/26	gan 2014/09/26		1:1	1/1	B		
3	HOUSING	PBT+30%GF	1	UL94V-0	.X ±0.3	.X' ±1'	SEE NOTE	SEE NOTE	ACCURATE INNOTECH INC.	USAF-08*N-1*P30								
2	SHELL	COPPER ALLOY/SPCC	1	PLATED NICKEL	.XX ±0.25	.XX'	SEE NOTE	SEE NOTE	USB AF 180度双层插板长体(015)	USAF-08*N-1*P30								
1	TERMINAL	COPPER ALLOY	8	PLATED GOLD/TIN	.XXX ±0.15	.XXX'	SEE NOTE	SEE NOTE	DR: gan 2014/09/26	AII-P30								
THESE DRAWINGS AND SPECIFICATIONS ARE THE PROPERTY OF ACCURATE INNOTECH INC AND SHALL NOT BE REPRODUCED, COPIED OR USED IN ANY MANNER WITHOUT THE PRIOR WRITTEN CONSENT OF ACCURATE INNOTECH INC.					mm		SEE NOTE		PART NO.:		DR: gan 2014/09/26		CHKD: gan 2014/09/26		APPD:		SCALE: 1:1	