

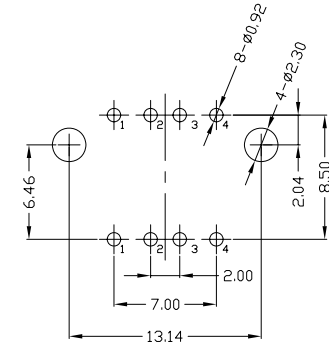

RoHS  
Compliant  
2002/95/EC

REV.	ECN.	NO.	APPD.

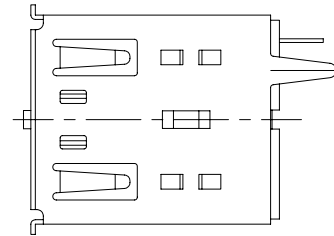
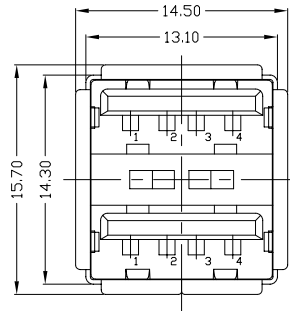
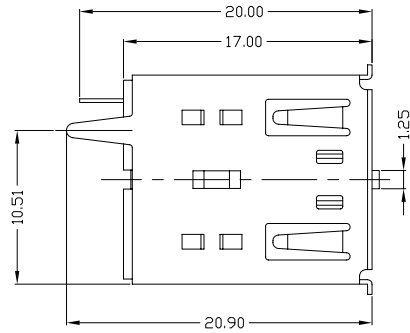

RECOMMENDED PCB LAYOUT

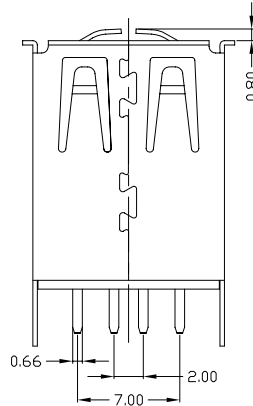

NOTES:

- ELECTRICAL:
  - VOLTAGE CURRENT RATING: 2AMP, 30V AC;
  - INSULATION RESISTANCE: 1000MΩMIN;
  - CONTACT RESISTANCE: 30mΩMAX;
  - WITHSTANDING VOLTAGE: 500V AC;
  - OPERATING TEMPERATURE: -55°C TO +85°C.
- Mechanical:
  - Mating Force: 35N MAX
  - Unmating Force: 10N MIN.
- DIMENSIONS MARKED "▼" TO BE CHECKED BY Q.C & IPQC.

4. PART NO.

USAF-08\*N-1\*P32

1Au 1U'  
6Au 30U'

W/WHITE  
B/BLACK  
1PBT  
2PA6T  
3PA9T  
4LCP

Bill of materials:

NO	PARTS	MATERIAL	QTY	FINISHING	X. ±0.35	X.' ±2'	UNITS	mm	雅安科技有限公司 ACCURATE INNOTECH INC.			
4	CLIP	COPPER ALLOY	1	PLATED NICKEL	.X ±0.3	.X' ±1'	MAT'L	SEE NOTE	TITLE:	PART NO.:		
3	HOUSING	PBT+30%GF	1	UL94V-0	.XX ±0.25	.XX'	SEE NOTE	FINISH	USB AF 180° 双层插板长体(2直脚)	USAF-08*N-1*P32		
2	SHELL	COPPER ALLOY/SPCC	1	PLATED NICKEL	.XXX ±0.15	.XXX'	SEE NOTE	Q'TY	DR: gan 2014/09/16	DWG NO.:		
1	TERMINAL	COPPER ALLOY	8	PLATED GOLD/TIN	THESE DRAWINGS AND SPECIFICATIONS ARE THE PROPERTY OF ACCURATE INNOTECH INC AND SHALL NOT BE REPRODUCED, COPIED OR USED IN ANY MANNER WITHOUT THE PRIOR WRITTEN CONSENT OF ACCURATE INNOTECH INC.				CHKD: gan 2014/09/16	AII-P32		
NO	PARTS	MATERIAL	QTY	FINISHING					APPD:	SCALE	SHEET	REV.