

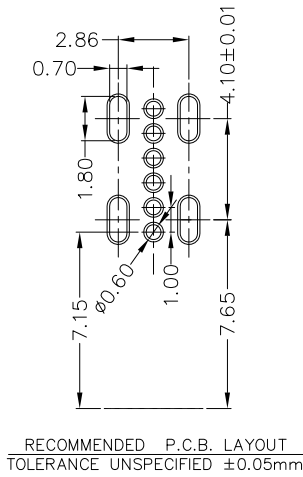

RoHS
Compliant
2002/95/EC

REV.	ECN.	NO.	APPD.

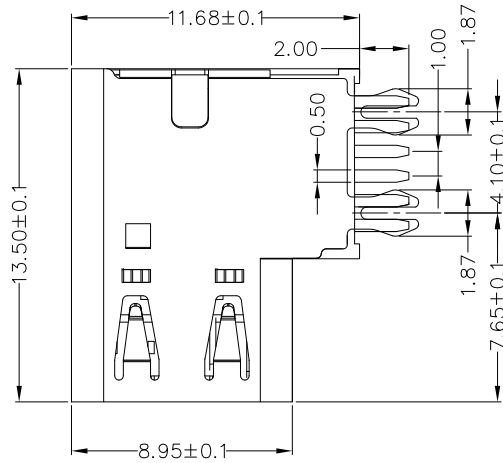

USB TYPE-C 6P
RECEPTACLE INTERFACE PIN ASSIGNMENTS

A5	CC1	B5	CC2
A9	VBUS	B9	VBUS
A12	GND	B12	GND
PIN	SIGNAL NAME	PIN	SIGNAL NAME

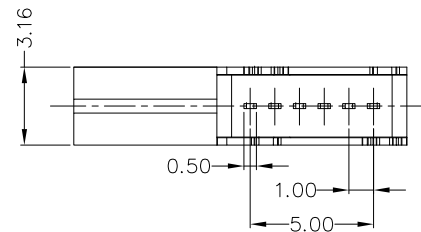
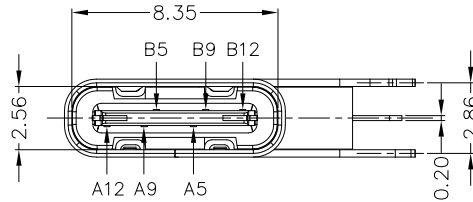

NOTES:

- ELECTRICAL:
 - CURRENT RATING: 3A MIN FOR VBUS; VOLTAGE: 5VAC MAX 0.25A MIN FOR OTHER.
 - INSULATION RESISTANCE: 100MΩ MIN;
 - CONTACT RESISTANCE: 40mΩ MAX;
 - WITHSTANDING VOLTAGE: 100V AC;
 - OPERATING TEMPERATURE: -30°C ~ +80°C.
- Mechanical:
 - INSERTION FORCE: 5~20N.
 - EXTRACTION FORCE: 3~20N.
- DIMENSIONS MARKED " " TO BE CHECKED BY Q.C & IPQC.
- PART NO. USCFC-061N-4BCG44

- 1: Au 1U"
- 2: Au 3U"
- 5: Au 15U"
- 6: Au 30U"
- W: WHITE
- B: BLACK
- 1: PBT
- 2: PA6T
- 3: PA9T
- 4: LCP

Bill of materials:

5					.X ±0.30	X.* ±2*	UNITS	mm	雅安科技有限公司 ACCURATE INNOTECH INC. TITLE: USB TYPE CF 侧插式13.5 DIP 6P 垫高2.68 四支鱼叉脚 PART NO.: USCFC-061N-4BCG44 DR: gan 2018/8/18 DWG NO.: All-CG44 CHKD: gan 2018/8/18 APPD:
4	SPRING	STAINLESS STEEL	1		.XX ±0.20	.X.* ±1*	MAT'L	SEE NOTE	
3	SHELL	STAINLESS STEEL	1	PLATED NICKEL	.XXX ±0.10	.XX.* ±0.5*	FINISH	SEE NOTE	
2	TERMINAL	COPPER ALLOY	6	PLATED GOLD/TIN			Q'TY		
1	HOUSING	LCP+30%GF	1	UL94V-0			UNITS	mm	
NO	PARTS	MATERIAL	QTY	FINISHING					SCALE: 1:1 SHEET: 1/1 REV: B CUSTOMER DRAWING

THESE DRAWINGS AND SPECIFICATIONS ARE THE PROPERTY OF ACCURATE INNOTECH INC. AND SHALL NOT BE REPRODUCED, COPIED OR USED IN ANY MANNER WITHOUT THE PRIOR WRITTEN CONSENT OF ACCURATE INNOTECH INC.