

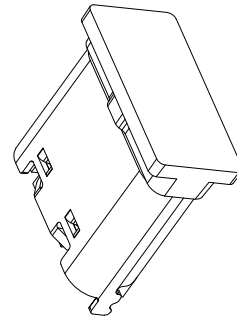

RoHS Compliant  
2002/95/EC

REV.	ECN.	NO.	APPD.

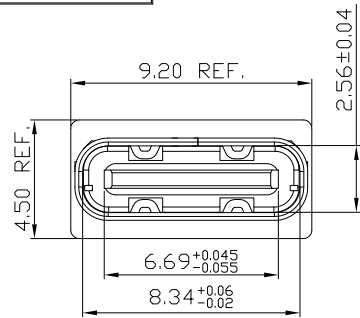

3D VIEW

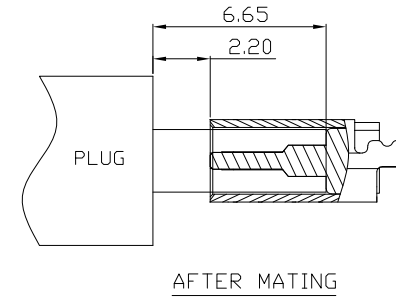

PIN	SIGNAL NAME
B12	GND
B9	VBUS
B5	CC2
A5	CC1
A9	VBUS
A12	GND

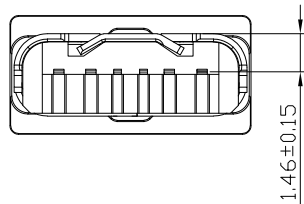
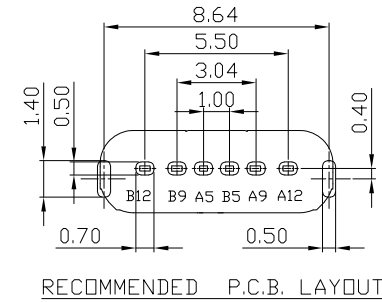
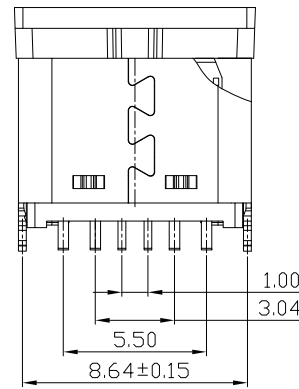
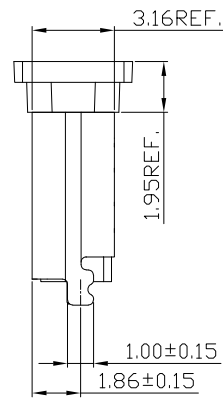
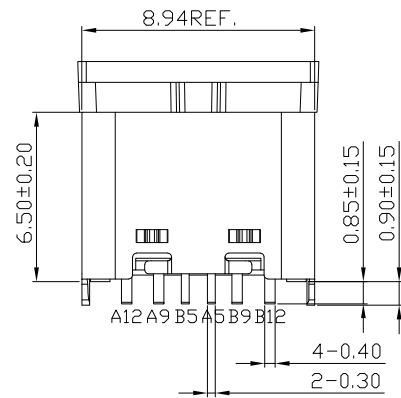

NOTES:

1.ELECTRICAL:

- 1)CURRENT RATING: 3A;
- 2)INSULATION RESISTANCE: 100MΩ MIN;
- 3)CONTACT RESISTANCE: 40mΩ MAX;
- 4)WITHSTANDING VOLTAGE: 100V AC;
- 5)OPERATING TEMPERATURE: -40°C TO +85°C.

2.MECHANICAL:

- 1)MATING FORCE: 5N~20N
- 2)UNMATING FORCE: 8N~20N(INITIAL);  
6~20N (AFTER DURABILITY TEST);
- 3)DURABILITY: 10,000 CYCLES

3.DIMENSIONS MARKED "▼"

TO BE CHECKED BY Q.C & IPQC.

4. PART NO.  
USCF-061N-4BPG517

- 1:1Au 1U\*
- 2:2Au 3U\*
- 5:5Au 15U\*
- 6:6Au 30U\*
- W:WHITE
- B:BLACK
- 1:PBT
- 2:PA6T
- 3:PA9T
- 4:LCP

Bill of materials:

NO	PARTS	MATERIAL	QTY	FINISHING	X.	±0.25	.X*	±2'	UNITS	mm	雅安科技有限公司 ACCURATE INNOTECH INC.				
5	CAP	LCP+30%GF	1	UL94V-0	.X	±0.25	.X*	±2'	MAT'L		TITLE:	PART NO.:			
4	MID PLATE	STAINLESS STEEL	1		.XX	±0.15			SEE NOTE		USB TYPE CF 6P 立插	USCF-061N-4BPG517			
3	SHELL	STAINLESS STEEL	1	PLATED NICKEL	.XXX	±0.10			FINISH		针长0.85 H=6.5	DWG NO.:			
2	TERMINAL	COPPER ALLOY	6	PLATED GOLD/TIN					SEE NOTE		DR:	AII-PG517			
1	HOUSING & MOLDING	LCP+30%GF	1	UL94V-0					Q'TY		CHKD:	SCALE SHEET REV. CUSTOMER			
											APPD:	1:1	1/1	B	DRAWING

THESE DRAWINGS AND SPECIFICATIONS ARE THE PROPERTY OF ACCURATE INNOTECH INC. AND SHALL NOT BE REPRODUCED, COPIED OR USED IN ANY MANNER WITHOUT THE PRIOR WRITTEN CONSENT OF ACCURATE INNOTECH INC.

