

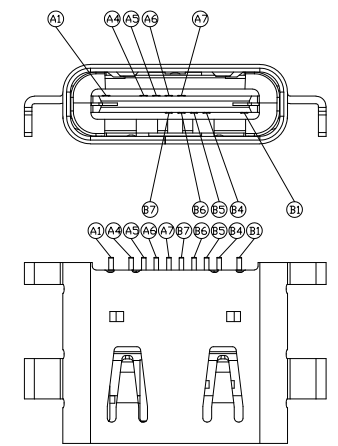

RoHS  
Compliant  
2002/95/EC

REV.	ECN.	NO.	APPD.

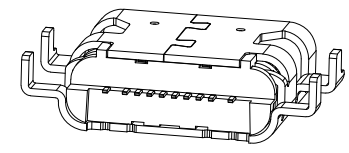
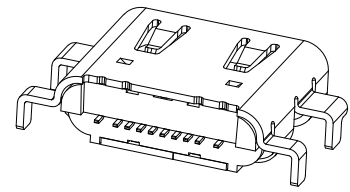
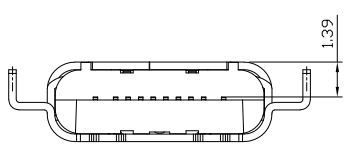

A1	GND		
A4	VBUS		
A5	CC1		
A6	DP1	B7	DN2
A7	DN1	B6	DP2
		B5	CC2
		B4	VBUS
		B1	GND
PIN	SIGNAL NAME	PIN	SIGNAL NAME

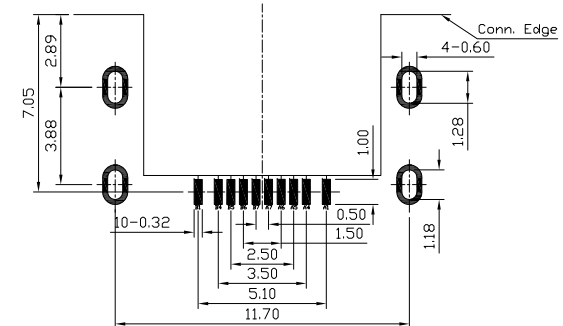
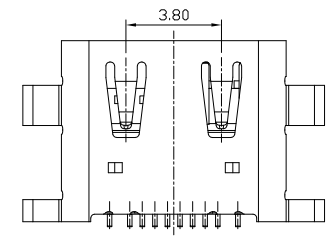
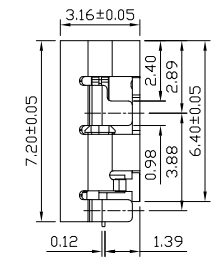
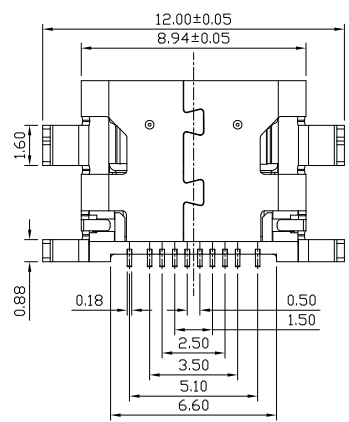

RECOMMENDED PCB LAYOUT(TOP VIEW)  
GENERAL TOLERANCES:±0.05

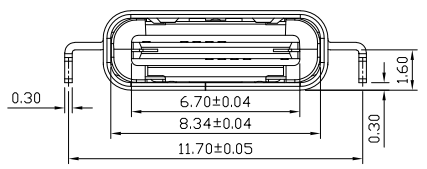

NOTES:

- ELECTRICAL:
  - CURRENT RATING: 3AMP MAX 30V DC;
  - INSULATION RESISTANCE: 100mΩ MIN;
  - CONTACT RESISTANCE: INITIAL 40mΩ MAX;
  - WITHSTANDING VOLTAGE: 100V AC FOR 1 MINUTE.
  - OPERATING TEMPERATURE:-30°C TO +80°C.
- Mechanical:
  - Mating Force: 5N~20N MAX.
  - Unmating Force: 8N~20N MIN.
  - Durability: ≥8,000 CYCLES.;
- DIMENSIONS MARKED "▼"  
TO BE CHECKED BY Q.C & IPQC.

4.PART NO.  
USCF-101N-4BVG31

1:Au 1U'	1:PBT
2:Au 3U'	2:PA6T
5:Au 15U'	3:PA9T
6:Au 30U'	4:LCP

W:WHITE  
B:BLACK

Bill of materials:

NO	PARTS	MATERIAL	QTY	FINISHING	UNITS	mm	TITLE:	PART NO.:
4	MID PLATE	STAINLESS STEEL	1		X.	±0.50	Angle ±1°	USCF-101N-4BVG31
3	SHELL	STAINLESS STEEL	1	PLATED GOLD/NICKEL	X	±0.20		USCF-10XN-4BVG31
2	TERMINAL	COPPER ALLOY	10	PLATED GOLD	XX	±0.10		USCF-10XN-4BVG31
1	HOUSING	LCP+30%GF	1	UL94V-0	XXX	±0.03		USCF-10XN-4BVG31

THESE DRAWINGS AND SPECIFICATIONS ARE THE PROPERTY OF ACCURATE INNOTECH INC AND SHALL NOT BE REPRODUCED, COPIED OR USED IN ANY MANNER WITHOUT THE PRIOR WRITTEN CONSENT OF ACCURATE INNOTECH INC.

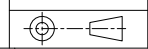

雅安科技有限公司  
ACCURATE INNOTECH INC.

DR: Ricky 2020/08/27	DWG NO: AII-VG31
CHKD: Ricky 2020/08/27	SCALE: 1:1
APPD:	SHEET: 1/1
	REV: B
	CUSTOMER DRAWING