

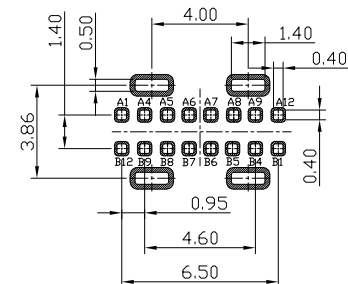

RoHS Compliant
2002/95/EC

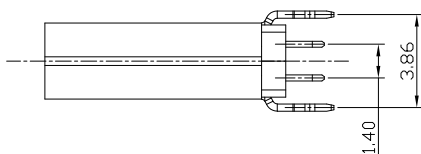
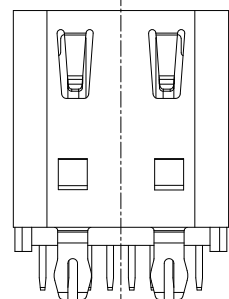
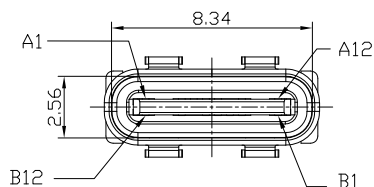
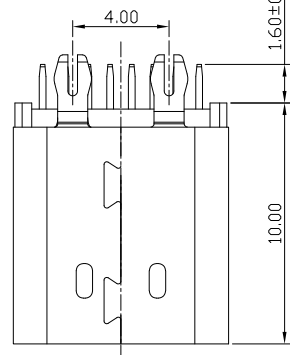
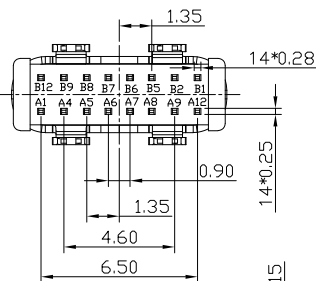

RECOMMENDED P.C.B. LAYOUT
TOLERANCE UNSPECIFIED ±0.05mm

NOTES:

1.ELECTRICAL:

- 1)VOLTAGE CURRENT RATING: 5A 20V
- 2)INSULATION RESISTANCE: 100MΩ MIN;
- 3)CONTACT RESISTANCE:
LLCR:VBUS & GND PINS AND OTHER PINS: 40mΩ/PIN MAX.
SHIELD:50mΩ/MAX.
LLCR MAX.CHANGE OF ALL PINS: 10mΩ.
- 4)WITHSTANDING VOLTAGE: 100V AC FOR 1 MINUTE.
- 5)OPERATING TEMPERATURE:-25°C TO +85°C.

2.Mechanical:

- 1)Mating Force: 5N~20N
- 2)Unmating Force: 8N~20N AFTER TEST.
- 3)Durability: 10,000 cycles

**3.DIMENSIONS MARKED "▼"
TO BE CHECKED BY Q.C & IPQC.**

USB TYPE-C PIN ASSIGNMENTS

PIN NUMBER	SIGNAL NAME	PIN NUMBER	SIGNAL NAME
A1	GND	B12	GND
A4	Vbus	B9	Vbus
A5	CC1	B8	SBU2
A6	Dp1	B7	Dn2
A7	Dn1	B6	Dp2
A8	SBU1	B5	CC2
A9	Vbus	B4	Vbus
A12	GND	B1	GND

REV.	ECN.	NO.	APPD.

Bill of materials:

NO	PARTS	MATERIAL	QTY	FINISHING	X.	±0.20	X.*	±2°	UNITS	mm	雅安科技有限公司 ACCURATE INNOTECH INC.			
4	FRONT SHELL	STAINLESS STEEL	1	PLATED NICKEL	X.	±0.20	X.*	±2°	UNITS	mm	TITLE: USB TYPE CF 16P 立式插板 脚长1.6mm 外殼魚叉腳 PART NO.: USCF-16XN-4BPH21 DR: Ricky 2021/08/04 DWG NO.: AII-PH21 CHKD: Ricky 2021/08/04 SCALE: 1:1 SHEET: 1/1 REV: B CUSTOMER DRAWING			
3	MID	STAINLESS STEEL	1	PLATED NICKEL	.X	±0.15	.X*	±1.5°	MAT'L	SEE NOTE				
2	CONTACT	COPPER ALLOY	16	PLATED GOLD/NICKEL	.XX	±0.10			FINISH	SEE NOTE				
1	HOUSING	LCP+30%GF	1	UL94V-0	.XXX	±0.05			Q'TY	SEE NOTE				
					THESE DRAWINGS AND SPECIFICATIONS ARE THE PROPERTY OF ACCURATE INNOTECH AND SHALL NOT BE REPRODUCED, COPIED OR USED IN ANY MANNER WITHOUT THE PRIOR WRITTEN CONSENT OF ACCURATE INNOTECH INC.									

