



RoHS
Compliant
2002/95/EC

Halogen Free

REV. ECN. NO. APPD.

Cap dimensions

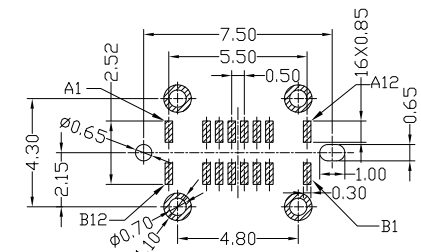
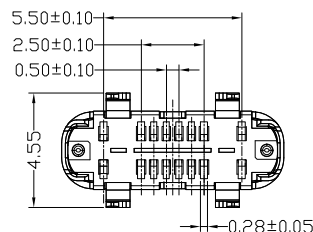
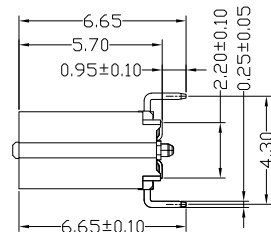
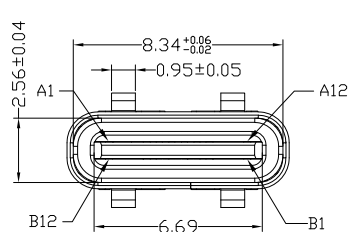
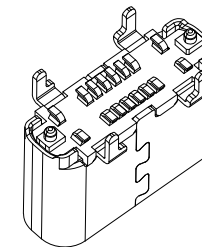
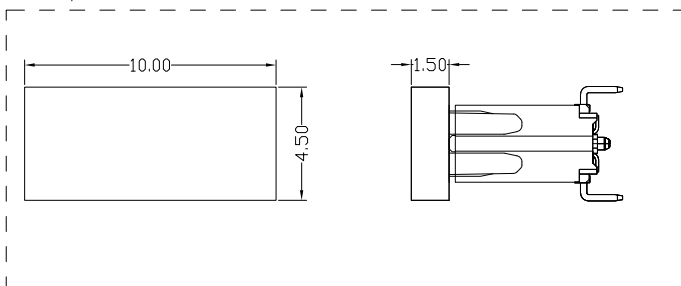
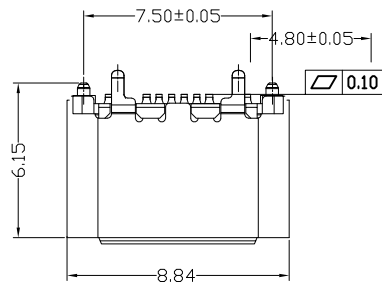

RECOMMENDED P.C.B. LAYOUT
TOLERANCE UNSPECIFIED ±0.03mm PCB T=1.0MM

NOTES:

1.ELECTRICAL:

1)CURRENT RATING:

VBUS AND GND CONTACTS RATED AT 3A Max
VBUS AND GND CONTACTS RATED AT 0.5A Min
0.9AMPS MAX. FOR ALL OTHER CONTACT.

PARALLELED FOR A TOTAL OF 5A;

2)INSULATION RESISTANCE: 100MΩ MIN;

3)CONTACT RESISTANCE: 40mΩ MAX;

4)WITHSTANDING VOLTAGE: 100V AC MIN;

5)OPERATING TEMPERATURE:-40°C TO +80°C.

2.Mechanical:

1)MATING FORCE: 5N~20N MAX

2)UNMATING FORCE: 8N~20N(INITIAL),

6N~20N(AFTER 10000 CYCLES) MIN.

3)REQUENCE: 200±50 CYCLES/HOUR,10000 CYCLES

3.DIMENSIONS MARKED "▼" TO BE

CHECKED BY Q.C & IPQC.

4.PART NO.

USCF-162N-3BQUA920

Type c Pin Assignments

A1	GND	B12	GND
A4	VBUS	B9	VBUS
A5	CC1	B8	SBU2
A6	DP1	B7	DN2
A7	DN1	B6	DP2
A8	SBU1	B5	CC2
A9	VBUS	B4	VBUS
A12	GND	B1	GND
PIN	SIGNAL NAME	PIN	SIGNAL NAME

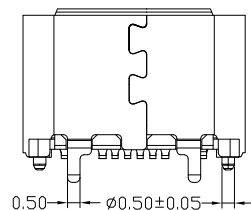

Bill of materials:

NO	PARTS	MATERIAL	QTY	FINISHING			UNITS	mm	雅安科技有限公司 ACCURATE INNOTECH INC.				
6					X	±0.15	X.	±1°	TITLE: USB TYPE CF 16P 立贴 H5.7	PART NO.:			SCALE SHEET REV. CUSTOMER 1:1 1/1 B DRAWING
5	CAP	LCP+30%GF	1	UL94V-0	XX	±0.10				USCF-16XN-3BQUA920			
4	LATCH	STAINLESS STEEL	1		XXX	±0.05				DR: Ricky 2024/01/23			
3	SHELL	STAINLESS STEEL	1	PLATED NICKEL						DWG NO.:			
2	CONTACT	COPPER ALLOY	16	PLATED GOLD/TIN					AII-QUA920				
1	HOUSING	PA9T+30%GF	1	UL94V-0					CHKD: Ricky 2024/01/23				
									APPD:				

THESE DRAWINGS AND SPECIFICATIONS ARE THE PROPERTY OF ACCURATE INNOTECH INC AND SHALL NOT BE REPRODUCED, COPIED OR USED IN ANY MANNER WITHOUT THE PRIOR WRITTEN CONSENT OF ACCURATE INNOTECH INC.

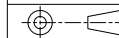

1:Au 1U*
2:Au 3U*
6:Au 30U*

W:WHITE
B:BLACK
1:PBT
2:PA6T
3:PA9T
4:LCP