

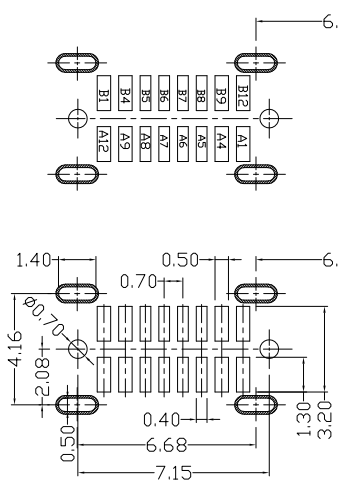

RoHS Compliant
2002/95/EC

REV.	ECN. NO.	APPD.

A1	GND	B12	GND
A2	/	B11	/
A3	/	B10	/
A4	VBUS	B9	VBUS
A5	CC1	B8	SBU2
A6	DP1	B7	DN2
A7	DN1	B6	DP2
A8	SBU1	B5	CC2
A9	VBUS	B4	VBUS
A10	/	B3	/
A11	/	B2	/
A12	GND	B1	GND

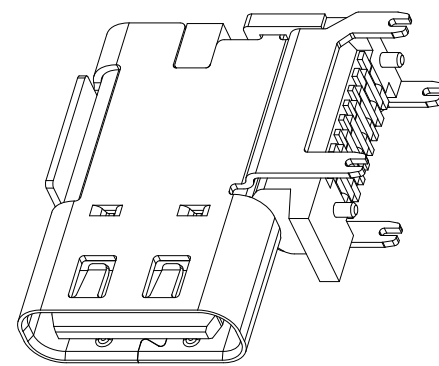
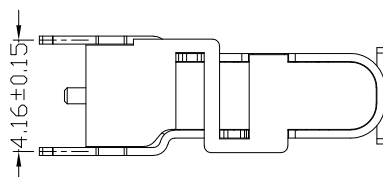
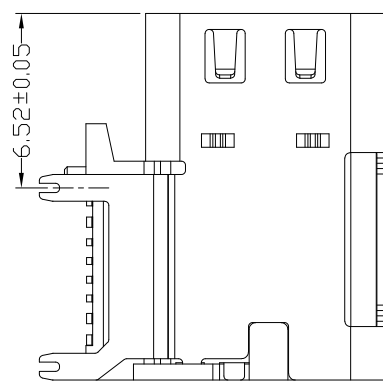
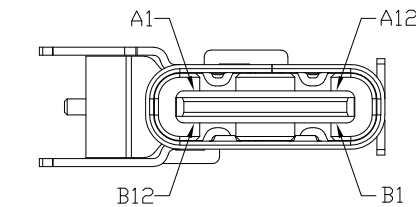
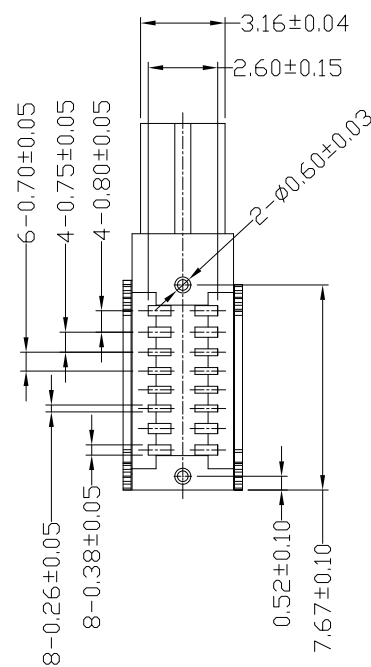
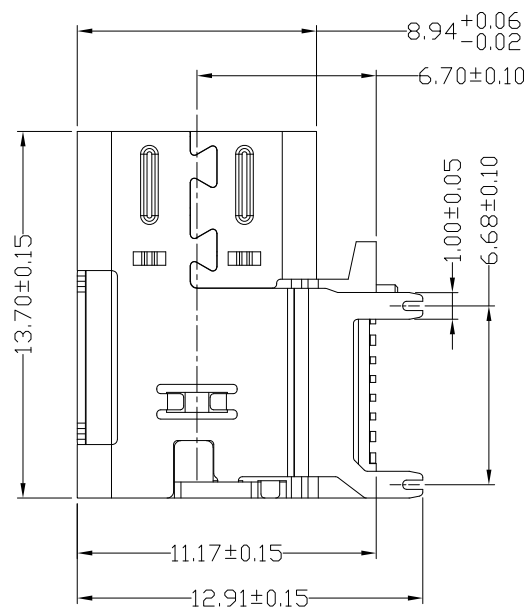

RECOMMENDED P.C.B. LAYOUT

CONNECTOR FRONT EDGE

- NOTES:
 1.ELECTRICAL:
 1)RATING: 3A MAX.
 2)INSULATION RESISTANCE: 150V DC / 100MΩ MIN.
 3)CONTACT RESISTANCE: 30mΩ MAX.
 4)WITHSTANDING VOLTAGE: 150V AC / 1 mA MAX.
 5)OPERATING TEMPERATURE:-25°C TO +85°C.
 2.Mechanical:
 1)Mating Force: 5N~20N.
 2)Unmating Force: 8N~20N.
 3)Durability: 10,000 cycles
 3.DIMENSIONS MARKED '▼'
 TO BE CHECKED BY Q.C & IPQC.

USCF-162N-4BMG50

1Au 1U*	W:WHITE
2Au 3U*	B:BLACK
5Au 15U*	1:PBT
6Au 30U*	2:PA6T
	3:PA9T
	4:PC

Bill of materials:

NO	PARTS	MATERIAL	QTY	FINISHING				
4	SHELL	STAINLESS STEEL	1	PLATED NICKEL	X.	±0.50	X.*	±2°
3	CONTACT	COPPER ALLOY	16	PLATED GOLD	.X	±0.20	.X.*	±1°
2	HOUSING	LCP+30%GF	1	UL94V-0	.XX	±0.10		
1	HOOK	STAINLESS STEEL	1		.XXX	±0.05		

THESE DRAWINGS AND SPECIFICATIONS ARE THE PROPERTY OF ACCURATE INNOTECH AND SHALL NOT BE REPRODUCED, COPIED OR USED IN ANY MANNER WITHOUT THE PRIOR WRITTEN CONSENT OF ACCURATE INNOTECH INC

UNITS mm		雅安科技有限公司 ACCURATE INNOTECH INC.	
MAT'L			
SEE NOTE		TITLE: USB TYPE CF 16P 侧立贴板垫高2.23	PART NO.: USCF-16XN-4BMG50
FINISH		DR: Ricky 2021/07/01	DWG NO.: AII-MG50
SEE NOTE		CHKD: Ricky 2021/07/01	SCALE SHEET REV. CUSTOMER 1:1 1/1 B DRAWING
Q'TY		APPD:	