

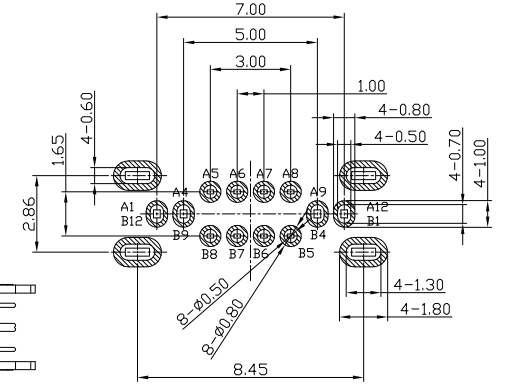

RoHS
Compliant
2002/95/EC

REV.	ECN. NO.	APPD.

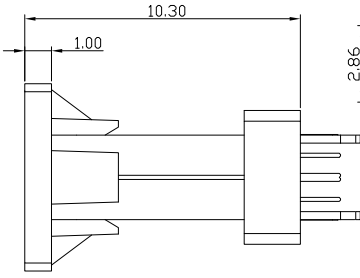
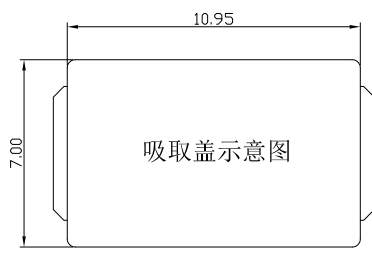
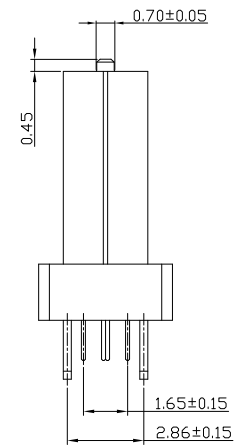
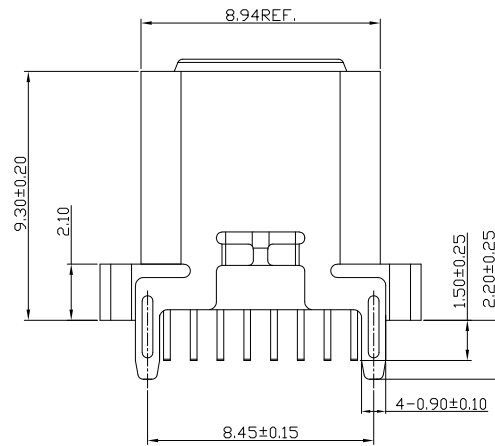
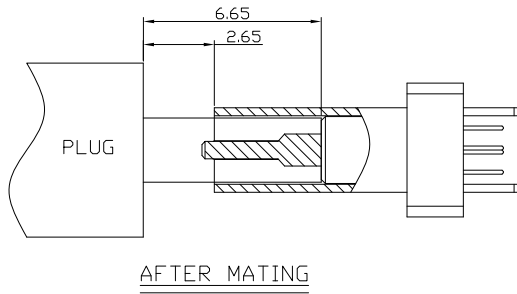
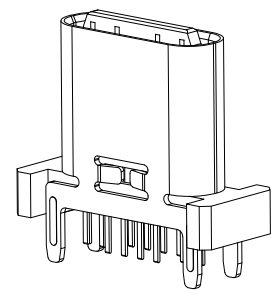
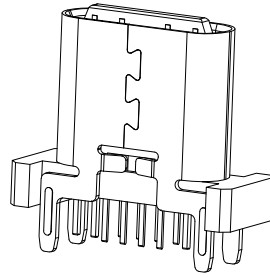
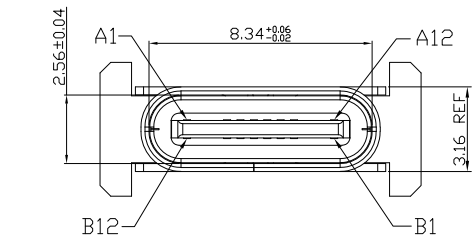

RECOMMENDED P.C.B. LAYOUT
TOLERANCE UNSPECIFIED ±0.05mm

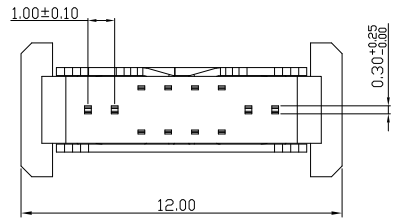

A1	GND	B12	GND
A4	VBUS	B9	VBUS
A5	CC1	B8	SBU2
A6	D+	B7	Dn2
A7	D-	B6	Dp2
A8	SBU1	B5	CC2
A9	VBUS	B4	VBUS
A12	GND	B1	GND
PIN	SIGNAL NAME	PIN	SIGNAL NAME

NOTES:

1.ELECTRICAL:

- 1)CURRENT RATING: 5A;
- 2)INSULATION RESISTANCE: 150V DC/100MΩ MIN;
- 3)CONTACT RESISTANCE: 40mΩ MAX;
- 4)WITHSTANDING VOLTAGE: 100V AC;
- 5)OPERATING TEMPERATURE:-40°C TO +85°C.

2.MECHANICAL:

- 1)MATING FORCE: 5N~20N
- 2)UNMATING FORCE: 8N~20N(INITIAL);
6~20N (AFTER DURABILITY TEST);
- 3)DURABILITY: 10,000 CYCLES

3.DIMENSIONS MARKED "▼"
TO BE CHECKED BY Q.C & IPQC.

USCF-162N-4BPG50

- 1: Au 1U"
- 2: Au 3U"
- 5: Au 15U"
- 6: Au 30U"
- W: WHITE
- B: BLACK
- 1: PBT
- 2: PA6T
- 3: PA9T
- 4: LCP

Bill of materials:

4	MID PLATE	STAINLESS STEEL	1	
3	SHELL	STAINLESS STEEL	1	PLATED NICKEL
2	TERMINAL	COPPER ALLOY	16	PLATED GOLD
1	HOUSING & MOLDING	LCP+30%GF	1	UL94V-0
NO	PARTS	MATERIAL	QTY	FINISHING

X	±0.25	X*	±2°	UNITS	mm
X.X	±0.20			MAT'L	
X.XX	±0.15			SEE NOTE	
X.XXX	±0.10			FINISH	
				SEE NOTE	
				Q'TY	

雅安科技有限公司
ACCURATE INNOTECH INC.

TITLE: USB TYPE CF 16P 立插 针长1.50
舌片外露 H=9.3

PART NO.: USCF-16XN-4BPG50

DR: Ricky 2024/11/25

CHKD: Ricky 2024/11/25

APPD:

DWG NO.: AII-PG50

SCALE: 1:1

SHEET: 1/1

REV. B

CUSTOMER DRAWING

THESE DRAWINGS AND SPECIFICATIONS ARE THE PROPERTY OF ACCURATE INNOTECHING AND SHALL NOT BE REPRODUCED, COPIED OR USED IN ANY MANNER WITHOUT THE PRIOR WRITTEN CONSENT OF ACCURATE INNOTECH INC



RoHS Compliant
2002/95/EC

REV.	ECN. NO.	APPD.

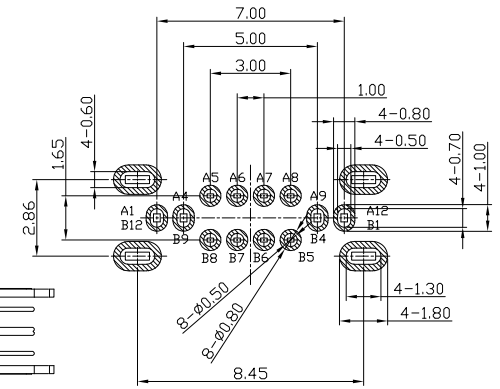
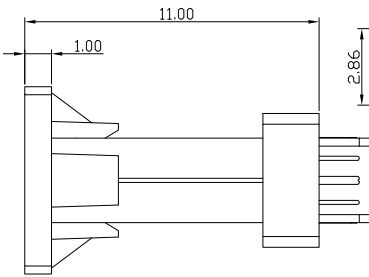
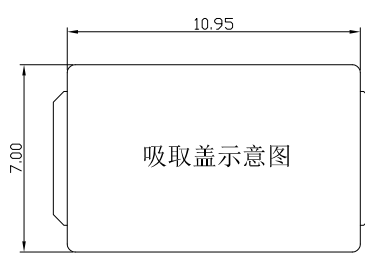
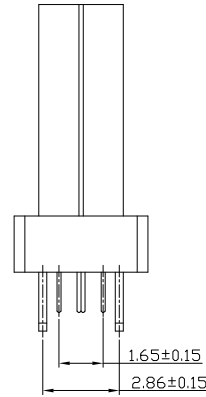
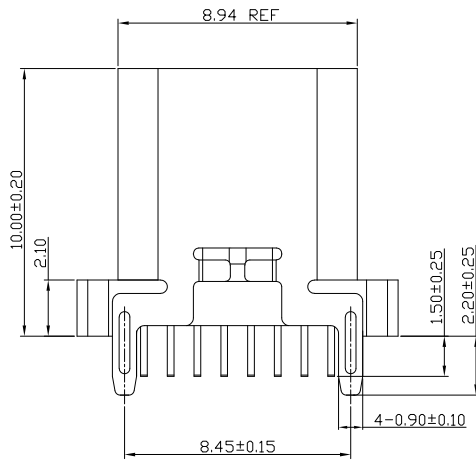
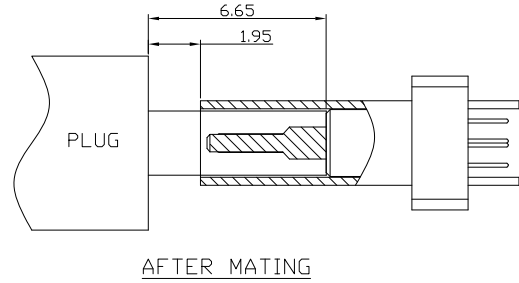
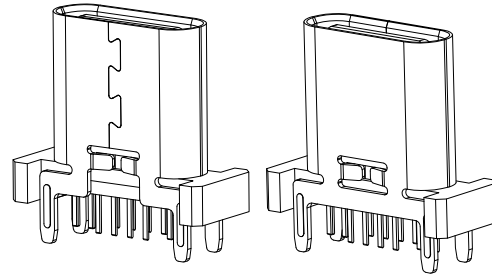
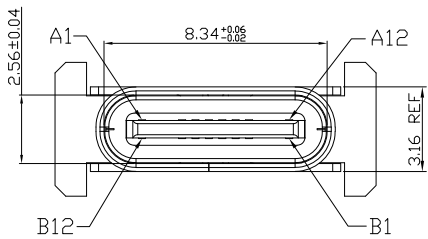

RECOMMENDED P.C.B. LAYOUT
TOLERANCE UNSPECIFIED ±0.05mm

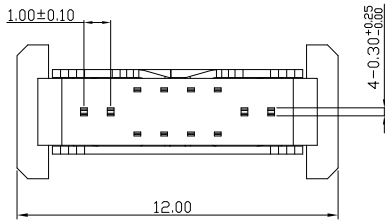

A1	GND	B12	GND
A4	VBUS	B9	VBUS
A5	CC1	B8	SBU2
A6	D+	B7	Dn2
A7	D-	B6	Dp2
A8	SBU1	B5	CC2
A9	VBUS	B4	VBUS
A12	GND	B1	GND
PIN	SIGNAL NAME	PIN	SIGNAL NAME

NOTES:

1.ELECTRICAL:

- 1)CURRENT RATING: 5A;
- 2)INSULATION RESISTANCE: 150V DC/100MΩ MIN;
- 3)CONTACT RESISTANCE: 40mΩ MAX;
- 4)WITHSTANDING VOLTAGE: 100V AC;
- 5)OPERATING TEMPERATURE:-40°C TO +85°C.

2.MECHANICAL:

- 1)MATING FORCE: 5N~20N
- 2)UNMATING FORCE: 8N~20N(INITIAL);
6~20N (AFTER DURABILITY TEST);
- 3)DURABILITY: 10,000 CYCLES

3.DIMENSIONS MARKED "▼"

TO BE CHECKED BY Q.C & IPQC.

USCF-162N-4BPG51

- 1: Au 1U"
- 2: Au 3U"
- 5: Au 15U"
- 6: Au 30U"
- W: WHITE
- B: BLACK
- 1: PBT
- 2: PA6T
- 3: PA9T
- 4: LCP

Bill of materials:

4	MID PLATE	STAINLESS STEEL	1		X ±0.25	X* ±2°	UNITS mm	雅安科技有限公司 ACCURATE INNOTECH INC. TITLE: USB TYPE CF 16P 立插 针长1.50 IF=10.0 PART NO.: USCF-16XN-4BPG51 DR: Ricky 2024/11/25 DWG NO.: AII-PG51 CHKD: Ricky 2024/11/25 APPD:			
3	SHELL	STAINLESS STEEL	1	PLATED NICKEL	X.X ±0.20		MAT'L				
2	TERMINAL	COPPER ALLOY	16	PLATED GOLD	X.XX ±0.15		SEE NOTE				
1	HOUSING & MOLDING	LCP+30%GF	1	UL94V-0	X.XXX ±0.10		SEE NOTE				
NO	PARTS	MATERIAL	QTY	FINISHING	THESE DRAWINGS AND SPECIFICATIONS ARE THE PROPERTY OF ACCURATE INNOTECH AND SHALL NOT BE REPRODUCED, COPIED OR USED IN ANY MANNER WITHOUT THE PRIOR WRITTEN CONSENT OF ACCURATE INNOTECH INC.		Q'TY	SCALE 1:1	SHEET 1/1	REV. B	CUSTOMER DRAWING



RoHS
Compliant
2002/95/EC

REV.	ECN. NO.	APPD.

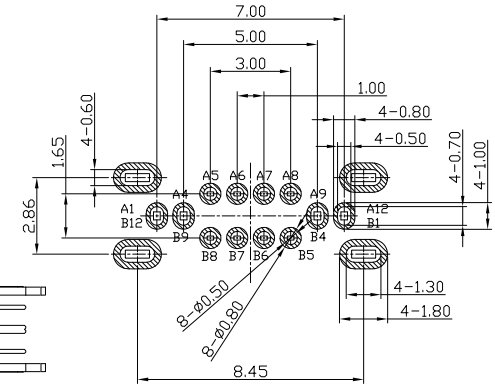
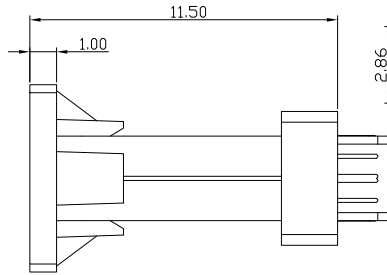
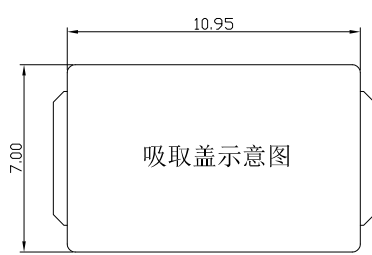
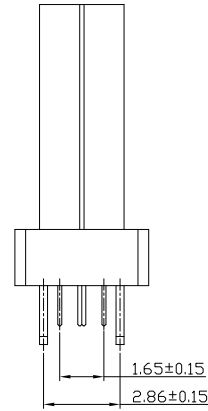
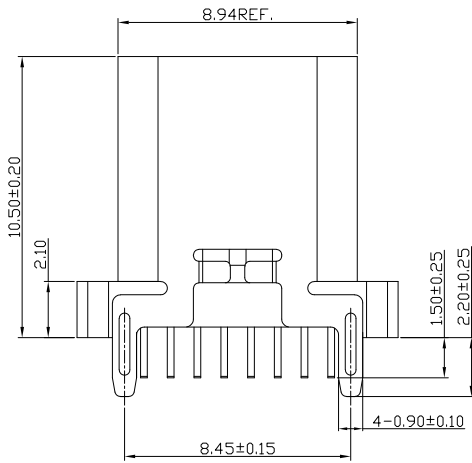
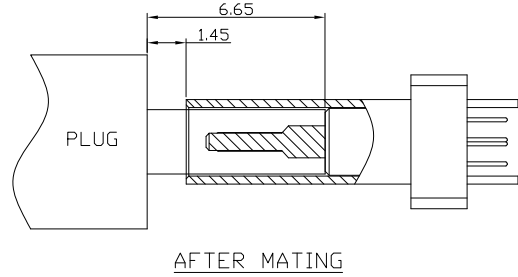
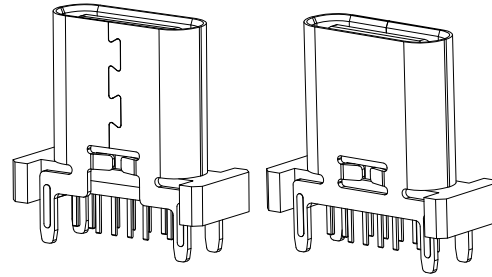
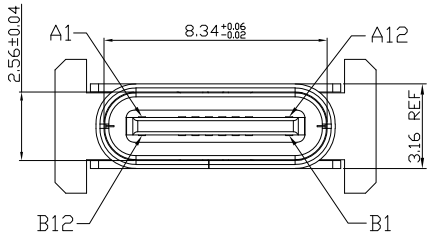

RECOMMENDED P.C.B. LAYOUT
TOLERANCE UNSPECIFIED ±0.05mm

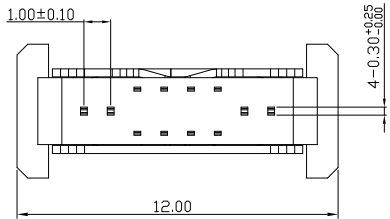

A1	GND	B12	GND
A4	VBUS	B9	VBUS
A5	CC1	B8	SBU2
A6	D+	B7	Dn2
A7	D-	B6	Dp2
A8	SBU1	B5	CC2
A9	VBUS	B4	VBUS
A12	GND	B1	GND
PIN	SIGNAL NAME	PIN	SIGNAL NAME

NOTES:

1.ELECTRICAL:

- CURRENT RATING: 5A;
- INSULATION RESISTANCE: 150V DC/100MΩ MIN;
- CONTACT RESISTANCE: 40mΩ MAX;
- WITHSTANDING VOLTAGE: 100V AC;
- OPERATING TEMPERATURE: -40°C TO +85°C.

2.MECHANICAL:

- MATING FORCE: 5N~20N
- UNMATING FORCE: 8N~20N(INITIAL);
6~20N (AFTER DURABILITY TEST);
- DURABILITY: 10,000 CYCLES

3.DIMENSIONS MARKED "▼"

TO BE CHECKED BY Q.C & IPQC.

USCF-162N-4BPG52

- 1: Au 1U"
- 2: Au 3U"
- 5: Au 15U"
- 6: Au 30U"
- W: WHITE
- B: BLACK
- 1: PBT
- 2: PA6T
- 3: PA9T
- 4: LCP

Bill of materials:

4	MID PLATE	STAINLESS STEEL	1	
3	SHELL	STAINLESS STEEL	1	PLATED NICKEL
2	TERMINAL	COPPER ALLOY	16	PLATED GOLD
1	HOUSING & MOLDING	LCP+30%GF	1	UL94V-0
NO	PARTS	MATERIAL	QTY	FINISHING

X	±0.25	X*	±2°	UNITS	mm
X.X	±0.20			MAT'L	
X.XX	±0.15			SEE NOTE	
X.XXX	±0.10			FINISH	
				SEE NOTE	
				Q'TY	

雅安科技有限公司 ACCURATE INNOTECH INC.			
TITLE: USB TYPE CF 16P 立插 针长1.50 H=10.5		PART NO.: USCF-16XN-4BPG52	
DR: Ricky 2024/11/25		DWG NO.: AII-PG52	
CHKD: Ricky 2024/11/25		SCALE	SHEET
APPD:		1:1	1/1
		REV.	CUSTOMER
		B	DRAWING

THESE DRAWINGS AND SPECIFICATIONS ARE THE PROPERTY OF ACCURATE INNOTECH INC. AND SHALL NOT BE REPRODUCED, COPIED OR USED IN ANY MANNER WITHOUT THE PRIOR WRITTEN CONSENT OF ACCURATE INNOTECH INC.

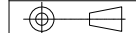



RoHS
Compliant
2002/95/EC

REV.	ECN. NO.	APPD.

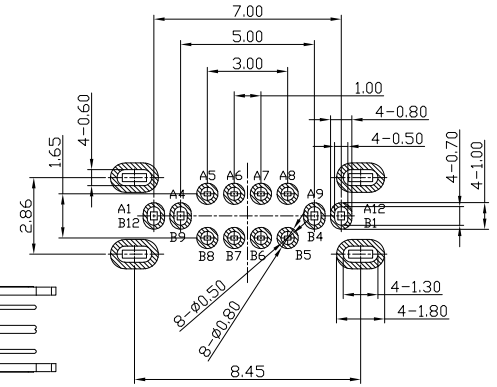
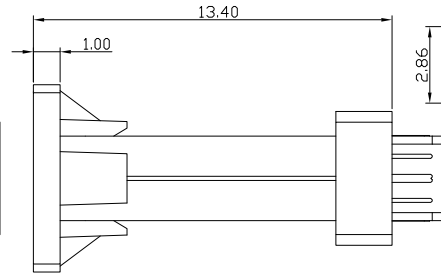
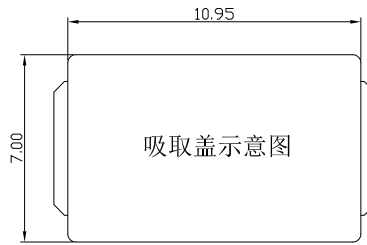
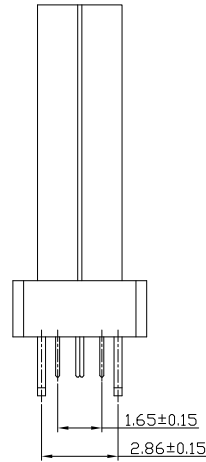
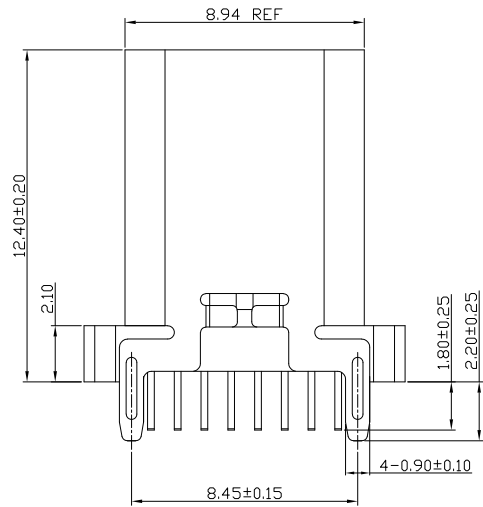
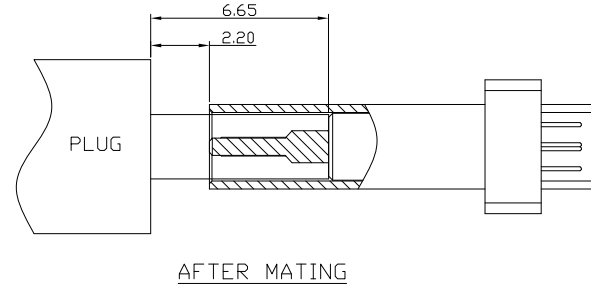
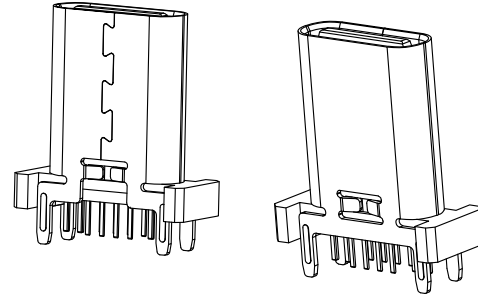
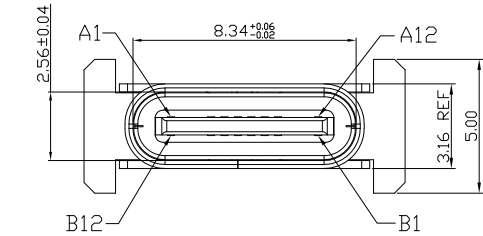

RECOMMENDED P.C.B. LAYOUT
TOLERANCE UNSPECIFIED ±0.05mm

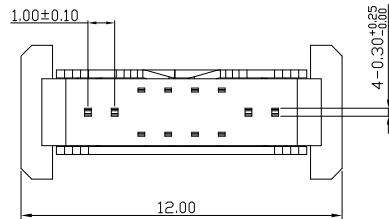

A1	GND	B12	GND
A4	VBUS	B9	VBUS
A5	CC1	B8	SBU2
A6	D+	B7	Dn2
A7	D-	B6	Dp2
A8	SBU1	B5	CC2
A9	VBUS	B4	VBUS
A12	GND	B1	GND
PIN	SIGNAL NAME	PIN	SIGNAL NAME

NOTES:

1.ELECTRICAL:

- CURRENT RATING: 5A;
- INSULATION RESISTANCE: 150V DC/100MΩ MIN;
- CONTACT RESISTANCE: 40mΩ MAX;
- WITHSTANDING VOLTAGE: 100V AC;
- OPERATING TEMPERATURE: -40°C TO +85°C.

2.MECHANICAL:

- MATING FORCE: 5N~20N
- UNMATING FORCE: 8N~20N(INITIAL);
6~20N (AFTER DURABILITY TEST);
- DURABILITY: 10,000 CYCLES

3.DIMENSIONS MARKED "▼"
TO BE CHECKED BY Q.C & IPQC.

USCF-162N-4BPG53

- 1: Au 1U*
2: Au 3U*
5: Au 15U*
6: Au 30U*
- W: WHITE
B: BLACK
- 1: PBT
2: PA6T
3: PA9T
4: LCP

Bill of materials:

4	MID PLATE	STAINLESS STEEL	1	
3	SHELL	STAINLESS STEEL	1	PLATED NICKEL
2	TERMINAL	COPPER ALLOY	16	PLATED GOLD
1	HOUSING & MOLDING	LCP+30%GF	1	UL94V-0
NO	PARTS	MATERIAL	QTY	FINISHING

X	±0.25	X*	±2°	UNITS	mm
X.X	±0.20			MAT'L	
X.XX	±0.15			SEE NOTE	
X.XXX	±0.10			FINISH	
				SEE NOTE	
				Q'TY	

雅安科技有限公司 ACCURATE INNOTECH INC.			
TITLE: USB TYPE CF 16P 立插 针长1.80 H=12.4		PART NO.: USCF-16XN-4BPG53	
DR: Ricky 2024/11/25		DWG NO.: AII-PG53	
CHKD: Ricky 2024/11/25		SCALE	SHEET
APPD:		1:1	1/1
		REV.	CUSTOMER
		B	DRAWING

THESE DRAWINGS AND SPECIFICATIONS ARE THE PROPERTY OF ACCURATE INNOTECH INC. AND SHALL NOT BE REPRODUCED, COPIED OR USED IN ANY MANNER WITHOUT THE PRIOR WRITTEN CONSENT OF ACCURATE INNOTECH INC.

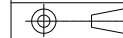



RoHS
Compliant
2002/95/EC

REV.	ECN. NO.	APPD.

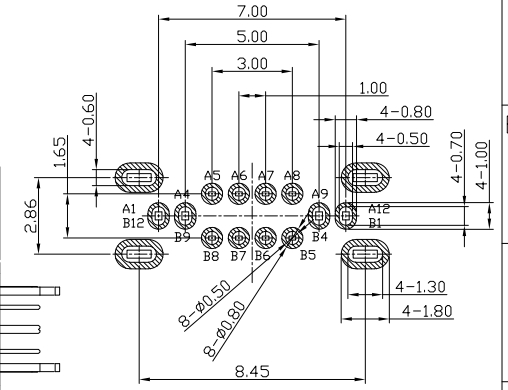
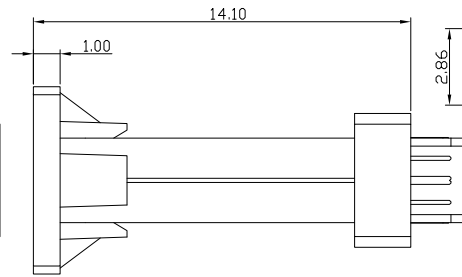
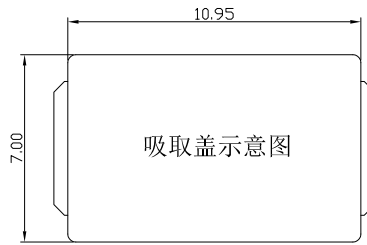
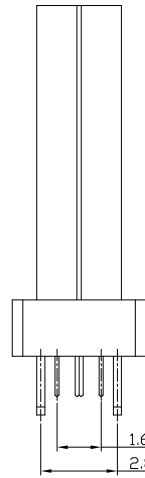
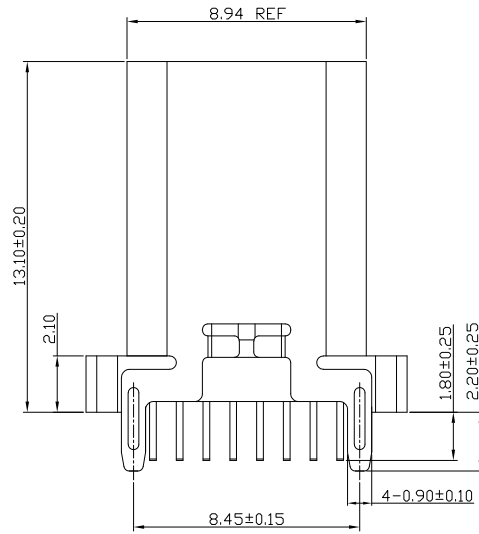
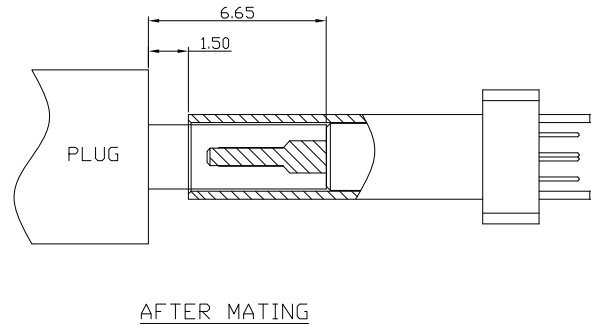
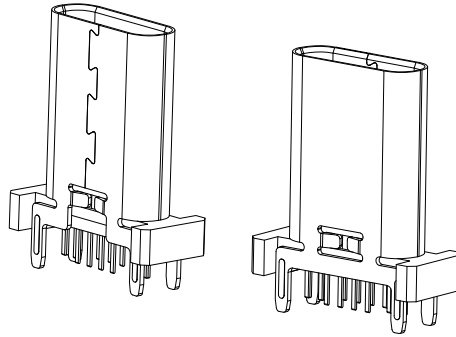
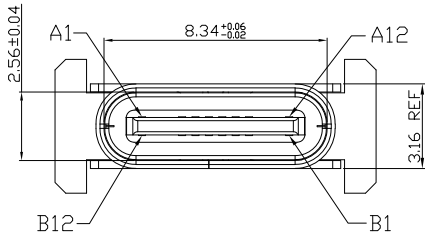

RECOMMENDED P.C.B. LAYOUT
TOLERANCE UNSPECIFIED ±0.05mm

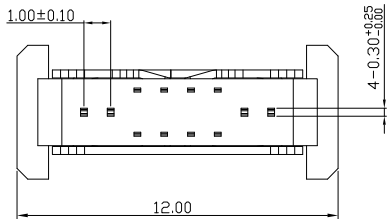

A1	GND	B12	GND
A4	VBUS	B9	VBUS
A5	CC1	B8	SBU2
A6	D+	B7	Dn2
A7	D-	B6	Dp2
A8	SBU1	B5	CC2
A9	VBUS	B4	VBUS
A12	GND	B1	GND
PIN	SIGNAL NAME	PIN	SIGNAL NAME

NOTES:

1.ELECTRICAL:

- CURRENT RATING: 5A;
- INSULATION RESISTANCE: 150V DC/100MΩ MIN;
- CONTACT RESISTANCE: 40mΩ MAX;
- WITHSTANDING VOLTAGE: 100V AC;
- OPERATING TEMPERATURE: -40°C TO +85°C.

2.MECHANICAL:

- MATING FORCE: 5N~20N
- UNMATING FORCE: 8N~20N(INITIAL);
6~20N (AFTER DURABILITY TEST);
- DURABILITY: 10,000 CYCLES

3.DIMENSIONS MARKED "▼"
TO BE CHECKED BY Q.C & IPQC.

USCF-162N-4BPG54

- 1:AU 1U"
- 2:AU 3U"
- 5:AU 15U"
- 6:AU 30U"
- W:WHITE
- B:BLACK
- 1:PBT
- 2:PA6T
- 3:PA9T
- 4:LCP

Bill of materials:

4	MID PLATE	STAINLESS STEEL	1		X	±0.25	X*	±2°	UNITS	mm	<p>雅安科技有限公司 ACCURATE INNOTECH INC.</p> <p>TITLE: USB TYPE CF 16P 立插 针长1.80 H#13.1</p> <p>PART NO.: USCF-16XN-4BPG54</p> <p>DR: Ricky 2024/11/25</p> <p>CHKD: Ricky 2024/11/25</p> <p>DWG NO.: AII-PG54</p> <p>SCALE SHEET REV. CUSTOMER 1:1 1/1 B DRAWING</p>			
3	SHELL	STAINLESS STEEL	1	PLATED NICKEL	X.X	±0.20			MAT'L					
2	TERMINAL	COPPER ALLOY	16	PLATED GOLD	X.XX	±0.15			SEE NOTE					
1	HOUSING & MOLDING	LCP+30%GF	1	UL94V-0	X.XXX	±0.10			SEE NOTE					
NO	PARTS	MATERIAL	QTY	FINISHING					Q'TY		<p>THESE DRAWINGS AND SPECIFICATIONS ARE THE PROPERTY OF ACCURATE INNOTECH AND SHALL NOT BE REPRODUCED, COPIED OR USED IN ANY MANNER WITHOUT THE PRIOR WRITTEN CONSENT OF ACCURATE INNOTECH INC.</p>			



RoHS
Compliant
2002/95/EC

REV.	ECN. NO.	APPD.

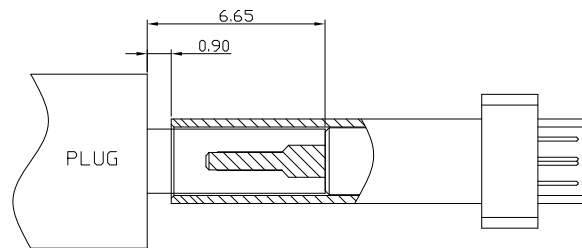
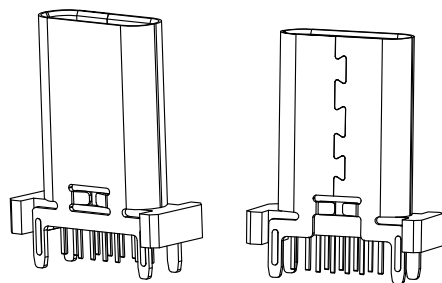
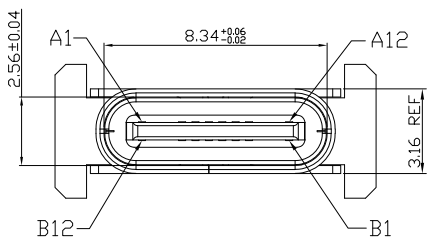

AFTER MATING

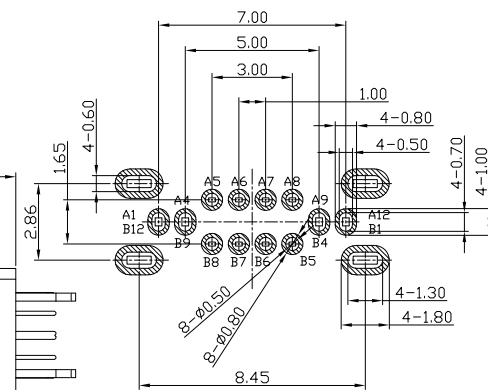
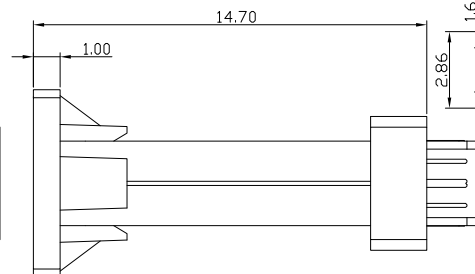
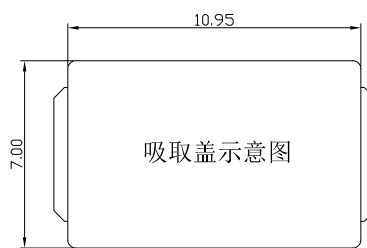
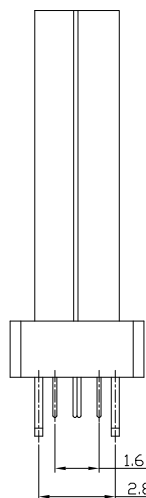
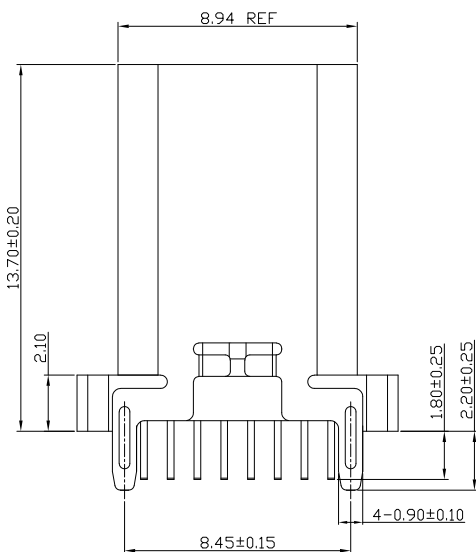

RECOMMENDED P.C.B. LAYOUT
TOLERANCE UNSPECIFIED ±0.05mm

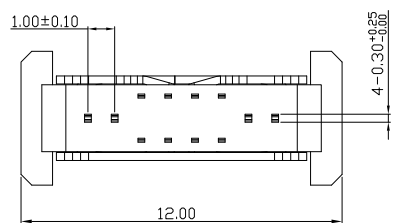

A1	GND	B12	GND
A4	VBUS	B9	VBUS
A5	CC1	B8	SBU2
A6	D+	B7	Dn2
A7	D-	B6	Dp2
A8	SBU1	B5	CC2
A9	VBUS	B4	VBUS
A12	GND	B1	GND
PIN	SIGNAL NAME	PIN	SIGNAL NAME

NOTES:

1.ELECTRICAL:

- CURRENT RATING: 5A;
- INSULATION RESISTANCE: 150V DC/100MΩ MIN;
- CONTACT RESISTANCE: 40mΩ MAX;
- WITHSTANDING VOLTAGE: 100V AC;
- OPERATING TEMPERATURE: -40°C TO +85°C.

2.MECHANICAL:

- MATING FORCE: 5N~20N
- UNMATING FORCE: 8N~20N(INITIAL);
6~20N (AFTER DURABILITY TEST);
- DURABILITY: 10,000 CYCLES

3.DIMENSIONS MARKED "▼"
TO BE CHECKED BY Q.C & IPQC.

USCF-162N-4BPG55

- 1: Au 1U*
- 2: Au 3U*
- 5: Au 15U*
- 6: Au 30U*
- W: WHITE
- B: BLACK
- 1: PBT
- 2: PA6T
- 3: PA9T
- 4: LCP

Bill of materials:

4	MID PLATE	STAINLESS STEEL	1		X	±0.25	X*	±2°	UNITS	mm
3	SHELL	STAINLESS STEEL	1	PLATED NICKEL	X.X	±0.20			MAT'L	
2	TERMINAL	COPPER ALLOY	16	PLATED GOLD	X.XX	±0.15			SEE NOTE	
1	HOUSING & MOLDING	LCP+30%GF	1	UL94V-0	X.XXX	±0.10			FINISH	SEE NOTE
NO	PARTS	MATERIAL	QTY	FINISHING					Q'TY	

THESE DRAWINGS AND SPECIFICATIONS ARE THE PROPERTY OF ACCURATE INNNOTECH INC AND SHALL NOT BE REPRODUCED, COPIED OR USED IN ANY MANNER WITHOUT THE PRIOR WRITTEN CONSENT OF ACCURATE INNNOTECH INC

雅安科技有限公司 ACCURATE INNNOTECH INC.			
TITLE: USB TYPE CF 16P 立插 针长1.80 H=13.7		PART NO.: USCF-16XN-4BPG55	
DR: <i>Ricky</i> 2024/11/25		DWG NO.: AII-PG55	
CHKD: <i>Ricky</i> 2024/11/25		SCALE	SHEET
APPD:		1:1	1/1
		REV.	CUSTOMER DRAWING
		B	



RoHS Compliant
2002/95/EC

REV.	ECN. NO.	APPD.

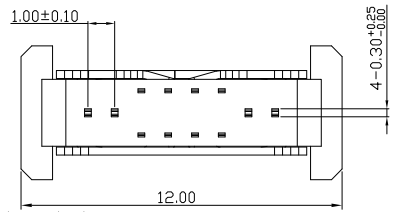
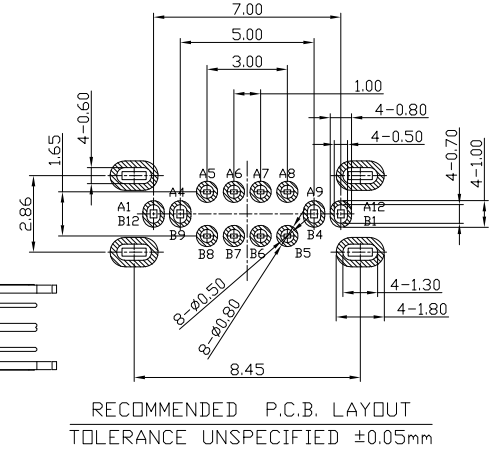
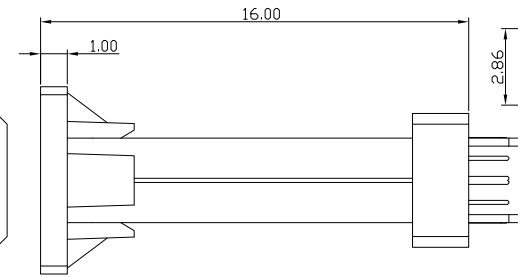
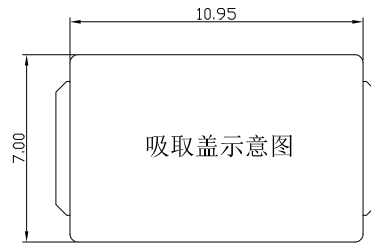
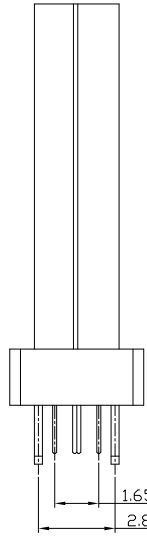
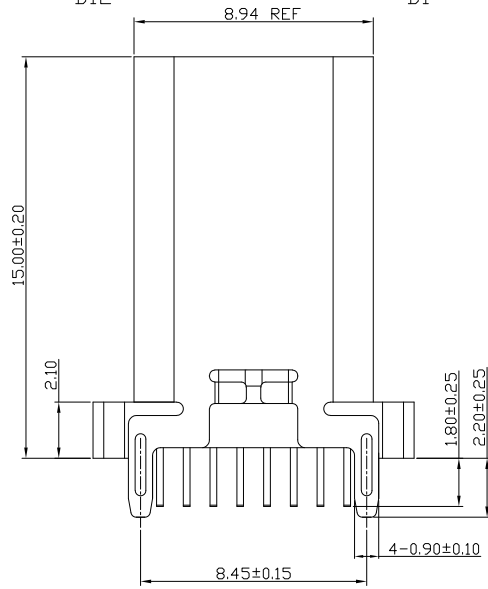
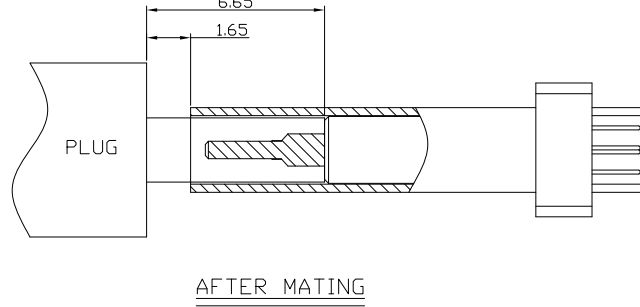
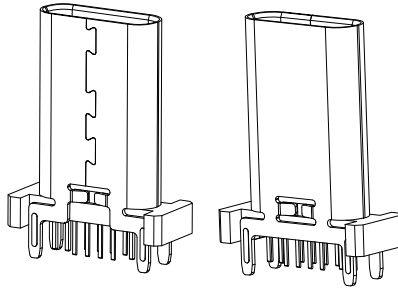
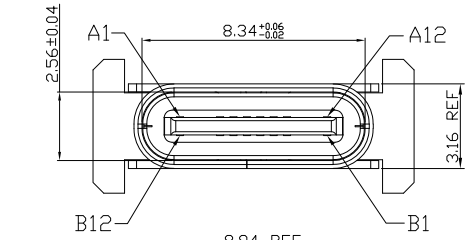

NOTES:

1.ELECTRICAL:

- 1)CURRENT RATING: 5A;
- 2)INSULATION RESISTANCE: 150V DC/100MΩ MIN;
- 3)CONTACT RESISTANCE: 40mΩ MAX;
- 4)WITHSTANDING VOLTAGE: 100V AC;
- 5)OPERATING TEMPERATURE:-40°C TO +85°C.

2.MECHANICAL:

- 1)MATING FORCE: 5N~20N
- 2)UNMATING FORCE: 8N~20N(INITIAL);
6~20N (AFTER DURABILITY TEST);
- 3)DURABILITY: 10,000 CYCLES

3.DIMENSIONS MARKED "▼"
TO BE CHECKED BY Q.C & IPQC.

USCF-162N-4BPG56

- 1:1U*
- 2:1A 3U*
- 5:1A 15U*
- 6:1A 30U*
- W:WHITE
- B:BLACK
- 1:PBT
- 2:PA6T
- 3:PA9T
- 4:LCP

A1	GND	B12	GND
A4	VBUS	B9	VBUS
A5	CC1	B8	SBU2
A6	D+	B7	Dn2
A7	D-	B6	Dp2
A8	SBU1	B5	CC2
A9	VBUS	B4	VBUS
A12	GND	B1	GND
PIN	SIGNAL NAME	PIN	SIGNAL NAME

Bill of materials:

4	MID PLATE	STAINLESS STEEL	1	
3	SHELL	STAINLESS STEEL	1	PLATED NICKEL
2	TERMINAL	COPPER ALLOY	16	PLATED GOLD
1	HOUSING & MOLDING	LCP+30%GF	1	UL94V-0
NO	PARTS	MATERIAL	QTY	FINISHING

X	±0.25	X*	±2*	UNITS	mm
X.X	±0.20			MAT'L	
X.XX	±0.15			SEE NOTE	
X.XXX	±0.10			FINISH	
				SEE NOTE	
				Q'TY	

雅安科技有限公司
ACCURATE INNOTECH INC.

TITLE: USB TYPE CF 16P 立插 针长1.80
H=15.0

PART NO.: USCF-16XN-4BPG56

DR: Ricky 2024/11/25

CHKD: Ricky 2024/11/25

APPD:

DWG NO.: AII-PG56

SCALE: 1:1

SHEET: 1/1

REV. B

CUSTOMER DRAWING

THESE DRAWINGS AND SPECIFICATIONS ARE THE PROPERTY OF ACCURATE INNOTECH AND SHALL NOT BE REPRODUCED, COPIED OR USED IN ANY MANNER WITHOUT THE PRIOR WRITTEN CONSENT OF ACCURATE INNOTECH INC.

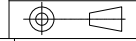



RoHS
Compliant
2002/95/EC

REV.	ECN. NO.	APPD.

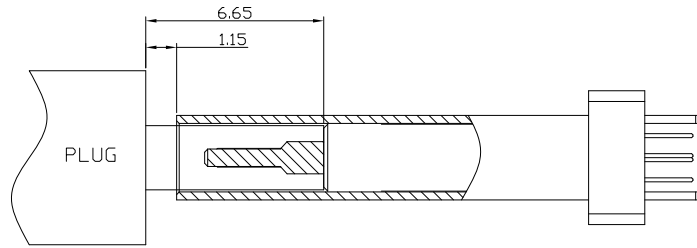
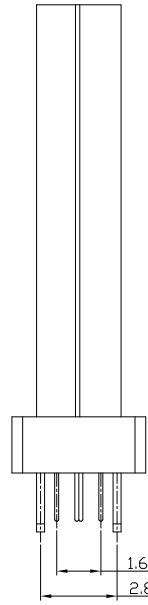
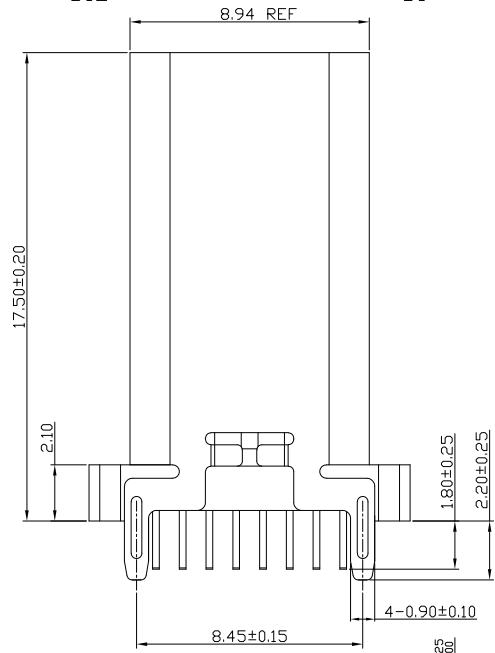
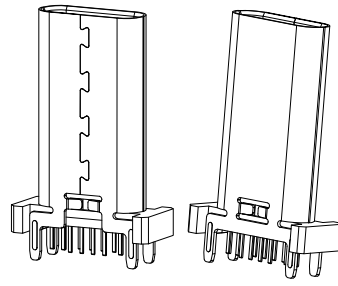
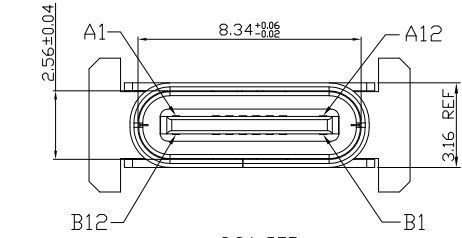

AFTER MATING

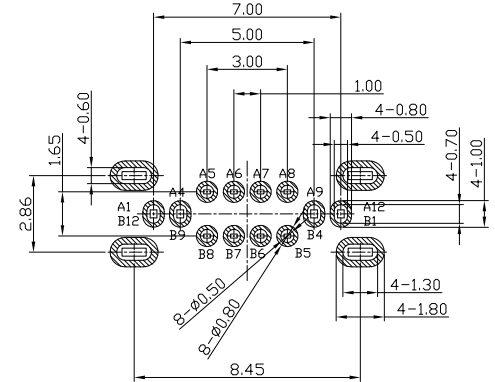

RECOMMENDED P.C.B. LAYOUT
TOLERANCE UNSPECIFIED ±0.05mm

NOTES:

1.ELECTRICAL:

- 1)CURRENT RATING: 5A;
- 2)INSULATION RESISTANCE: 150V DC/100MΩ MIN;
- 3)CONTACT RESISTANCE: 40mΩ MAX;
- 4)WITHSTANDING VOLTAGE: 100V AC;
- 5)OPERATING TEMPERATURE:-40°C TO +85°C.

2.MECHANICAL:

- 1)MATING FORCE: 5N~20N
- 2)UNMATING FORCE: 8N~20N(INITIAL);
6~20N (AFTER DURABILITY TEST);
- 3)DURABILITY: 10,000 CYCLES

3.DIMENSIONS MARKED "▼"
TO BE CHECKED BY Q.C & IPQC.

USCF-162N-4BPG57

- 1:Au 1U*
- 2:Au 3U*
- 5:Au 15U*
- 6:Au 30U*
- W:WHITE
- B:BLACK
- 1:PBT
- 2:PA6T
- 3:PA9T
- 4:LCP

A1	GND	B12	GND
A4	VBUS	B9	VBUS
A5	CC1	B8	SBU2
A6	D+	B7	Dn2
A7	D-	B6	Dp2
A8	SBU1	B5	CC2
A9	VBUS	B4	VBUS
A12	GND	B1	GND
PIN	SIGNAL NAME	PIN	SIGNAL NAME

Bill of materials:

4	MID PLATE	STAINLESS STEEL	1	
3	SHELL	STAINLESS STEEL	1	PLATED NICKEL
2	TERMINAL	COPPER ALLOY	16	PLATED GOLD
1	HOUSING & MOLDING	LCP+30%GF	1	UL94V-0
NO	PARTS	MATERIAL	QTY	FINISHING

X	±0.25	X*	±2*	UNITS	mm
X.X	±0.20			MAT'L	
X.XX	±0.15			SEE NOTE	
X.XXX	±0.10			FINISH	
				SEE NOTE	
				Q'TY	

THESE DRAWINGS AND SPECIFICATIONS ARE THE PROPERTY OF ACCURATE INNOTECH INC AND SHALL NOT BE REPRODUCED, COPIED OR USED IN ANY MANNER WITHOUT THE PRIOR WRITTEN CONSENT OF ACCURATE INNOTECH INC

雅安科技有限公司 ACCURATE INNOTECH INC.			
TITLE: USB TYPE CF 16P 立插 针长1.80 H=17.5		PART NO.: USCF-16XN-4BPG57	
DR: Ricky 2024/11/25		DWG NO.: AII-PG57	
CHKD: Ricky 2024/11/25		SCALE	SHEET
APPD:		1:1	1/1
		REV.	CUSTOMER DRAWING
		B	