

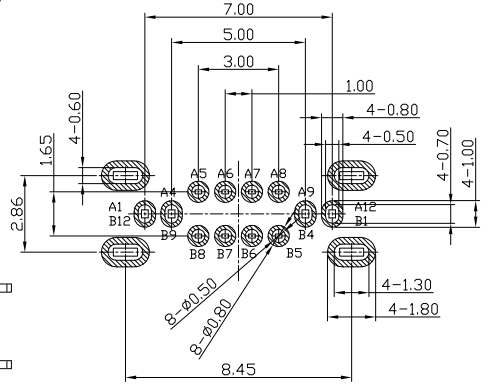

RoHS Compliant
2002/95/EC

REV.	ECN. NO.	APPD.

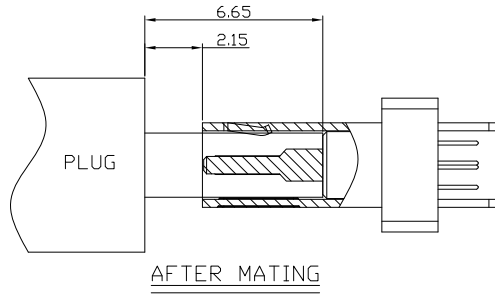
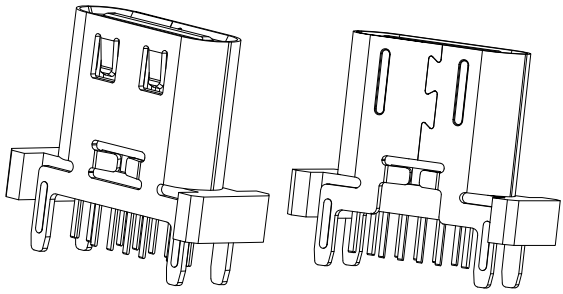
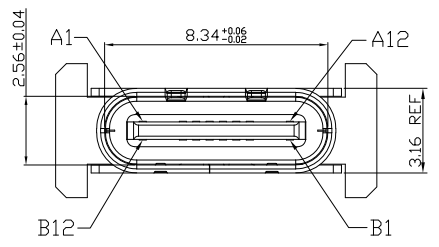

RECOMMENDED P.C.B. LAYOUT
TOLERANCE UNSPECIFIED ±0.05mm

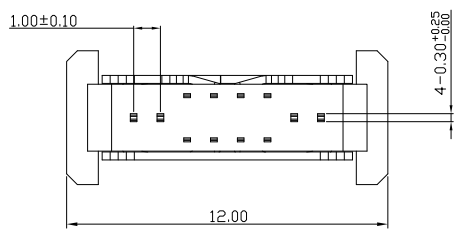
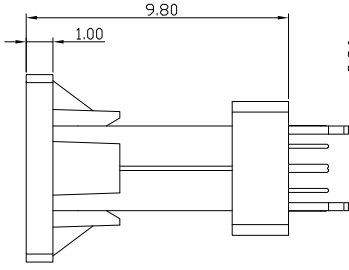
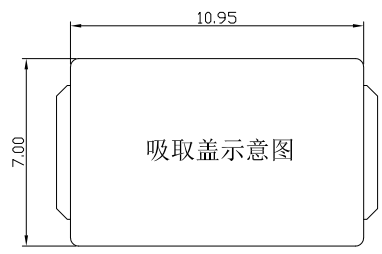
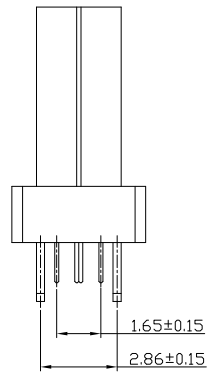
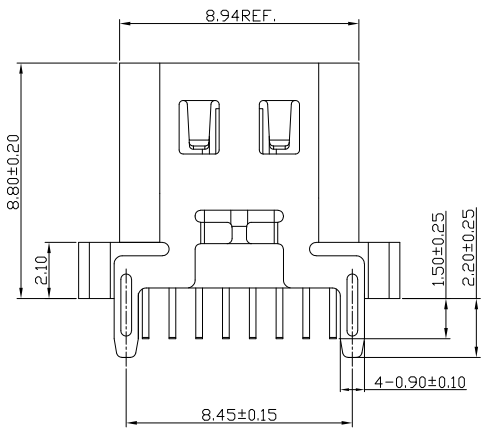

A1	GND	B12	GND
A4	VBUS	B9	VBUS
A5	CC1	B8	SBU2
A6	D+	B7	Dn2
A7	D-	B6	Dp2
A8	SBU1	B5	CC2
A9	VBUS	B4	VBUS
A12	GND	B1	GND
PIN	SIGNAL NAME	PIN	SIGNAL NAME

NOTES:

1.ELECTRICAL:

- 1)CURRENT RATING: 5A;
- 2)INSULATION RESISTANCE: 150V DC/100MΩ MIN;
- 3)CONTACT RESISTANCE: 40mΩ MAX;
- 4)WITHSTANDING VOLTAGE: 150V AC;
- 5)OPERATING TEMPERATURE:-40°C TO +85°C.

2.MECHANICAL:

- 1)MATING FORCE: 5N~20N
- 2)UNMATING FORCE: 8N~20N(INITIAL);
6~20N (AFTER DURABILITY TEST);
- 3)DURABILITY: 10,000 CYCLES

3.DIMENSIONS MARKED "▼"
TO BE CHECKED BY Q.C & IPQC.

USCF-162N-4BPG516

- 1: Au 1U"
- 2: Au 3U"
- 5: Au 15U"
- 6: Au 30U"
- W: WHITE
- B: BLACK
- 1: PBT
- 2: PA6T
- 3: PA9T
- 4: LCP

Bill of materials:

4	MID PLATE	STAINLESS STEEL	1	
3	SHELL	STAINLESS STEEL	1	PLATED NICKEL
2	TERMINAL	COPPER ALLOY	16	PLATED GOLD
1	HOUSING & MOLDING	LCP+30%GF	1	UL94V-0
NO	PARTS	MATERIAL	QTY	FINISHING

X	±0.25	X*	±2°	UNITS	mm
X.X	±0.20			MAT'L	
X.XX	±0.15			SEE NOTE	
X.XXX	±0.10			FINISH	
				SEE NOTE	
				Q'TY	

雅安科技有限公司
ACCURATE INNOTECH INC.

TITLE: USB TYPE CF 16P 立插 外壳带弹带凸筋 针长1.50 H=8.8

PART NO.: USCF-16XN-4BPG516

DR: Ricky 2024/11/08

CHKD: Ricky 2024/11/08

APPD:

DWG NO.: AII-PG516

SCALE: 1:1

SHEET: 1/1

REV. B

CUSTOMER DRAWING

THESE DRAWINGS AND SPECIFICATIONS ARE THE PROPERTY OF ACCURATE INNOTECH AND SHALL NOT BE REPRODUCED, COPIED OR USED IN ANY MANNER WITHOUT THE PRIOR WRITTEN CONSENT OF ACCURATE INNOTECH INC

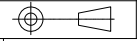



RoHS
Compliant
2002/95/EC

REV.	ECN. NO.	APPD.

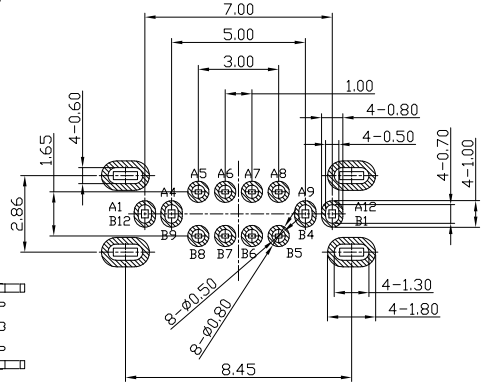
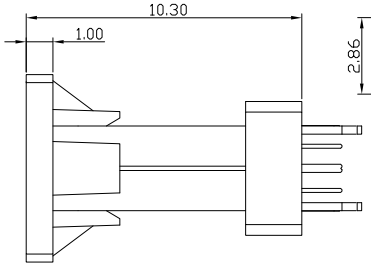
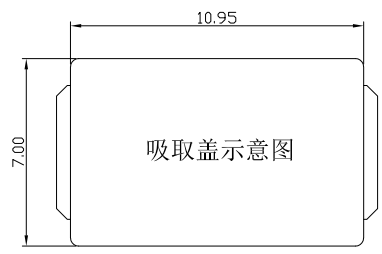
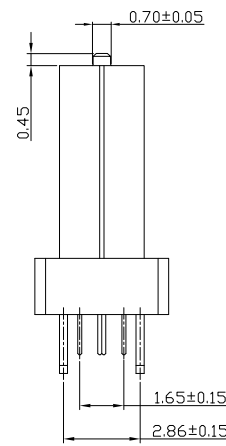
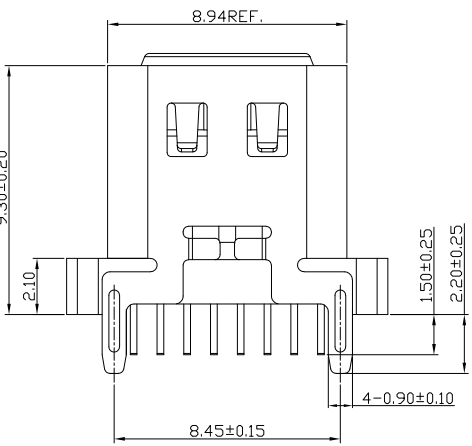
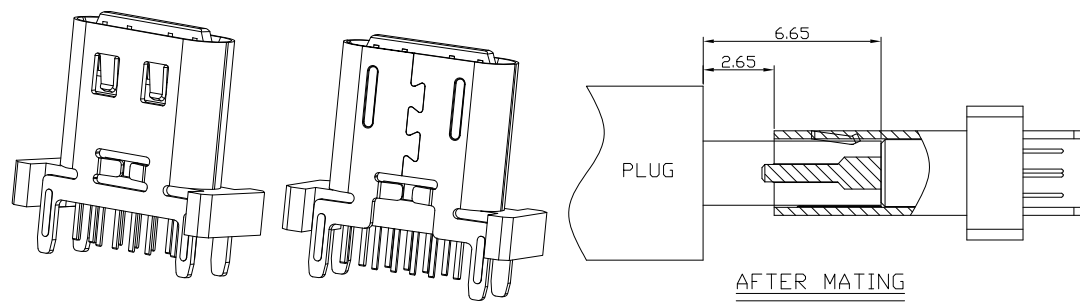
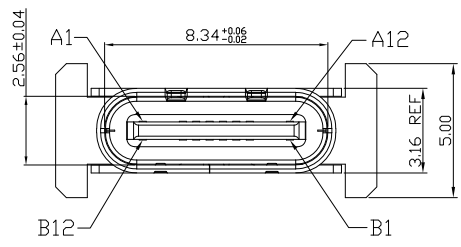

RECOMMENDED P.C.B. LAYOUT
TOLERANCE UNSPECIFIED ±0.05mm

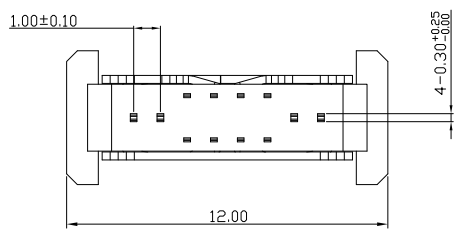

NOTES:

1.ELECTRICAL:

- 1)CURRENT RATING: 5A;
- 2)INSULATION RESISTANCE: 150V DC/100MΩ MIN;
- 3)CONTACT RESISTANCE: 40mΩ MAX;
- 4)WITHSTANDING VOLTAGE: 150V AC;
- 5)OPERATING TEMPERATURE:-40°C TO +85°C.

2.MECHANICAL:

- 1)MATING FORCE: 5N~20N
- 2)UNMATING FORCE: 8N~20N(INITIAL);
6~20N (AFTER DURABILITY TEST);
- 3)DURABILITY: 10,000 CYCLES

3.DIMENSIONS MARKED "▼"
TO BE CHECKED BY Q.C & IPQC.

USCF-162N-4BPG513

- 1: Au 1U"
- 2: Au 3U"
- 5: Au 15U"
- 6: Au 30U"
- W: WHITE
- B: BLACK
- 1: PBT
- 2: PA6T
- 3: PA9T
- 4: LCP

A1	GND	B12	GND
A4	VBUS	B9	VBUS
A5	CC1	B8	SBU2
A6	D+	B7	Dn2
A7	D-	B6	Dp2
A8	SBU1	B5	CC2
A9	VBUS	B4	VBUS
A12	GND	B1	GND
PIN	SIGNAL NAME	PIN	SIGNAL NAME

Bill of materials:

4	MID PLATE	STAINLESS STEEL	1	
3	SHELL	STAINLESS STEEL	1	PLATED NICKEL
2	TERMINAL	COPPER ALLOY	16	PLATED GOLD
1	HOUSING & MOLDING	LCP+30%GF	1	UL94V-0
NO	PARTS	MATERIAL	QTY	FINISHING

X	±0.25	X*	±2°	UNITS	mm
X.X	±0.20			MAT'L	
X.XX	±0.15			SEE NOTE	
X.XXX	±0.10			FINISH	
				SEE NOTE	
				Q'TY	

雅安科技有限公司
ACCURATE INNOTECH INC.

TITLE: USB TYPE CF 16P 立插 外壳带弹带凸筋 针长1.50 舌片外露 l=9.3

PART NO.: USCF-162N-4BPG513

DR: Ricky 2024/11/08

CHKD: Ricky 2024/11/08

APPD:

DWG NO.: AII-PG513

SCALE: 1:1

SHEET: 1/1

REV.: B

CUSTOMER DRAWING

THESE DRAWINGS AND SPECIFICATIONS ARE THE PROPERTY OF ACCURATE INNOTECH AND SHALL NOT BE REPRODUCED, COPIED OR USED IN ANY MANNER WITHOUT THE PRIOR WRITTEN CONSENT OF ACCURATE INNOTECH INC.

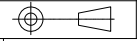



RoHS
Compliant
2002/95/EC

REV.	ECN. NO.	APPD.

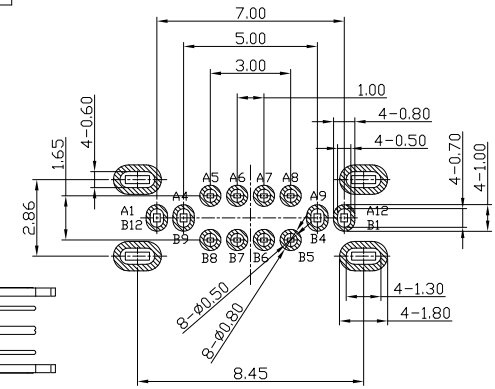
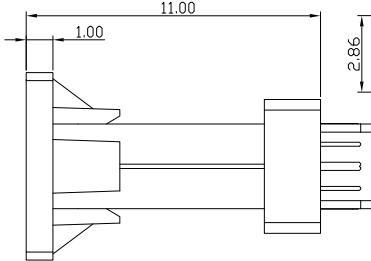
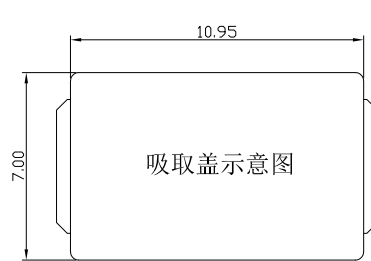
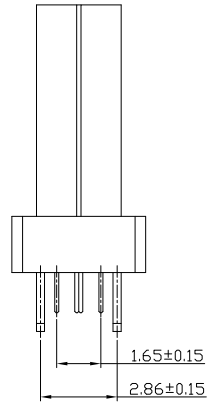
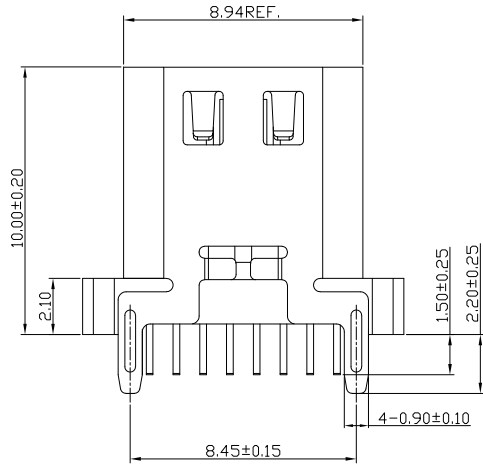
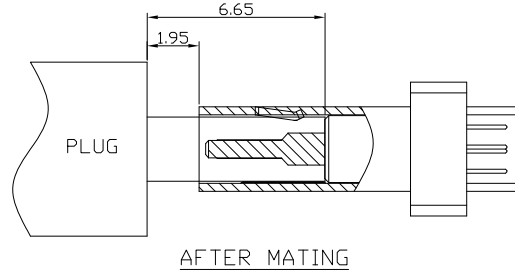
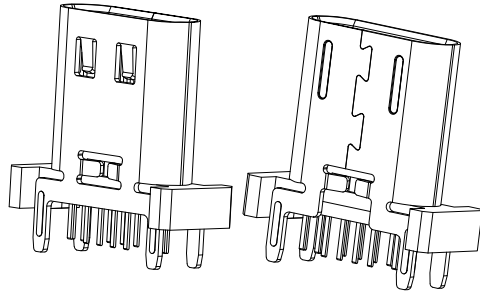
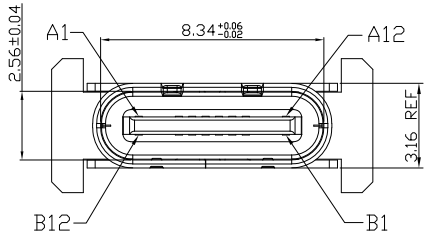

RECOMMENDED P.C.B. LAYOUT
TOLERANCE UNSPECIFIED ±0.05mm

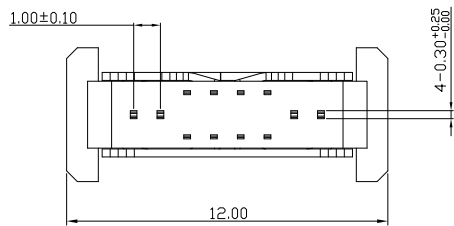

A1	GND	B12	GND
A4	VBUS	B9	VBUS
A5	CC1	B8	SBU2
A6	D+	B7	Dn2
A7	D-	B6	Dp2
A8	SBU1	B5	CC2
A9	VBUS	B4	VBUS
A12	GND	B1	GND
PIN	SIGNAL NAME	PIN	SIGNAL NAME

NOTES:

1.ELECTRICAL:

- CURRENT RATING: 5A;
- INSULATION RESISTANCE: 150V DC/100MΩ MIN;
- CONTACT RESISTANCE: 40mΩ MAX;
- WITHSTANDING VOLTAGE: 150V AC;
- OPERATING TEMPERATURE: -40°C TO +85°C.

2.MECHANICAL:

- MATING FORCE: 5N~20N
- UNMATING FORCE: 8N~20N(INITIAL);
6~20N (AFTER DURABILITY TEST);
- DURABILITY: 10,000 CYCLES

3.DIMENSIONS MARKED "▼"
TO BE CHECKED BY Q.C & IPQC.

USCF-162N-4BPG514

- 1: Au 1U"
- 2: Au 3U"
- 5: Au 15U"
- 6: Au 30U"
- W: WHITE
- B: BLACK
- 1: PBT
- 2: PA6T
- 3: PA9T
- 4: LCP

Bill of materials:

4	MID PLATE	STAINLESS STEEL	1		X ±0.25	X* ±2°	UNITS mm	雅安科技有限公司 ACCURATE INNOTECH INC.	TITLE: USB TYPE CF 16P 立插 外壳带弹 带凸筋 针长1.50 H=10.0	PART NO.: USCF-16XN-4BPG514		
3	SHELL	STAINLESS STEEL	1	PLATED NICKEL	X.X ±0.20		MAT'L					
2	TERMINAL	COPPER ALLOY	16	PLATED GOLD	X.XX ±0.15		SEE NOTE					
1	HOUSING & MOLDING	LCP+30%GF	1	UL94V-0	X.XXX ±0.10		FINISH					
NO	PARTS	MATERIAL	QTY	FINISHING	THESE DRAWINGS AND SPECIFICATIONS ARE THE PROPERTY OF ACCURATE INNOTECH INC. AND SHALL NOT BE REPRODUCED, COPIED OR USED IN ANY MANNER WITHOUT THE PRIOR WRITTEN CONSENT OF ACCURATE INNOTECH INC.		Q'TY	DR: Ricky 2024/11/08	DWG NO.: AII-PG514			
								APPD: Ricky 2024/11/08	SCALE 1:1	SHEET 1/1	REV. B	CUSTOMER DRAWING



RoHS Compliant
2002/95/EC

REV.	ECN. NO.	APPD.

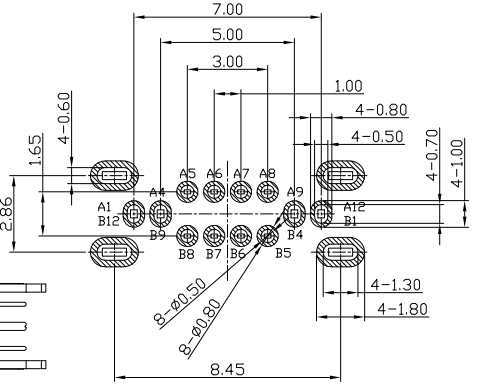
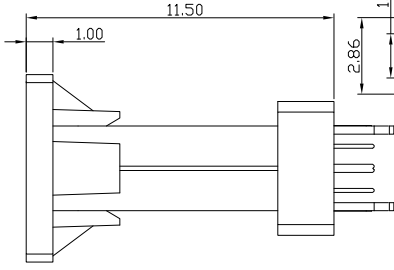
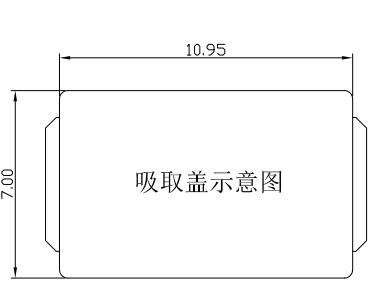
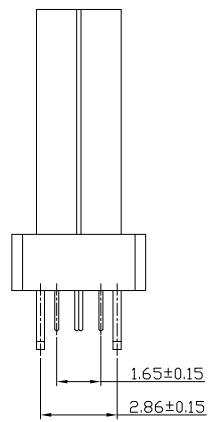
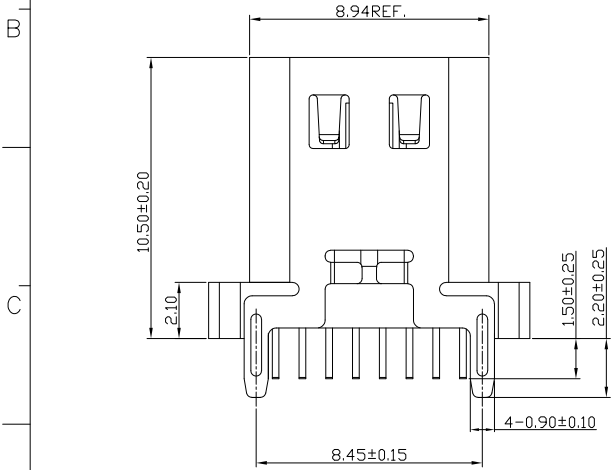
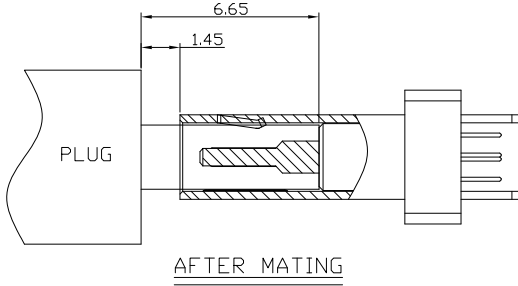
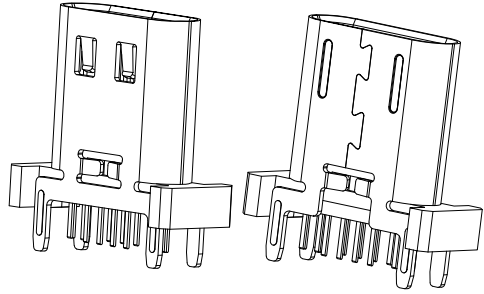
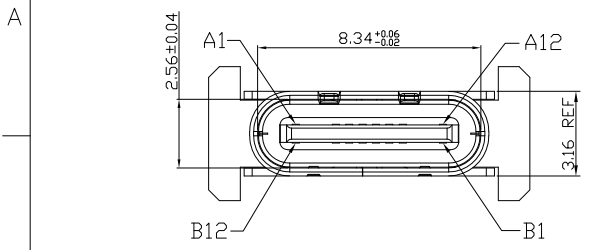

RECOMMENDED P.C.B. LAYOUT
TOLERANCE UNSPECIFIED ±0.05mm

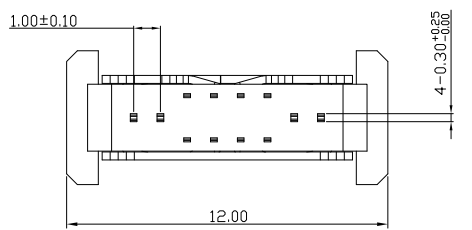

A1	GND	B12	GND
A4	VBUS	B9	VBUS
A5	CC1	B8	SBU2
A6	D+	B7	Dn2
A7	D-	B6	Dp2
A8	SBU1	B5	CC2
A9	VBUS	B4	VBUS
A12	GND	B1	GND
PIN	SIGNAL NAME	PIN	SIGNAL NAME

NOTES:

- ELECTRICAL:
 - CURRENT RATING: 5A;
 - INSULATION RESISTANCE: 150V DC/100MΩ MIN;
 - CONTACT RESISTANCE: 40mΩ MAX;
 - WITHSTANDING VOLTAGE: 150V AC;
 - OPERATING TEMPERATURE: -40°C TO +85°C.
- MECHANICAL:
 - MATING FORCE: 5N~20N
 - UNMATING FORCE: 8N~20N(INITIAL); 6~20N (AFTER DURABILITY TEST);
 - DURABILITY: 10,000 CYCLES
- DIMENSIONS MARKED "▼" TO BE CHECKED BY Q.C & IPQC.

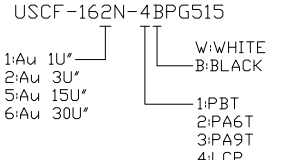

Bill of materials:

4	MID PLATE	STAINLESS STEEL	1	
3	SHELL	STAINLESS STEEL	1	PLATED NICKEL
2	TERMINAL	COPPER ALLOY	16	PLATED GOLD
1	HOUSING & MOLDING	LCP+30%GF	1	UL94V-0
NO	PARTS	MATERIAL	QTY	FINISHING

X	±0.25	X*	±2°	UNITS	mm
X.X	±0.20			MAT'L	
X.XX	±0.15			SEE NOTE	
X.XXX	±0.10			FINISH	
				SEE NOTE	
				Q'TY	

雅安科技有限公司
ACCURATE INNOTECH INC.

TITLE: USB TYPE CF 16P 立插 外壳带弹带凸筋 针长1.50 H=10.5

PART NO.: USCF-16XN-4BPG515

DR: Ricky 2024/11/08

CHKD: Ricky 2024/11/08

APPD:

DWG NO.: AII-PG515

SCALE: 1:1

SHEET: 1/1

REV.: B

CUSTOMER DRAWING

THESE DRAWINGS AND SPECIFICATIONS ARE THE PROPERTY OF ACCURATE INNOTECH AND SHALL NOT BE REPRODUCED, COPIED OR USED IN ANY MANNER WITHOUT THE PRIOR WRITTEN CONSENT OF ACCURATE INNOTECH INC.

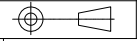



RoHS
Compliant
2002/95/EC

REV.	ECN.	NO.	APPD.

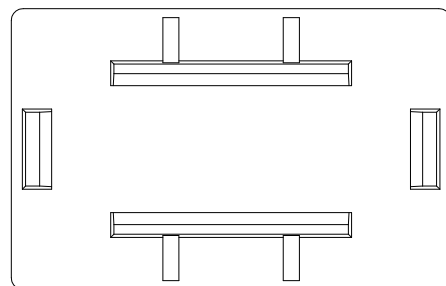
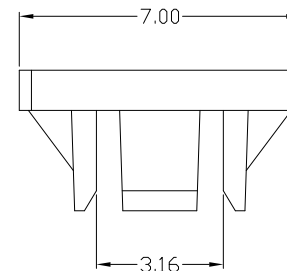
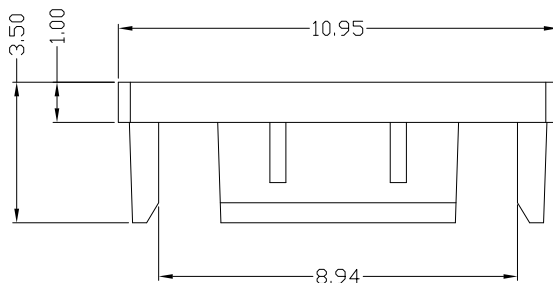
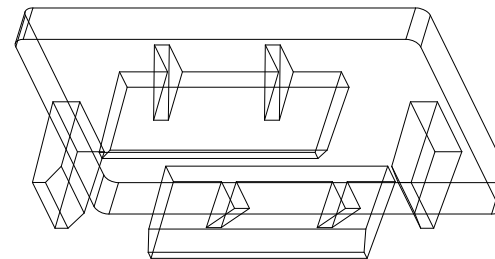
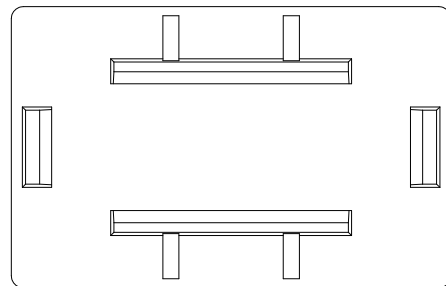

NOTES:
1.外观不允许有压伤, 脏污, 模痕等不良现象
2.非功能处毛边最大0.03MM.

Bill of materials:

NO	PARTS	MATERIAL	QTY	FINISHING									
1	CAP	LCP+30%GF	1	UL94V-0	X. ±0.50	X.° ±2°	UNITS mm	雅安科技有限公司 ACCURATE INNOTECH INC.					
					.X ±0.10	.X° ±1°	MAT'L	TITLE: USB TYPE CF 14P& 16P立式 插板&贴板 CAP		PART NO.: USCF-1XXN-4BXG5XX-C1			
					.XX ±0.05		SEE NOTE	DR: <i>Ricky</i> 2021/07/14		DWG NO.: AII-XG5XX-C1			
					.XXX ±0.02		FINISH	CHKD: <i>Ricky</i> 2021/07/14		SCALE SHEET REV. CUSTOMER			
					THESE DRAWINGS AND SPECIFICATIONS ARE THE PROPERTY OF ACCURATE INNOTECH INC. AND SHALL NOT BE REPRODUCED, COPIED OR USED IN ANY MANNER WITHOUT THE PRIOR WRITTEN CONSENT OF ACCURATE INNOTECH INC.		SEE NOTE	APPD:		1:1	1/1	B	DRAWING

