

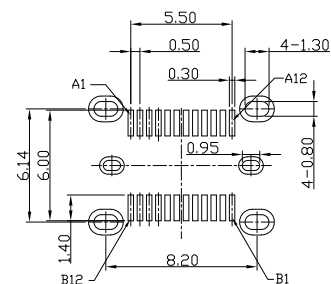

RoHS
Compliant
2002/95/EC

REV.	ECN.	NO.	APPD.

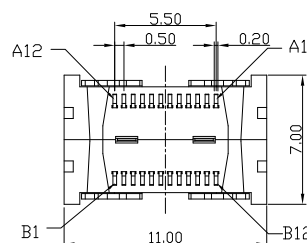
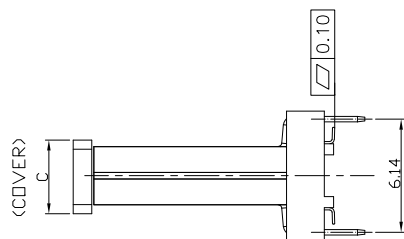
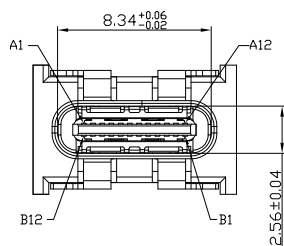
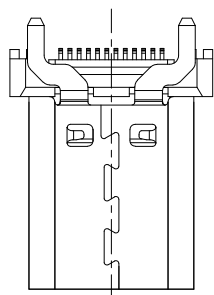

RECOMMEND P.C.B LAYOUT (COMPONENT SIDE)

TOLERANCE FOR PCB LAYOUT IS ± 0.05
KEEP OUT AREA

USB TYPE-C FULL-FEATURED RECEPTACLE INTERFACE PIN ASSIGNMENTS

PIN	Signal Name	Description	PIN	Signal Name	Description
A1	GND	Ground return	B12	GND	Ground return
A2	SSTxp1	Positive half of first SuperSpeed TX differential pair	B11	SSTxp1	Positive half of first SuperSpeed RX differential pair
A3	SSTxn1	Negative half of first SuperSpeed TX differential pair	B10	SSTxp1	Negative half of first SuperSpeed RX differential pair
A4	Vbus	Bus Power	B9	Vbus	Bus Power
A5	CC1	Configuration Channel	B8	SBU2	Sideband Use (SBU)
A6	Dp1	Positive half of the USB 2.0 differential pair-Position 1	B7	Dn2	Negative half of the USB 2.0 differential pair-Position 2
A7	Dn1	Negative half of the USB 2.0 differential pair-Position 1	B6	Dp2	Positive half of the USB 2.0 differential pair-Position 2
A8	SBU1	Sideband Use(SBU)	B5	CC2	Configuration Channel
A9	Vbus	Bus Power	B4	Vbus	Bus Power
A10	SSRx2	Negative half of second SuperSpeed RX differential pair	B3	SSRx2	Negative half of second SuperSpeed TX differential pair
A11	SSRx2	Positive half of second SuperSpeed RX differential pair	B2	SSRx2	Positive half of second SuperSpeed TX differential pair
A12	GND	Ground return	B1	GND	Ground return

NOTES:

1.ELECTRICAL:

- 1)CURRENT RATING: 5A FOR VBUS PIN; 1.25A FOR VCONN PIN.
- 2)INSULATION RESISTANCE: 100MΩ MIN
- 3)CONTACT RESISTANCE: 40mΩ MAX,;
- 4)WITHSTANDING VOLTAGE: 100V AC FOR 1 MINUTE;
- 5)OPERATING TEMPERATURE:-25°C TO +85°C.

2.MECHANICAL:

- 1)MATING FORCE: 5N~20N.
- 2)UNMATED FORCE: 8N~20N (<0~1000 CYCLE); 6N~20N(1001~10000 CYCLE);
- 3)DURABILITY: 10,000 CYCLES;

3.DIMENSIONS MARKED "▼"
TO BE CHECKED BY Q.C & IPQC.

4.PART NO.

USCF-241N-4BQW0X

SEE CHART
W/WHITE
B/BLACK

1Au 1U'
2Au 3U'
5Au 15U'
6Au 30U'

1PBT
2PA6T
3PA9T
4LCP

P/N:	DIM A	DIM C
USCF-241N-4BQW02	12.00	4.50
USCF-241N-4BQW03	13.00	4.00

NO	PARTS	MATERIAL	QTY	FINISHING	UNITS	mm
6	COVER	LCP+30%GF	1	UL94V-0	.X	±0.30
5	INSULATOR	LCP+30%GF	1	UL94V-0	.XX	±0.20
4	CONTACT	COPPER ALLOY	24	PLATED GOLD/TIN	.XXX	±0.10
3	MID PLATD	STAINLESS STEEL	1			
2	GND PLATE	STAINLESS STEEL	1			
1	SHELL	STAINLESS STEEL	1	PLATED NICKEL		
NO	PARTS	MATERIAL	QTY	FINISHING		

THESE DRAWINGS AND SPECIFICATIONS ARE THE PROPERTY OF ACCURATE INNOTECH INC AND SHALL NOT BE REPRODUCED, COPIED OR USED IN ANY MANNER WITHOUT THE PRIOR WRITTEN CONSENT OF ACCURATE INNOTECH INC

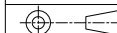

雅安科技有限公司 ACCURATE INNOTECH INC.			
TITLE: USB 3.1 TYPE CF 24P 直立式 双排SMT L=12&13mm		PART NO.: USCF-24XN-4BQW02&3	
DR: <i>Ricky</i> 2024/11/15		DWG NO.: AII-QW02&3	
CHKD: <i>Ricky</i> 2024/11/15		SCALE	SHEET
APPD:	REV. B	1:1	1/1
		CUSTOMER DRAWING	



RoHS
Compliant
2002/95/EC

REV.	ECN.	NO.	APPD.

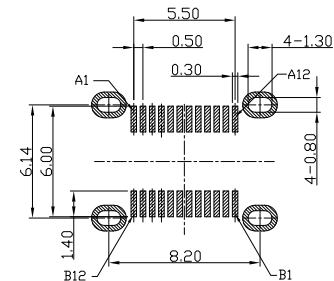
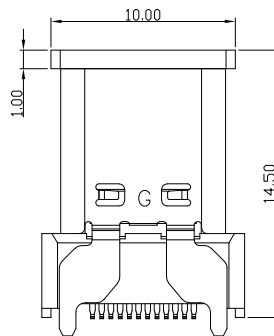
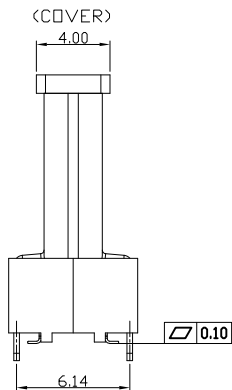
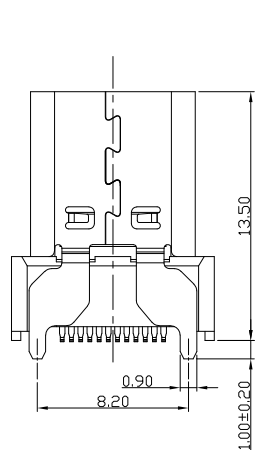
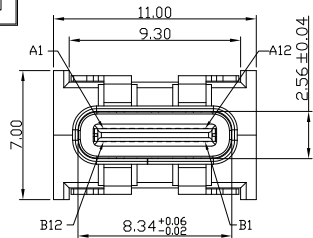

RECOMMEND P.C.B LAYOUT (COMPONENT SIDE)
TOLERANCE FOR PCB LAYOUT IS ± 0.05

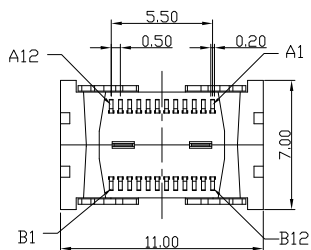

USB TYPE-C FULL-FEATURED RECEPTACLE INTERFACE PIN ASSIGNMENTS

PIN	Signal Name	Description	PIN	Signal Name	Description
A1	GND	Ground return	B12	GND	Ground return
A2	SSTxp1	Positive half of first Super-Speed TX differential pair	B11	SSTxp1	Positive half of first Super-Speed RX differential pair
A3	SSTxm1	Negative half of first Super-Speed TX differential pair	B10	SSTxm1	Negative half of first Super-Speed RX differential pair
A4	Vbus	Bus Power	B9	Vbus	Bus Power
A5	CC1	Configuration Channel	B8	SBU2	Sideband Use (SBU)
A6	Dp1	Positive half of the USB 2.0 differential pair-Position 1	B7	Dm2	Negative half of the USB 2.0 differential pair-Position 2
A7	Dm1	Negative half of the USB 2.0 differential pair-Position 1	B6	Dp2	Positive half of the USB 2.0 differential pair-Position 2
A8	SBU1	Sideband Use (SBU)	B5	CC2	Configuration Channel
A9	Vbus	Bus Power	B4	Vbus	Bus Power
A10	SSRm2	Negative half of second Super-Speed RX differential pair	B3	SSRp2	Negative half of second Super-Speed TX differential pair
A11	SSRp2	Positive half of second Super-Speed RX differential pair	B2	SSRm2	Positive half of second Super-Speed TX differential pair
A12	GND	Ground return	B1	GND	Ground return

NOTES:

1.ELECTRICAL:

- CURRENT RATING: 5A FOR VBUS PIN; 1.25A FOR VCONN PIN.
- INSULATION RESISTANCE: 100MΩ MIN
- CONTACT RESISTANCE: 40mΩ MAX,;
- WITHSTANDING VOLTAGE: 100V AC FOR 1 MINUTE;
- OPERATING TEMPERATURE: -25°C TO +85°C.

2.MECHANICAL:

- MATING FORCE: 5N~20N.
- UNMATED FORCE: 8N~20N (<0~1000 CYCLE); 6N~20N(1001~10000 CYCLE);
- DURABILITY: 10,000 CYCLES;

3.DIMENSIONS MARKED "▼"
TO BE CHECKED BY Q.C & IPQC.

4.PART NO.

USCF-241N-4BQW04

W:WHITE
B:BLACK

1Au 1U'
2Au 3U'
5Au 15U'
6Au 30U'

1PBT
2PA6T
3PA9T
4LCP

6	COVER	LCP+30%GF	1	UL94V-0	.X	±0.30	.X'	±1'	UNITS	mm
5	INSULATOR	LCP+30%GF	1	UL94V-0	.XX	±0.20	.XX'	±0.5'	MAT'L	
4	CONTACT	COPPER ALLOY	24	PLATED GOLD/TIN	.XXX	±0.10	.XXX'	±0.2'	SEE NOTE	
3	MID PLATD	STAINLESS STEEL	1						FINISH	
2	GND PLATE	STAINLESS STEEL	1						SEE NOTE	
1	SHELL	STAINLESS STEEL	1	PLATED NICKEL					Q'TY	
NO	PARTS	MATERIAL	QTY	FINISHING						

THESE DRAWINGS AND SPECIFICATIONS ARE THE PROPERTY OF ACCURATE INNOTECH INC AND SHALL NOT BE REPRODUCED, COPIED OR USED IN ANY MANNER WITHOUT THE PRIOR WRITTEN CONSENT OF ACCURATE INNOTECH INC

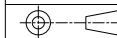

雅安科技有限公司 ACCURATE INNOTECH INC.			
TITLE: USB 3.1 TYPE CF 24P 直立式 双排SMT L=13.5mm		PART NO.: USCF-24XN-4BQW04	
DR: <i>Ricky</i> 2024/11/15		DWG NO.: AII-QW04	
CHKD: <i>Ricky</i> 2024/11/15		SCALE	SHEET
APPD:	REV. B	1:1	1/1
		REV. B	CUSTOMER DRAWING