

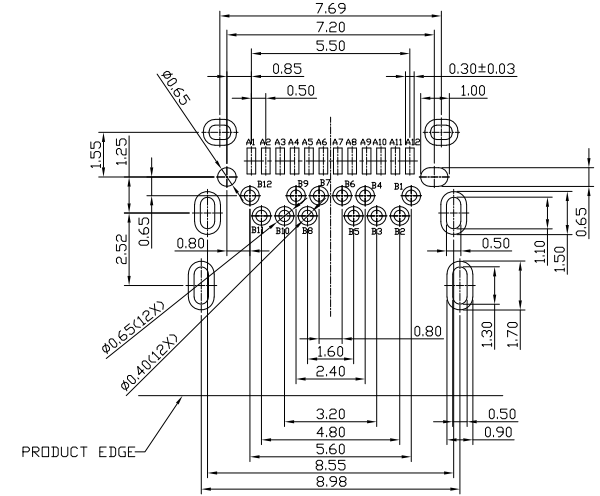

RoHS Compliant
2002/95/EC

REV.	ECN.	NO.	APPD.

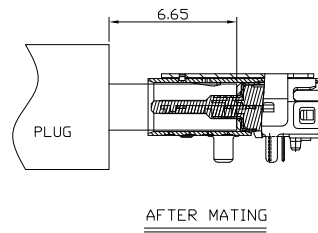
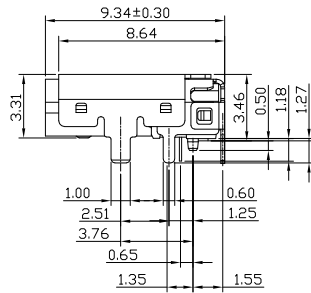
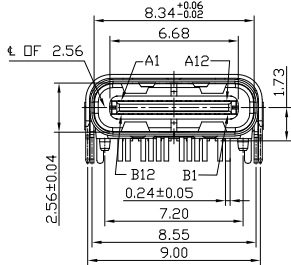
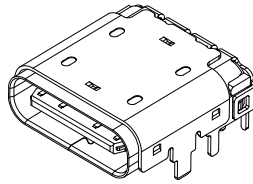
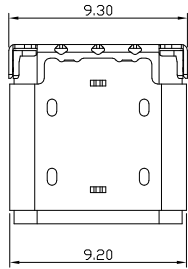

SCALE 1.5:1

RECOMMENDED PCB LAYOUT(TOP VIEW)
THICKNESS 1.0 MM;DEFAULT TOLERANCE:±0.05

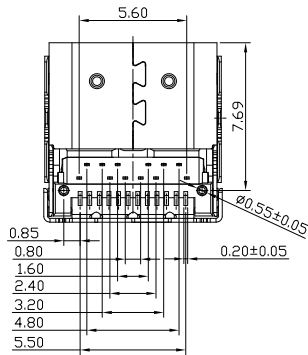

USB TYPE-C PIN ASSIGNMENTS

PIN NUMBER	SIGNAL NAME	PIN NUMBER	SIGNAL NAME
A1	GND	B12	GND
A2	SSTXp1	B11	SSRXp1
A3	SSTXn1	B10	SSRXn1
A4	Vbus	B9	Vbus
A5	CC1	B8	SBU2
A6	Dp1	B7	Dn2
A7	Dn1	B6	Dp2
A8	SBU1	B5	CC2
A9	Vbus	B4	Vbus
A10	SSRXn2	B3	SSTXn2
A11	SSRXp2	B2	SSTXp2
A12	GND	B1	GND

NOTES:

1.ELECTRICAL:

- CURRENT VOLTAGE RATING: 3.0A 5.0V
- INSULATION RESISTANCE: 100MΩ MIN;
- CONTACT RESISTANCE:
LLCR:VBUS & GND PINS AND OTHER PINS: 40mΩ/PIN MAX.
SHIELD:50mΩ/MAX.
LLCR MAX.CHANGE OF ALL PINS: 10mΩ.
- WITHSTANDING VOLTAGE: 100V AC FOR 1 MINUTE.
- OPERATING TEMPERATURE:-25°C TO +85°C.

2.Mechanical:

- Mating Force: 5N~20N
- Unmating Force: 8N~20N
- Durability: 10,000 cycles

3.DIMENSIONS MARKED "▼"
TO BE CHECKED BY Q.C & IPQC.

4.PART NO.

USCF-242N-3BVS29

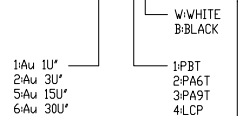

6	COVER	STAINLESS STEEL	1	PLATED NICKEL	x.x ±0.30	x.' ±10'	UNITS mm
5	FRONT SHELL	STAINLESS STEEL	1	PLATED NICKEL	.xx ±0.20	.x' ±8'	MAT'L
4	SPRING	STAINLESS STEEL	1		.xxx ±0.10	.xx' ±5'	SEE NOTE
3	MID PLATE	STAINLESS STEEL	1				FINISH
2	CONTACT	COPPER ALLOY	24	PLATED GOLD/NICKEL			SEE NOTE
1	HOUSING	PA9T/LCP+30%GF	1	UL94V-0			Q'TY
NO	PARTS	MATERIAL	QTY	FINISHING			

THESE DRAWINGS AND SPECIFICATIONS ARE THE PROPERTY OF ACCURATE INNOTECH INC AND SHALL NOT BE REPRODUCED, COPIED OR USED IN ANY MANNER WITHOUT THE PRIOR WRITTEN CONSENT OF ACCURATE INNOTECH INC

雅安科技有限公司
ACCURATE INNOTECH INC.

TITLE: USB C F TYPE 前插后贴
带上盖外壳有缺口

PART NO.: USCF-242N-3BVS29

DR: Ricky 2022/05/06

DWG NO.: AII-VS29

CHKD: Ricky 2022/05/06

APPD:

SCALE 1:1 SHEET 1/1 REV. B CUSTOMER DRAWING