

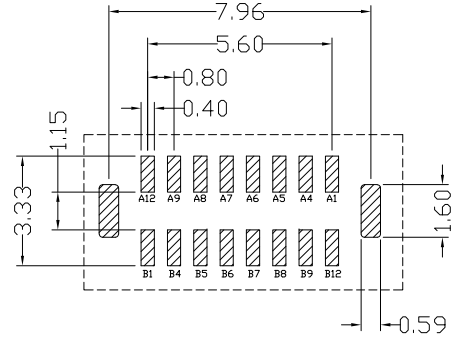

RoHS
Compliant
2002/95/EC

REV.	ECN. NO.	APPD.

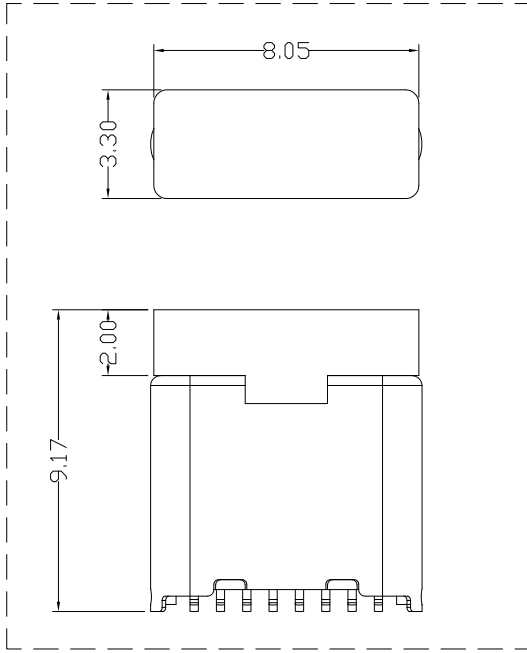
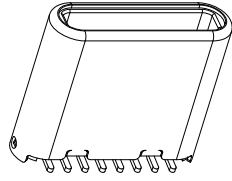
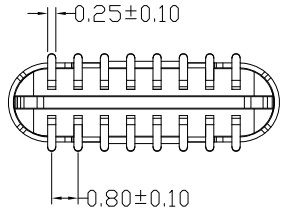

RECOMMENDED P.C.B. LAYOUT
TOLERANCE UNSPECIFIED ±0.05mm

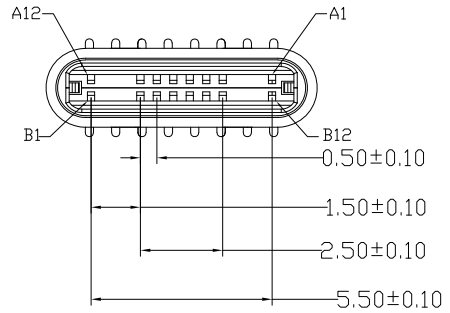
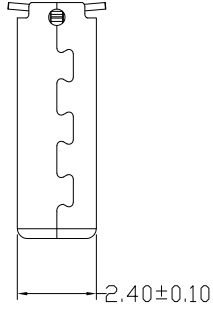
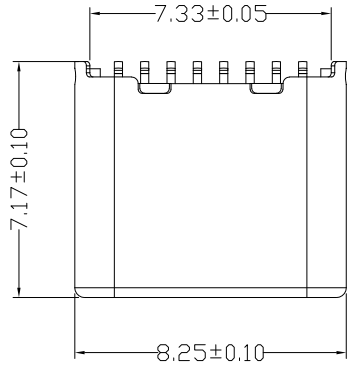
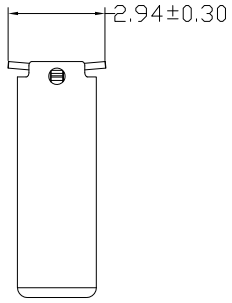

Type c Pin Assignments

A1	GND	B12	GND
A4	VBUS	B9	VBUS
A5	CC1	B8	SBU2
A6	DP1	B7	DN2
A7	DN1	B6	DP2
A8	SBU1	B5	CC2
A9	VBUS	B4	VBUS
A12	GND	B1	GND
PIN	SIGNAL NAME	PIN	SIGNAL NAME

- NOTES:
 1.ELECTRICAL:
 1>VOLTAGE CURRENT RATING: 2A,5V DC(RMS)
 2>INSULATION RESISTANCE: 100MΩ MIN;
 3>CONTACT RESISTANCE: 30mΩ MAX;
 4>WITHSTANDING VOLTAGE: 100V AC;
 5>OPERATING TEMPERATURE:-25°C TO +80°C.
 2.MECHANICAL:
 1>MATING FORCE: 20N MAX.
 2>UNMATED FORCE: 6N MIN.
 3.DIMENSIONS MARKED "▼"
 TO BE CHECKED BY Q.C & IPQC.

4.PART NO.
 USCM-161N-4BQU50
 W:WHITE
 B:BLACK
 1:PA1
 2:PA6T
 3:PA9T
 4:LCP
 1:1Au 10"
 2:1Au 30"
 5:1Au 15u"
 6:1Au 300"

5					.X ±0.30	.X' ±5'	UNITS mm
4	HOOK	STAINLESS STEEL	1		.XX ±0.20	.XX' ±2'	MAT'L
3	SHELL	STAINLESS STEEL	1	PLATED NICKEL	.XXX ±0.10	.XXX'	SEE NOTE
2	TERMINAL	COPPER ALLOY	16	PLATED GOLD/TIN			FINISH
1	HOUSING	LCP+30%GF	1	UL94V-0			SEE NOTE
NO	PARTS	MATERIAL	QTY	FINISHING			Q'TY

THESE DRAWINGS AND SPECIFICATIONS ARE THE PROPERTY OF ACCURATE INNOTECH INC AND SHALL NOT BE REPRODUCED, COPIED OR USED IN ANY MANNER WITHOUT THE PRIOR WRITTEN CONSENT OF ACCURATE INNOTECH INC

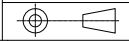

雅安科技有限公司
 ACCURATE INNOTECH INC.

TITLE: USB TYPE CM 16P 侧脚 7.2 SMT
 PART NO.: USCM-16XN-4BQU50

DR: Ricky 2024/02/15
 DWG NO.: AII-QU50

CHKD: Ricky 2024/02/15
 SCALE: 1:1 SHEET: 1/1 REV: B CUSTOMER DRAWING

APPD: