



RoHS
Compliant
2002/95/EC



Halogen Free

REV.	ECN. NO.	APPD.

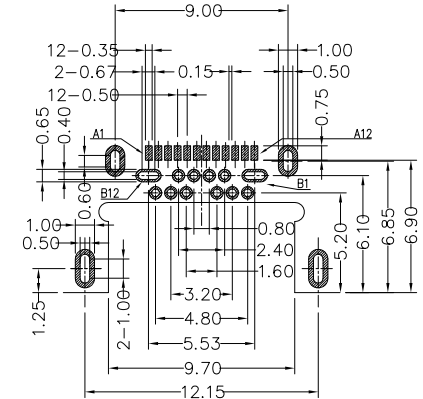
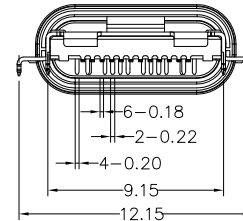
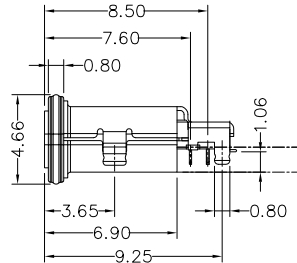
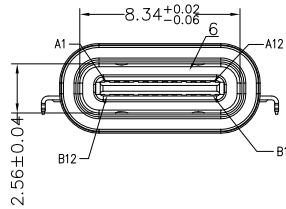
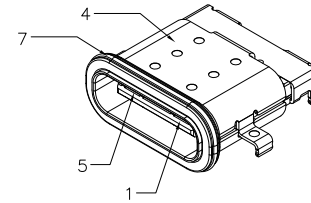
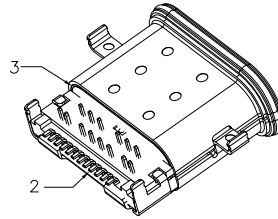
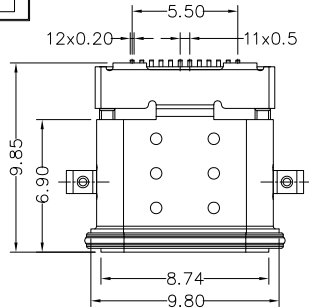

RECOMMEND PCB LAYOUT
TOL=±0.05

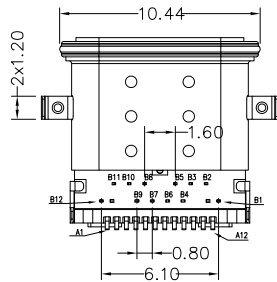

A1	GND	B12	GND
A2	SSTXP1	B11	SSRXP1
A3	SSTXN1	B10	SSRXN1
A4	VBUS	B9	VBUS
A5	CC1	B8	SBU2
A6	DP1	B7	DN2
A7	DN1	B6	DP2
A8	SBU1	B5	CC2
A9	VBUS	B4	VBUS
A10	SSRXN2	B3	SSTXN2
A11	SSRXP2	B2	SSTXP2
A12	GND	B1	GND
PIN	SIGNAL NAME	PIN	SIGNAL NAME

NOTES:

1.ELECTRICAL:

- VOLTAGE CURRENT RATING: VBUS AND GND CONTACTS RATED AT 1.25A, PARALLELED FOR A TOTAL OF 5A;
- INSULATION RESISTANCE: 100MΩ MIN;
- CONTACT RESISTANCE: 40mΩ MAX;
- WITHSTANDING VOLTAGE: 100V AC; FOR 1 MIN.
- OPERATING TEMPERATURE: -40°C TO +80°C.

2.Mechanical:

- Mating Force: 5N~20N MAX
- Unmating Force: 8N~20N(INITIAL), 6N~20N(AFTER 10000 CYCLES) MIN.

3.DIMENSIONS MARKED "▼" TO BE CHECKED BY Q.C & IPQC.

4.PART NO.

UWCF-242N-4BVUA738

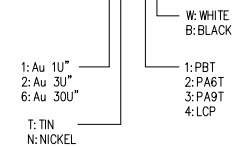

NO	PARTS	MATERIAL	QTY	FINISHING
7	RING	SILICON	1	BLUE
6	MID PLATE	STAINLESS STEEL	1	
5	GND PLATE	STAINLESS STEEL	1	PLATED NICKEL/TIN
4	SHELL	STAINLESS STEEL	1	PLATED NICKEL
3	INNER SHELL	STAINLESS STEEL	1	PLATED NICKEL
2	CONTACT	COPPER ALLOY	24	PLATED GOLD /TIN
1	HOUSING	LCP+30%GF	1	UL94V-0

TOLERANCES	ANGLES	UNITS
.X ±0.15	X.' ±1'	mm
.XX ±0.10		MAT'L
.XXX ±0.05		SEE NOTE
		FINISH
		SEE NOTE
		Q'TY

THESE DRAWINGS AND SPECIFICATIONS ARE THE PROPERTY OF ACCURATE INNOTECH INC AND SHALL NOT BE REPRODUCED, COPIED OR USED IN ANY MANNER WITHOUT THE PRIOR WRITTEN CONSENT OF ACCURATE INNOTECH INC

雅安科技有限公司 ACCURATE INNOTECH INC.			
TITLE: USB 3.1 CF WATERPROOF 沉板1.06mm DIP TYPE		PART NO.: UWCF-24XN-4BVUA738	
DR: <i>Ricky</i> 2020/03/18		DWG NO.: AII-VUA738	
CHKD: <i>Ricky</i> 2020/03/18		SCALE	SHEET
APPD:		4:1	1/1
		REV.	CUSTOMER
		B	DRAWING